



CASEMENT 34
WINDOW (34mm)

General Documentation Disclaimer

This manual is intended as a manufacturing and installation advisory document. For correct specifications, sizing of profiles and structural information please consult the StarFront Application. If the information you require is not available through the StarFront Application, please contact your stockist before proceeding. It is advisable to have all sizing and performance criteria checked by a qualified structural engineer to ensure that the required criteria will be met.

All information, recommendations or advice contained in this documentation is given in good faith to the best of Wispeco's knowledge and is based on current procedures in effect.

Since the actual use of this documentation by the user is beyond the control of Wispeco, such use is within the exclusive responsibility of the user. Wispeco cannot be held responsible for any loss incurred through incorrect or faulty use of this documentation. Training of Wispeco systems is important for ensuring correct procedures in the manufacturing of products.

Great care has been taken to ensure that the information provided is correct.

Ensure that you have the latest available manual. The revision number and date can be checked on the latest StarFront version.

Wispeco will accept no responsibility for any errors and/or omissions, which may have inadvertently occurred.

Specifications concerning products and applications

This manual is based on standard configurations only. As there are many configurations not covered in this manual, contact your stockist with regards to a configuration not represented herein if required.

AutoDesk drawings (CAD Symbol Library) are available on request and can be issued with the consent of the Wispeco Technical Department.

All mechanical joints must be sealed with a **Crealco approved joint sealer**. Failure to correctly seal the joints can affect the performance of the system. Information on joint sealing can be found in the Cleaning & Maintenance Manual available for download from the Wispeco website or from StarFront.

All drawings in the Wispeco Documentation are NOT to scale and are used for illustrative purposes only.

Wispeco will not accept responsibility for the use of standard products since Wispeco does not know where these products are being installed.

The hardware recommended in this documentation is suitable for use in most atmospheric environments. When hardware is used in severe coastal environments the manufacturer of the hardware must be consulted.

The use of non-specified hardware or incorrect mechanical fasteners can adversely affect the mechanical and weathering performance of the system and we strongly advise against deviations. A Wispeco Consultant can advise you of any hardware issues and limitations with regard to this system.

The use of anti-magnetic stainless steel screws and aluminium pop rivets is recommended to reduce galvanic corrosion in harsh environments.

Fixing lugs on frames must be positioned as per the user manual and used in accordance to the AAMSA specifications. When profiles are screwed together the screw centres must also be according to the user manual or as specified by an engineer.

All glass used within Wispeco products must comply with SAGGA regulations. Laminated glass must not stand in water.

By continuing to use this documentation you acknowledge that you understand and accept the legal disclaimer.

This manual must be read in conjunction with the Installation, Cleaning & Maintenance Document and the Performance Certificates for the relevant system. The manual must also be used in conjunction with the design and cutting list from the latest version of StarFront.

Index	ii
Legal Disclaimer.....	1

General System

Profile Identification.....	3
Hardware Components	4
Maintenance of the Friction Stay.....	5
Butterfly Gasket & Wedge Codes	6
Sash Limitation Guides	7
Typical Configurations	
Standard Top Hung Window	8
Standard Side Hung Window	9
Cottage Pane Fixed Panel.....	10
Cottage Pane Top Hung & Side Hung	11
Fastening Positions.....	12
Typical Cross Sectional Details.....	
Double Top Hung Over Fixed.....	13
Side Hung Over Fixed.....	14
Cottage Pane 2x2 Top Hung Over 2x1 Fixed Panel.....	15
Outer Frame Construction	16
Sash Frame Construction	17
Outer Frame Machining Details	
Equal Leg	18
Short Leg.....	19
Sill Level & Machining Detail	
Sidelight Frame 72mm	20
Sidelight Box Sill 72mm	21
Mullion Machining Details	
Standard Machining Detail for End Milling on Equal Leg Outer Frame	22
Standard Machining Detail for End Milling on Short Leg Outer Frame	23
Standard Machining Detail for End Milling on Sidelight Frame 72mm	24
Standard Machining Detail for End Milling on Sidelight Box Sill 72mm	25
Cottage Pane Mullion Machining Details	
Standard Machining Detail for End Milling on Equal Leg Outer Frame	26
Standard Machining Detail for End Milling on Short Leg Outer Frame	27
Standard Machining Detail for End Milling on Sidelight Frame 72mm	28
Standard Machining Detail for End Milling on Sidelight Box Sill 72mm	29
Transom with W/Bar Machining Details	
for End Milling on 70mm Outer Frame	30
Corner Cleat Assembly Detail	
for Tubular Sash	31
Mullion Packer Frame Joint Assembly Detail.....	32

This manual must be read in conjunction with the Installation, Cleaning & Maintenance Document and the Performance Certificates for the relevant system. The manual must also be used in conjunction with the design and cutting list from the latest version of StarFront.

CASEMENT 34
WINDOW (34mm)

Cross Joint Assembly Detail.....	
Standard Mullion	33
Cottage Pane Mullion	34
Friction Stay Assembly Detail	35
Handle Assembly Detail	36
Fixing Lug Preparation Detail	37
Bead Cut-Out for Setting Block.....	38
Glazing Procedure	39-40



This manual must be read in conjunction with the Installation, Cleaning & Maintenance Document and the Performance Certificates for the relevant system. The manual must also be used in conjunction with the design and cutting list from the latest version of StarFront.

CASEMENT 34

WINDOW (34mm)

PRODUCT MANUAL

Profile Identification

Casement 34 Window Profiles

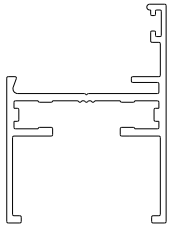

DIE No. W32039 Equal Leg Outer Frame

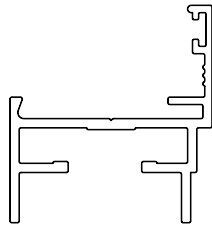

DIE No. W33134 Cas34 Frame 34mm Short Leg

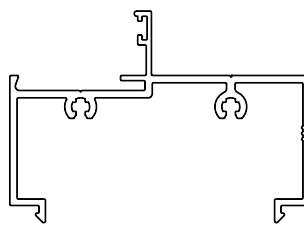

DIE No. W33135 Cas34 Frame 70mm

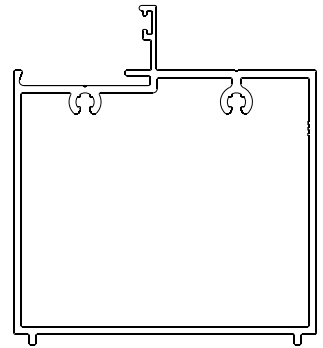

DIE No. W56272 Cas34 Frame 70mm Boxed Sill

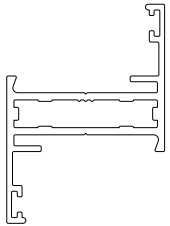

DIE No. W55691 Tubular Sash

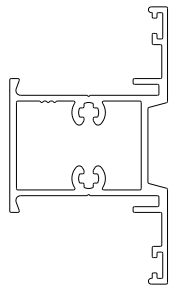

DIE No. W55692 Cas34 Mullion

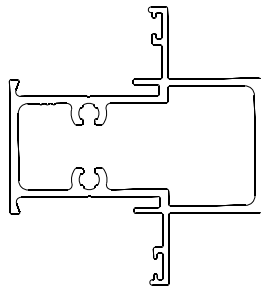

DIE No. W56269 Cas34 Mullion 54mm

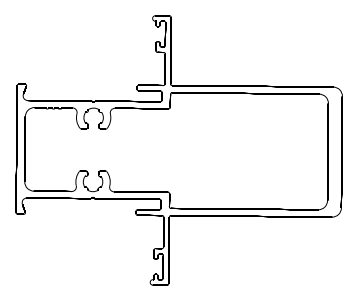

DIE No. W56270 Cas34 70mm Mullion

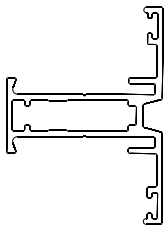

DIE No. W56271 Cas34 Mullion 34mm C/Pane



DIE No. W10627 Fixing Lug

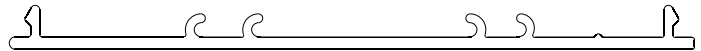

DIE No. W30607 Fixing Lug



DIE No. W10083 Cas34 Add On Weather Bar



DIE No. W22813 Flat Bar



DIE No. W33136 Double Glazing Bead

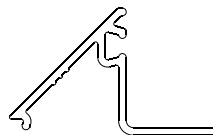

DIE No. W33137 Cas34 Bead Multi 13mm

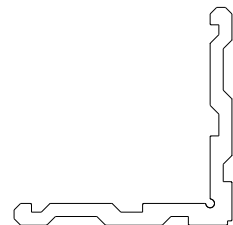

DIE No. CL10241P Cas34 Corner Cleat

CASEMENT 34 WINDOW (34mm)

PRODUCT MANUAL

Hardware Components

RECOMMENDED CASEMENT 34 COMPONENTS

All hardware is available through our Stockists as well as through Crealco Components, and can be viewed on www.crealco-components.com

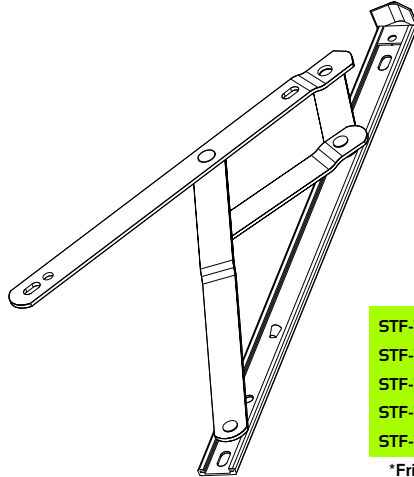
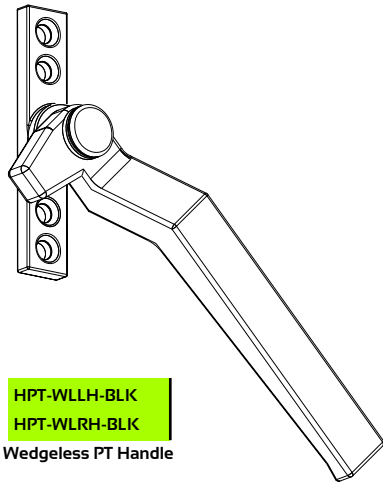

FASTENERS

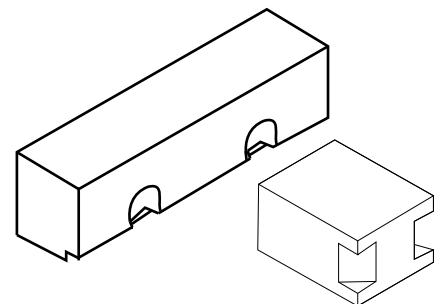
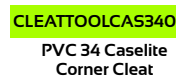
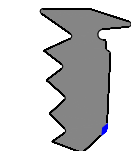
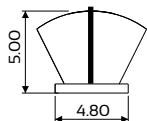
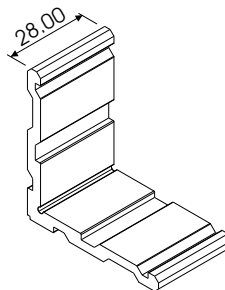
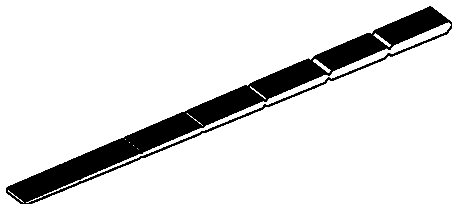
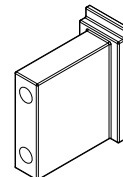
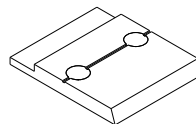
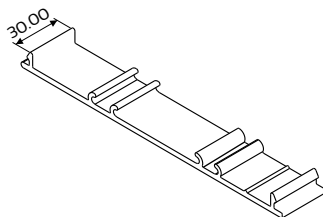
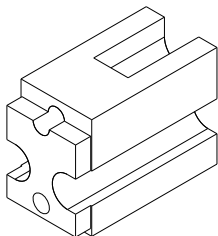
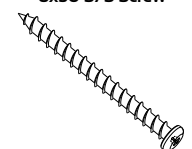
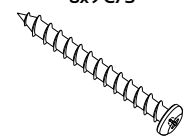
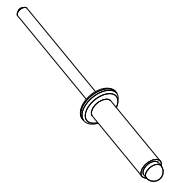
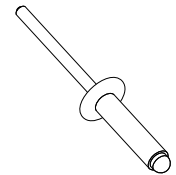

CASEMENT 34

WINDOW (34mm)

PRODUCT MANUAL

Maintenance of the Friction Stay

With a minimal amount of care and maintenance your CREALCO CASEMENT windows will stay looking good and performing superbly for many years to come - a valuable, long lasting asset giving continued satisfaction and pride.

Basics of a Friction Stay

A friction stay is a type of hinge that controls the opening of the window so that it will stay open at the width you decide to open it to, not closing under its own weight or being too difficult to open and close.

Friction Stay Maintenance

As the name implies, a friction stay needs a level of friction to operate correctly. Too much friction and the friction stay arms can be bent in operation and the window will be stiff and difficult to open. Too little friction and the window will not stay at its required level.

Key to the correct sealing of the casement sash is the top alignment guide which maintains the friction stay in the closed and sealed position. If the shape of the guide is altered or flared it can result in poor sealing of the sash as well as incorrect alignment of the friction stay.

Track Maintenance

Ensure that the track is free from dirt and debris which can alter the friction of the hinge. It is best not to add lubricants as this can alter the friction as well as collect more debris which can cause wear within the track.

Friction Adjustment

The hinge is factory set and may after continue use become loose. Should this occur using a small flat bladed screwdriver turn the screw on the friction hinge clockwise to increase the amount of friction.

The same adjustment should be made to both the hinges on the window. Also should the window be stiff in operation turn the screw anti-clockwise until the desired result is achieved.

Top Alignment Guide

The top alignment guide can flare or distort due to a number of issues. For correct operation it is important to bend the alignment guide back into position.

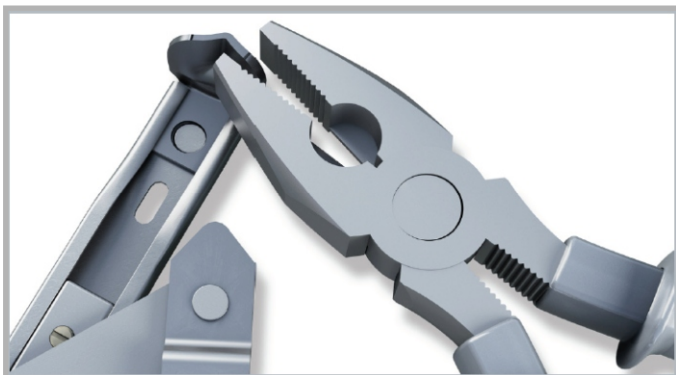
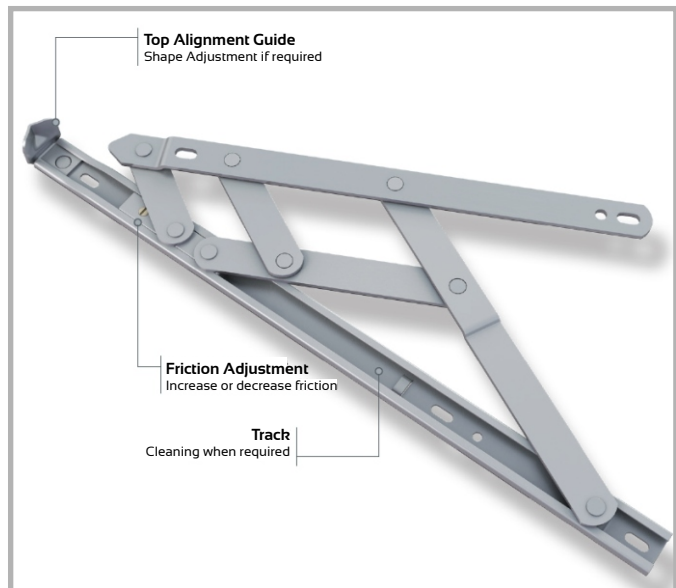

Correct Shape and Seating for Top Alignment Guide

Straighten the Guide with pliers or suitable tool

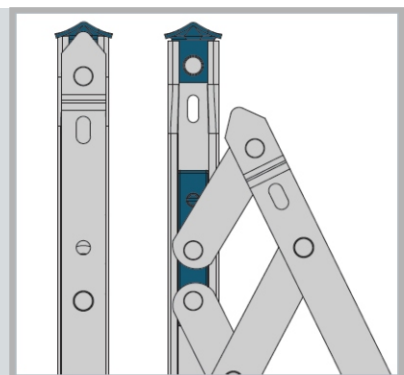

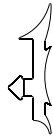

BUTTERFLY GASKET



GBF-ORG

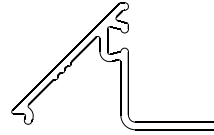

W33137 BEAD

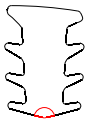

Wedge Gasket



GWG-O3R



Wedge Gasket



GWG-O2B



Wedge Gasket



GWG-O1G



GWG-O4Y

WEDGES

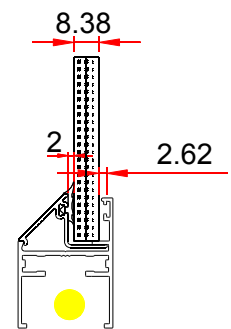
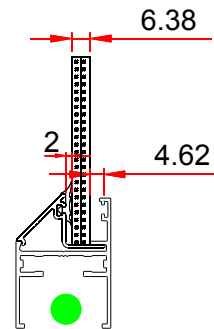
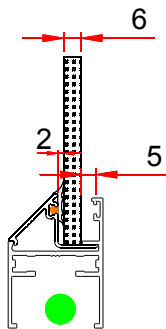
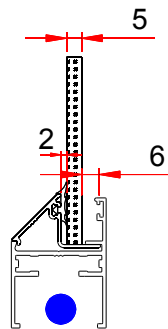
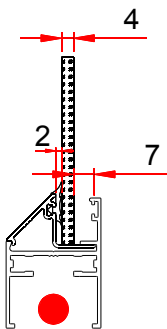

CASEMENT 34 WITH W33137 BEAD

The sash limitations of the system are strictly calculated in accordance to AAMSA guidelines and take into account the aluminium specifications as well as the glass used. Please ensure that these are adhered to as any product produced outside of these limitations will not adhere to AAMSA regulations.

		Maximum Vent Width in mm	Maximum Vent Height in mm
Top Hung	W55691	1200	900

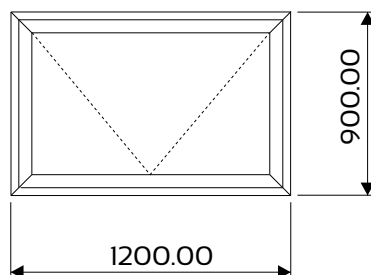

		Maximum Vent Width in mm	Maximum Vent Height in mm
Side Hung	W55691	700	1500

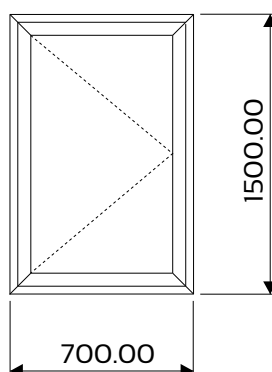

Typical Configurations

Standard Top Hung Window

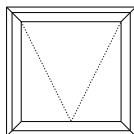

A
SINGLE TOP HUNG

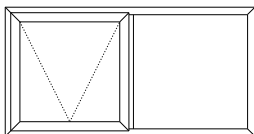

BB
TOP HUNG
NEXT TO FIXED

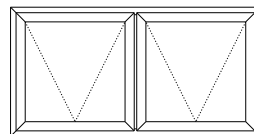

CC
TOP HUNG NEXT
TO TOP HUNG

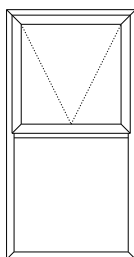

B
TOP HUNG
OVER FIXED

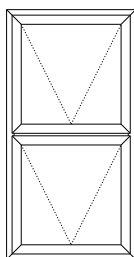

C
TOP HUNG
OVER TOP HUNG

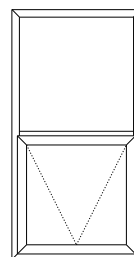

E
FIXED OVER
TOP HUNG

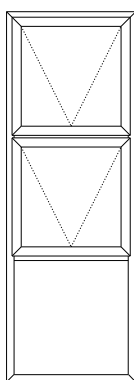

D
DOUBLE TOP HUNG
OVER FIXED

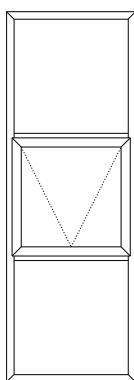

DD
FIXED OVER
TOP HUNG
OVER FIXED

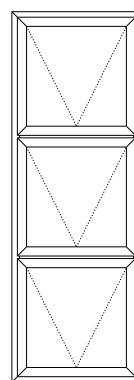

EE
TRIPLE TOP HUNG

Typical Configurations

Standard Side Hung Window

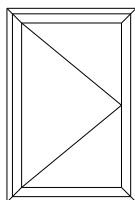

A

SINGLE SIDE HUNG

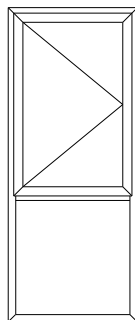

B

SIDE HUNG
OVER FIXED

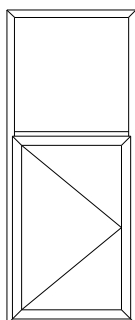

C

FIXED OVER
SIDE HUNG

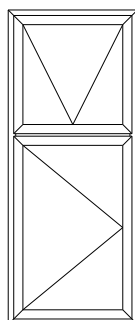

D

TOP HUNG
OVER SIDE HUNG

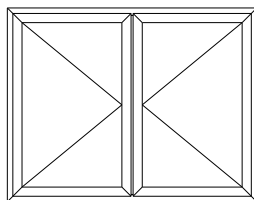

CC

SIDE HUNG NEXT
TO SIDE HUNG

Typical Configurations

Cottage Pane Fixed Panel Window

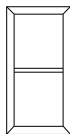

A

1 x 2 FIXED PANEL

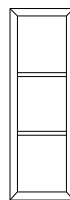

B

1 x 3 FIXED PANEL

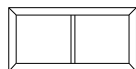

C

2 x 1 FIXED PANEL

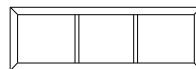

D

3 x 1 FIXED PANEL

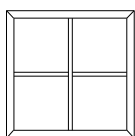

E

2 x 2 FIXED PANEL

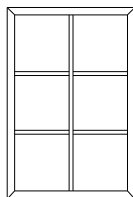

F

2 x 3 FIXED PANEL

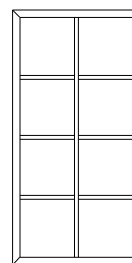

G

2 x 4 FIXED PANEL

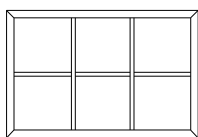

H

3 x 2 FIXED PANEL

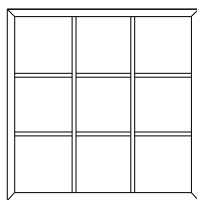

I

3 x 3 FIXED PANEL

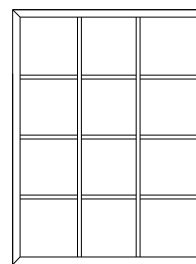

J

3 x 4 FIXED PANEL

TOP HUNG

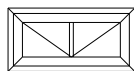

P

2 x 1 PANE
SINGLE TOP HUNG

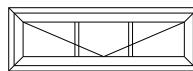

R

3 x 1 PANE
SINGLE TOP HUNG

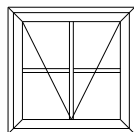

Q

2 x 2 PANE
SINGLE TOP HUNG

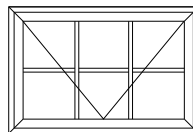

S

3 x 2 PANE
SINGLE TOP HUNG

SIDE HUNG

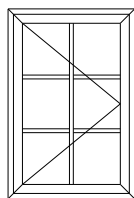

P

2 x 3 PANE
SINGLE SIDE HUNG

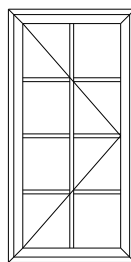

Q

2 x 4 PANE
SINGLE SIDE HUNG

IMPORTANT:

As there are many different methods of fixing the window to the structure, the illustration below is a general fixation detail. The illustration defines the general method and hole fixing. Before installation or machining of the holes, please ensure that you have checked the required fixing method with the appropriated building engineer and that your chosen methods meets their specifications

Failure to fix the window to correct building or engineer specifications will result in the door not meeting the required specifications.

DISCLAIMER: Please note that fixation of the frame to the structure is an element which **MUST** be specified and certified by an appropriate engineer and is not the responsibility of Wispeco.

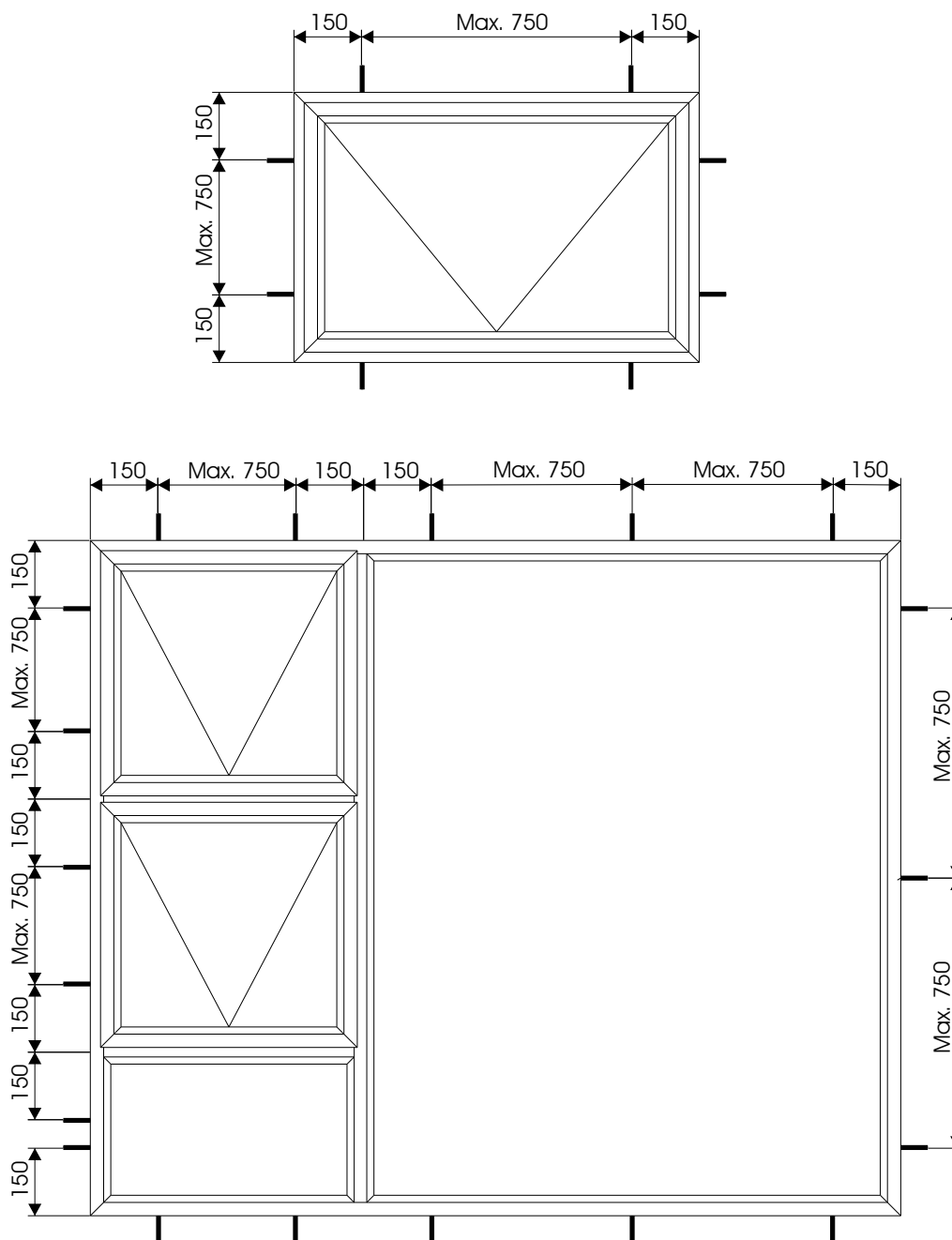

CASEMENT 34

WINDOW (34mm)

PRODUCT MANUAL

Typical Cross-sectional Details

Double Top Hung Over Fixed

SECTION B-B

Section not to scale

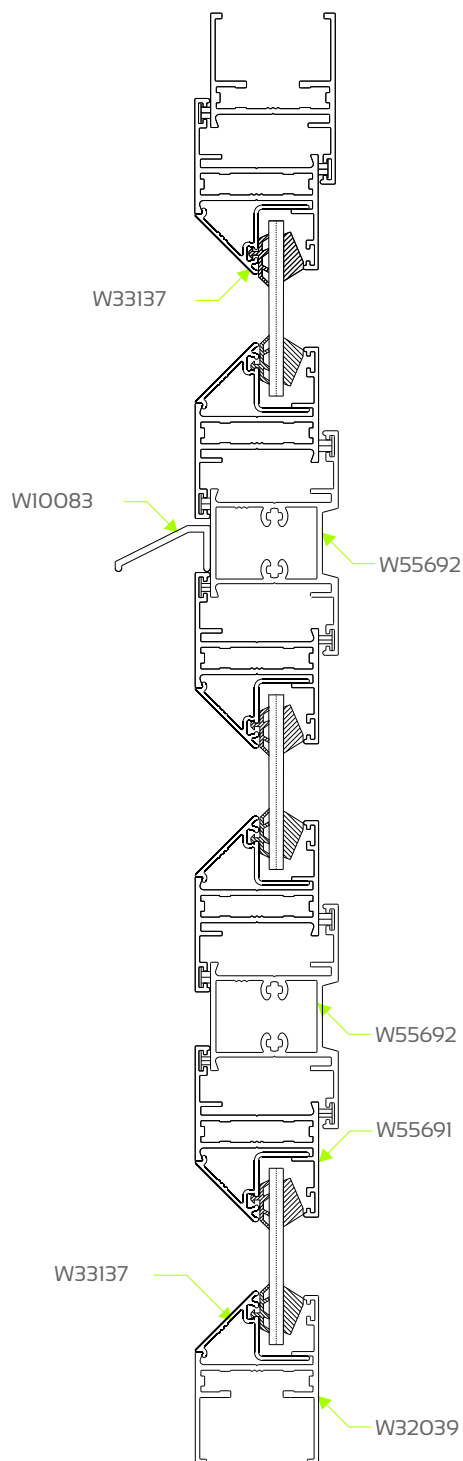

SHOWING TRANSOM WITH
WEATHER BAR OVERLAP

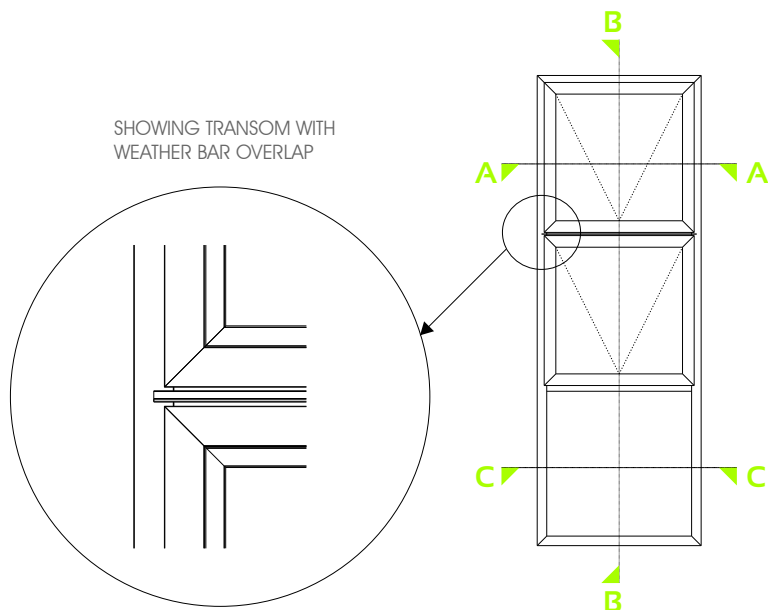

SECTION A - A

Section not to scale

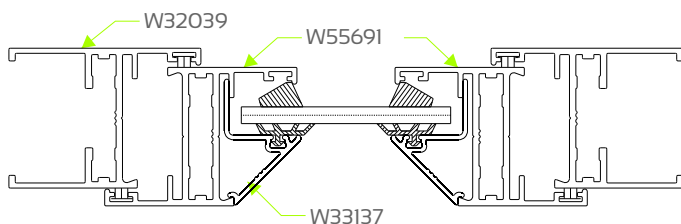

SECTION C-C

Section not to scale

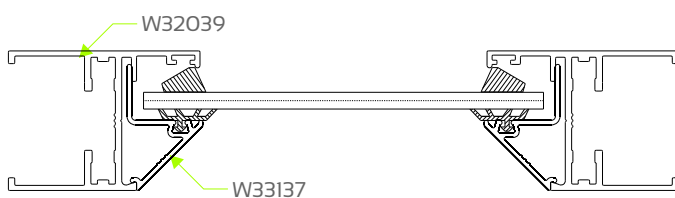

CASEMENT 34

WINDOW (34mm)

PRODUCT MANUAL

Typical Cross-sectional Details

Side Hung Over Fixed

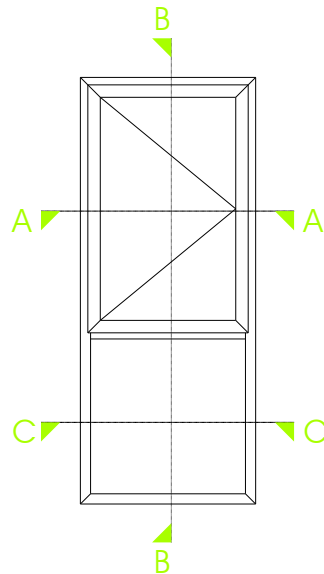

SECTION A - A

Section not to scale

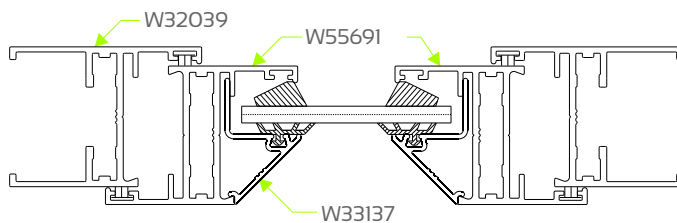

SECTION C-C

Section not to scale



SECTION B-B

Section not to scale

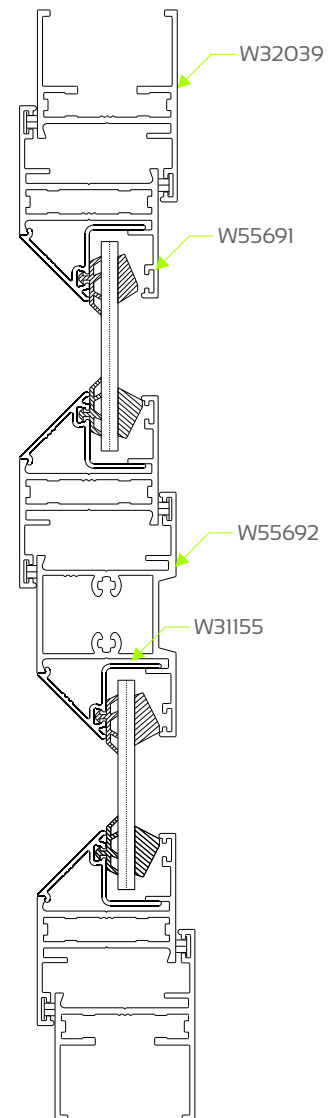

Typical Cross-sectional Details

Cottage Pane 2x2 Top Hung Over 2x1 Fixed Panel

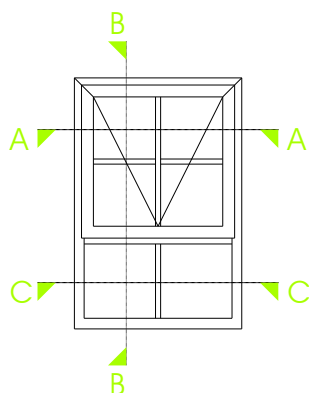

SECTION A - A
Section not to scale

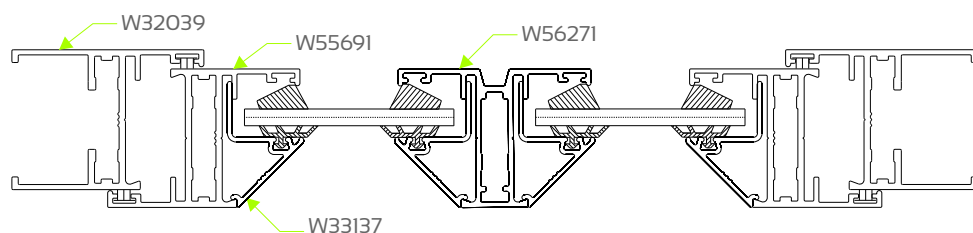

SECTION C - C
Section not to scale

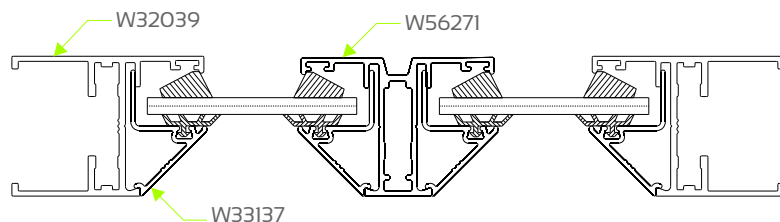

SECTION B - B
Section not to scale

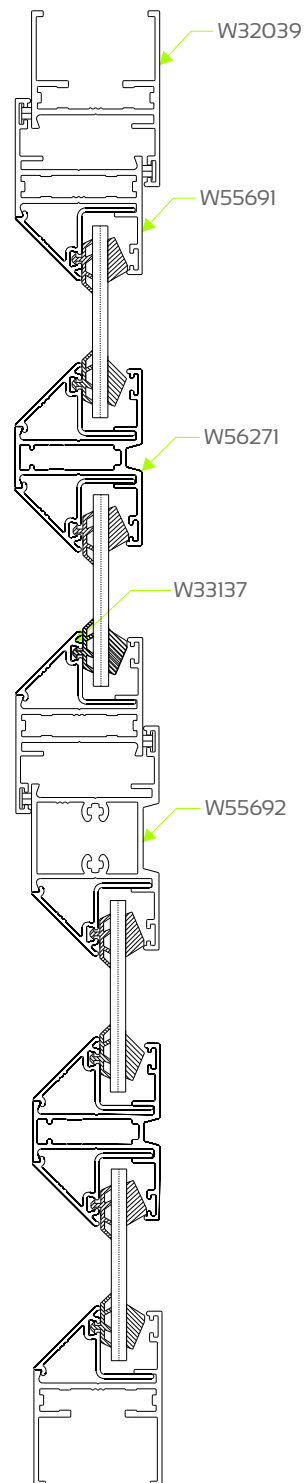

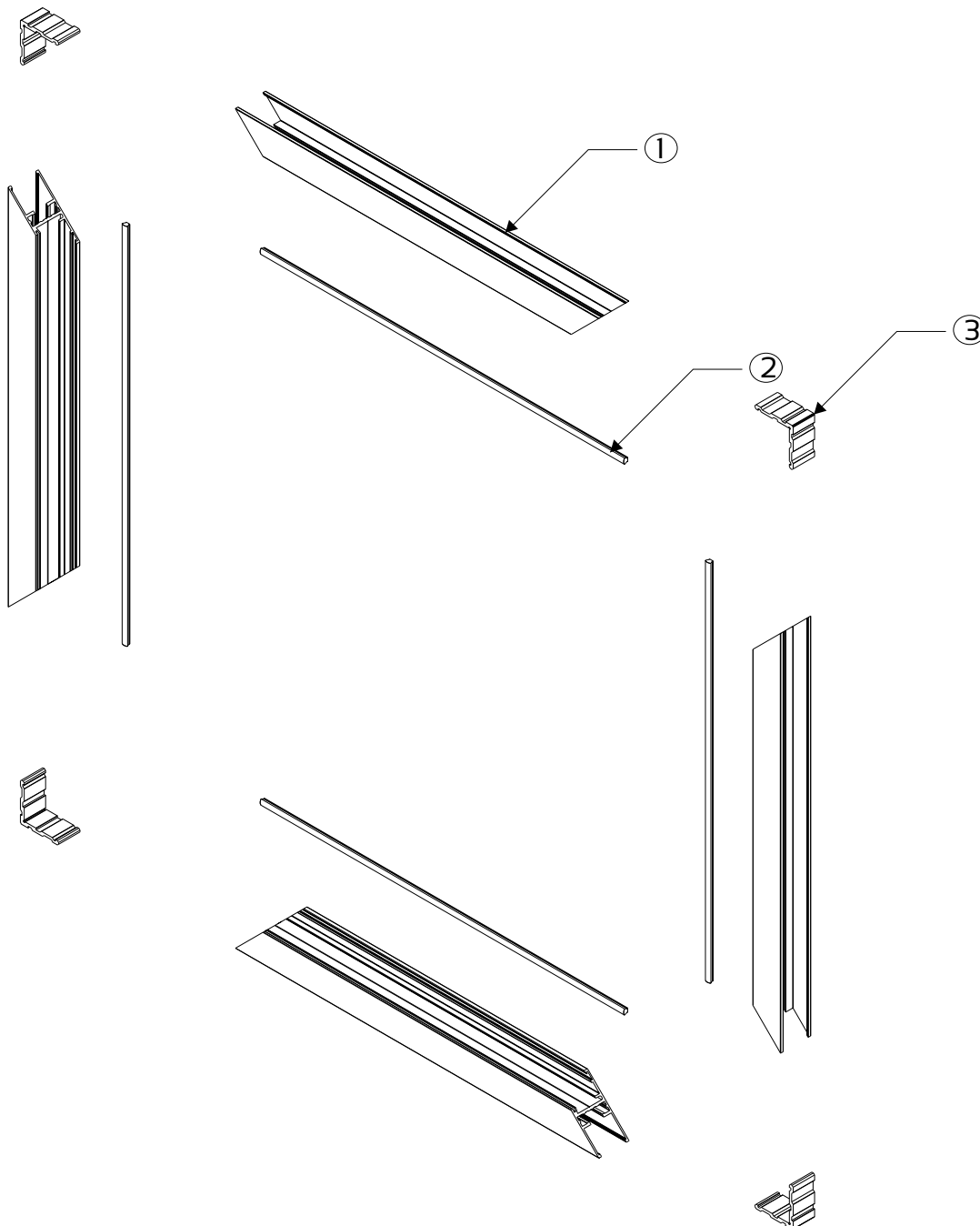

System Profiles

ITEM	QTY	DIE No.	DESCRIPTION
1	4	W32039	Equal Leg Outer Frame

Hardware

ITEM	QTY	COMPONENT	DESCRIPTION
2	4	Finpile	Finpile
3	4	Corner Cleat	34 Corner Cleat

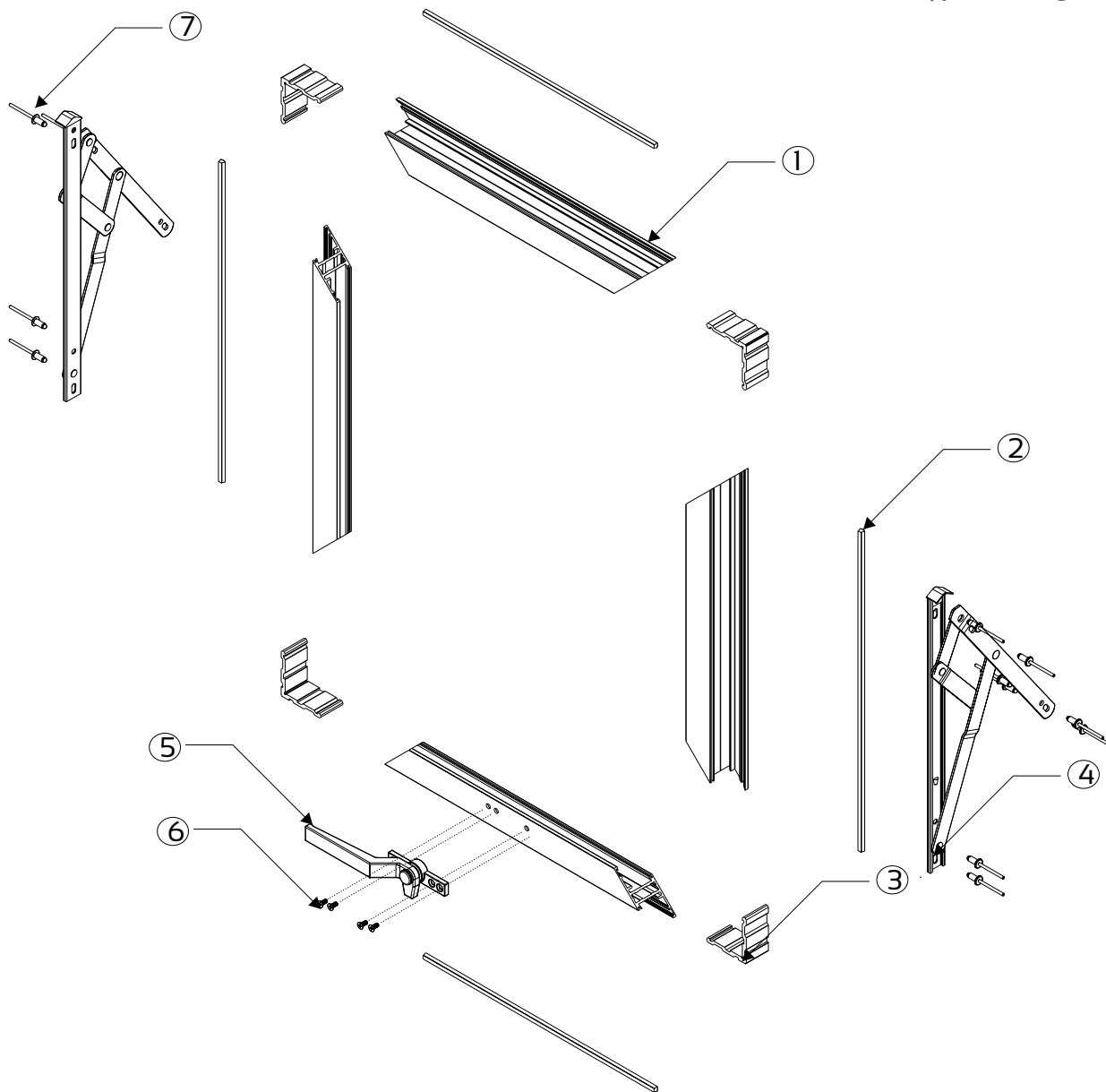

System Profiles

ITEM	QTY	DIE No.	DESCRIPTION
1	4	W55691	Tubular Sash

Hardware

ITEM	QTY	COMPONENT	DESCRIPTION
2	4	Finpile	Finpile
3	4	Corner Cleat	34 Corner Cleat
4	2	Friction Stay	Friction Stay
5	1	Handle	Euroline PT Handle
6	4	Screw	Handle Screw Blunt Point
7	12	Pop Rivet	C/Sunk/Dome Rivet

Outer Frame Machining Details

Equal Leg

Please Note: These details pertain to the machining of profiles. Lengths of profiles and cutting lists need to be confirmed using the StarFront Program to ensure compliance to the SANS Building Regulations.

The 3D drawings are diagrammatical only,
please ensure that the correct die number is used

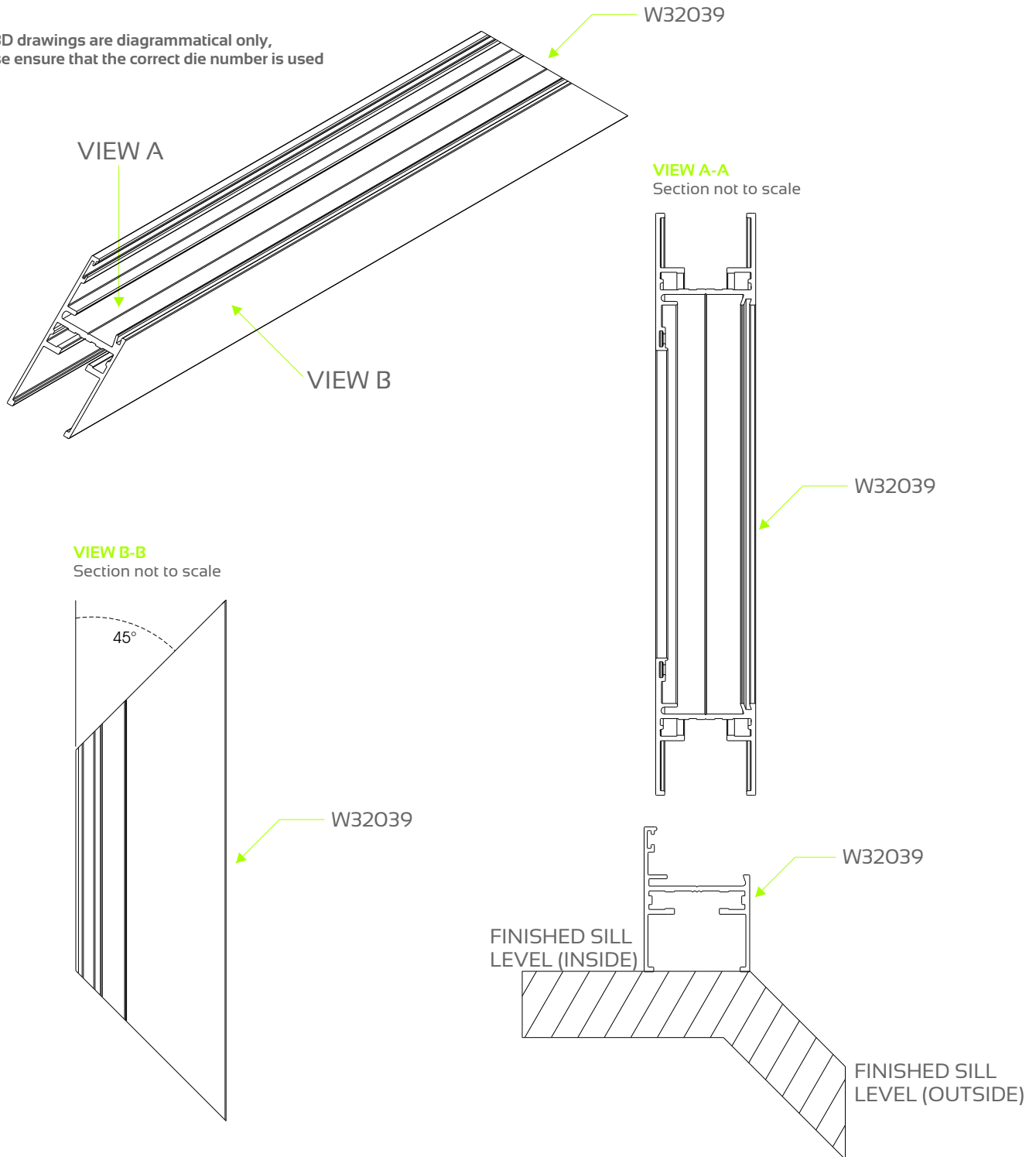

Outer Frame Machining Details

Short Leg

Please Note: These details pertain to the machining of profiles. Lengths of profiles and cutting lists need to be confirmed using the StarFront Program to ensure compliance to the SANS Building Regulations.

The 3D drawings are diagrammatical only,
please ensure that the correct die number is used

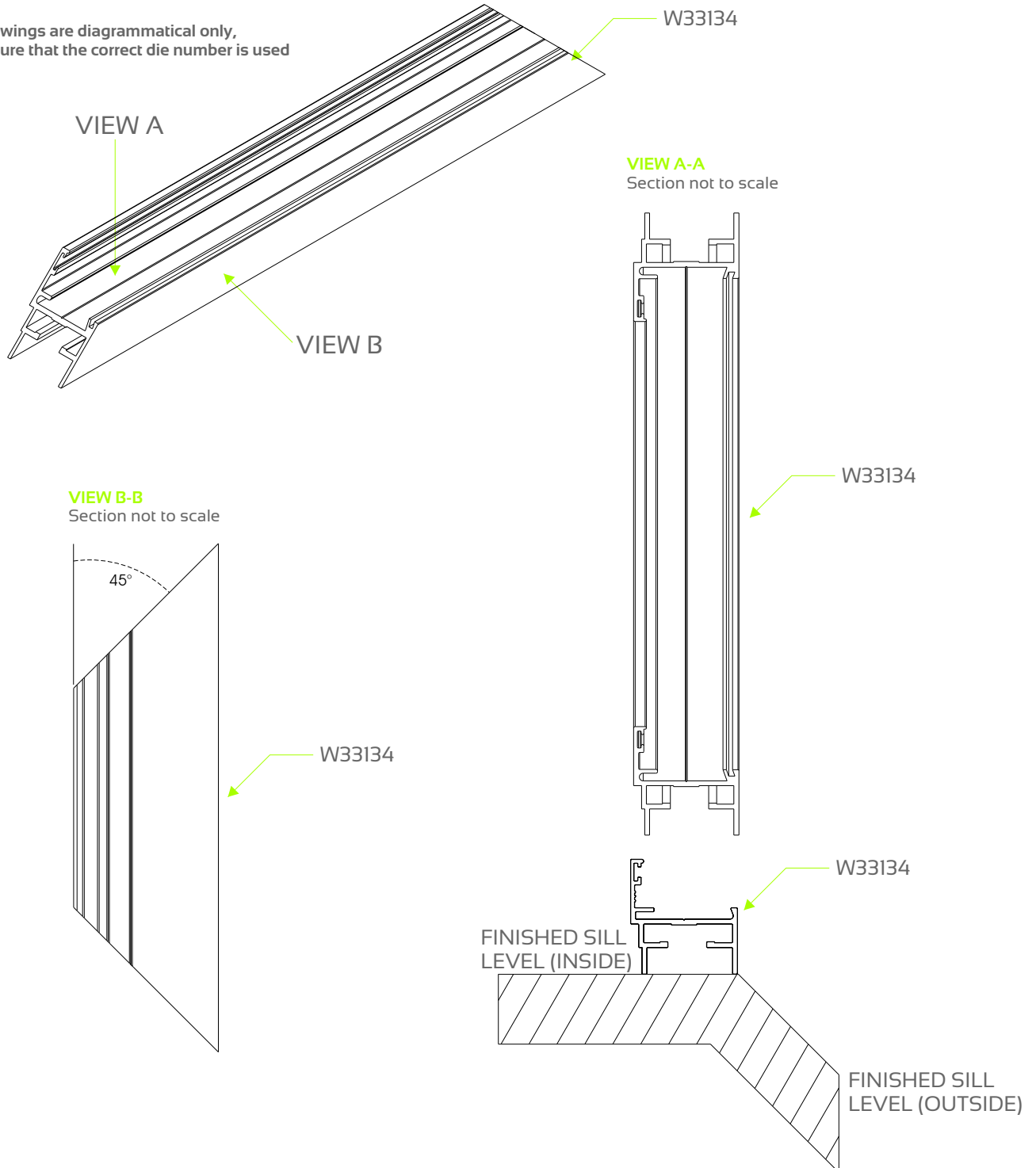

PRODUCT MANUAL

Sidelight Frame 72mm

The 3D drawings are diagrammatical only,
please ensure that the correct die number is used



Disclaimer: The right to make alterations is reserved
© 2013 Wispeco (Pty) Ltd. All Rights Reserved

Sill Level & Machining Detail

Sidelight Box Sill 72mm

Please Note: These details pertain to the machining of profiles. Lengths of profiles and cutting lists need to be confirmed using the StarFront Program to ensure compliance to the SANS Building Regulations.

The 3D drawings are diagrammatical only, please ensure that the correct die number is used

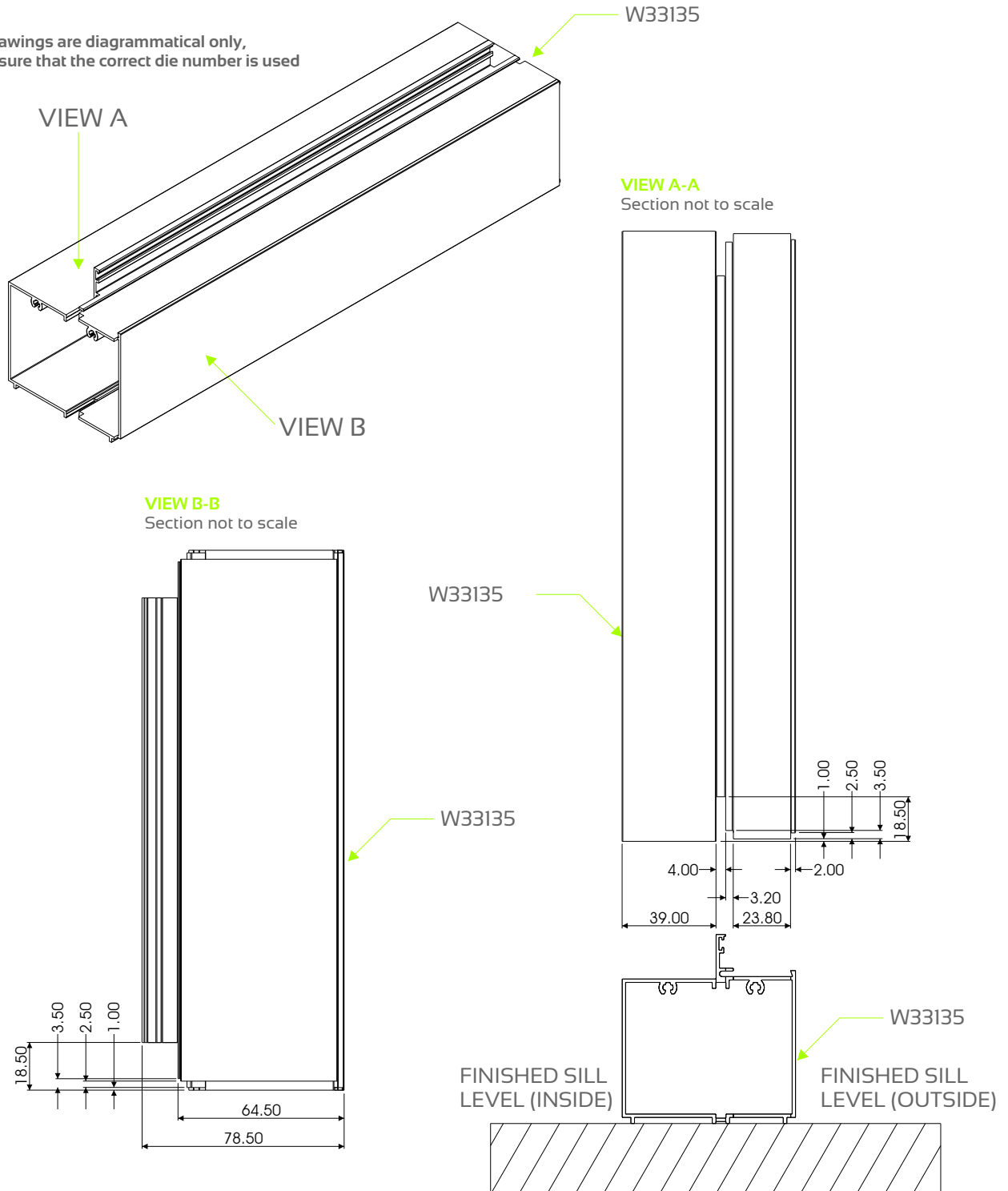

Mullion Machining Details

Standard Machining Detail for End Milling on Equal Leg Outer Frame

Please Note: These details pertain to the machining of profiles. Lengths of profiles and cutting lists need to be confirmed using the StarFront Program to ensure compliance to the SANS Building Regulations.

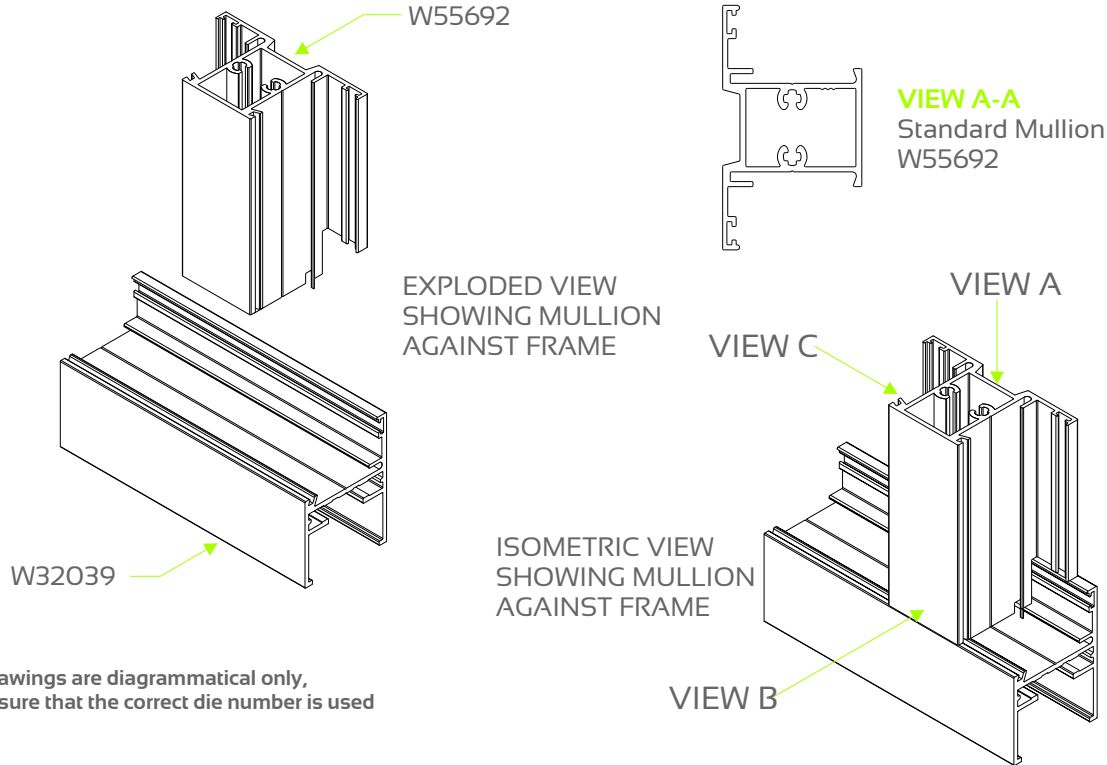

The 3D drawings are diagrammatical only,
please ensure that the correct die number is used

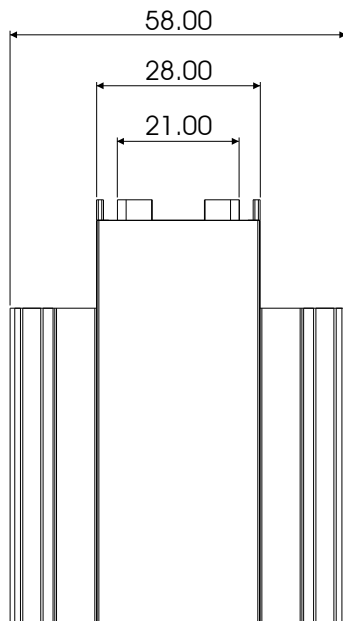

VIEW B-B
Section not to scale

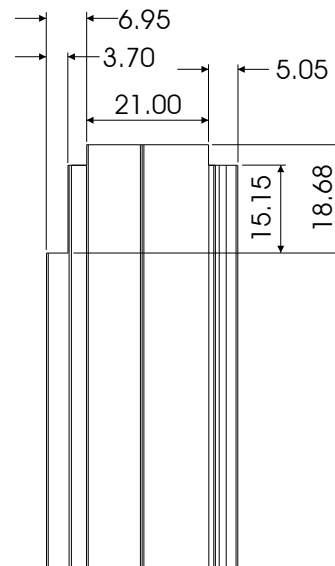

VIEW C-C
Section not to scale

Mullion Machining Details

Standard Machining Detail for End Milling on Short Leg Outer Frame

Please Note: These details pertain to the machining of profiles. Lengths of profiles and cutting lists need to be confirmed using the StarFront Program to ensure compliance to the SANS Building Regulations.

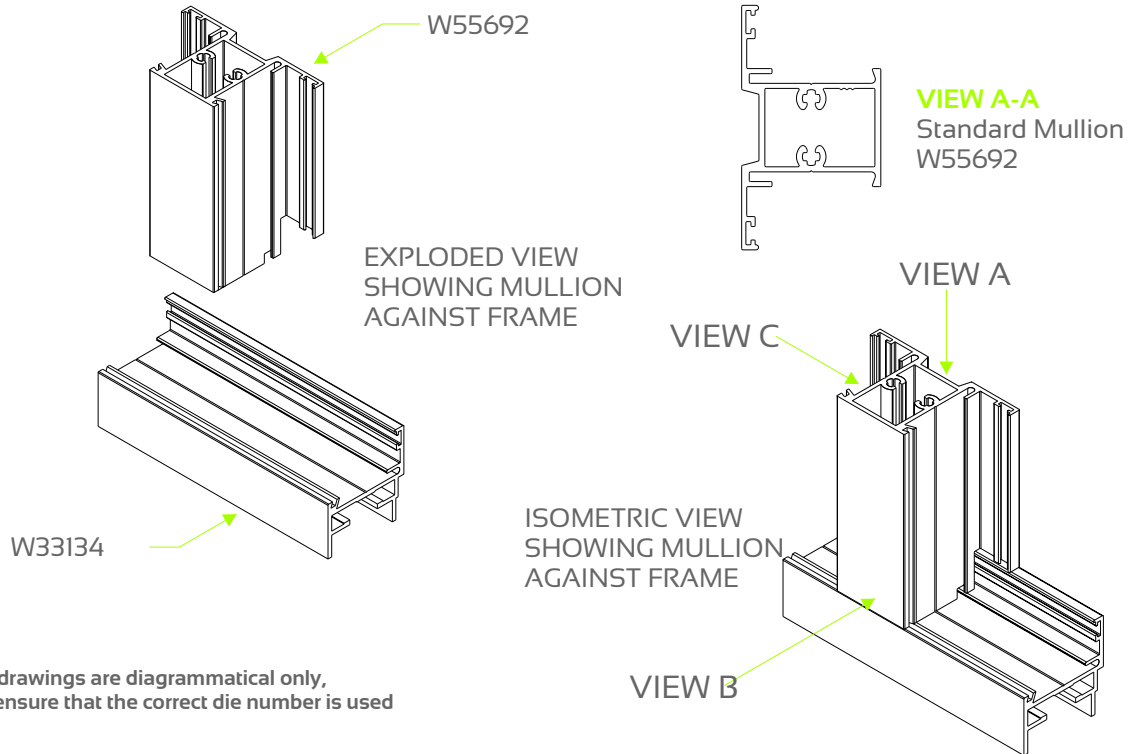

The 3D drawings are diagrammatical only,
please ensure that the correct die number is used

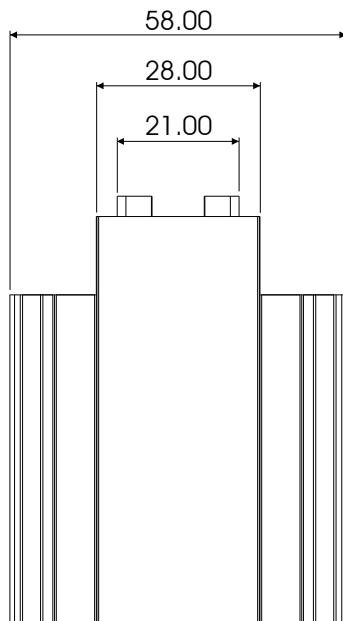

VIEW B-B
Section not to scale

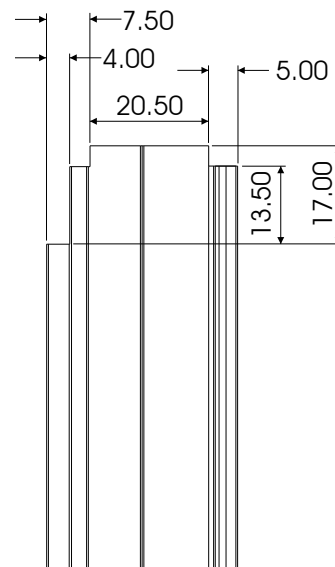

VIEW C-C
Section not to scale

Mullion Machining Details

Standard Machining Detail for End Milling on Sidelight Frame 72mm

Please Note: These details pertain to the machining of profiles. Lengths of profiles and cutting lists need to be confirmed using the StarFront Program to ensure compliance to the SANS Building Regulations.

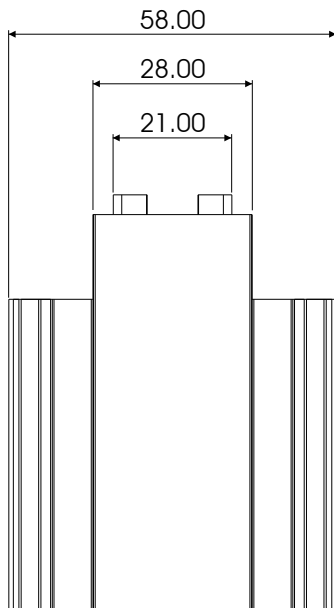
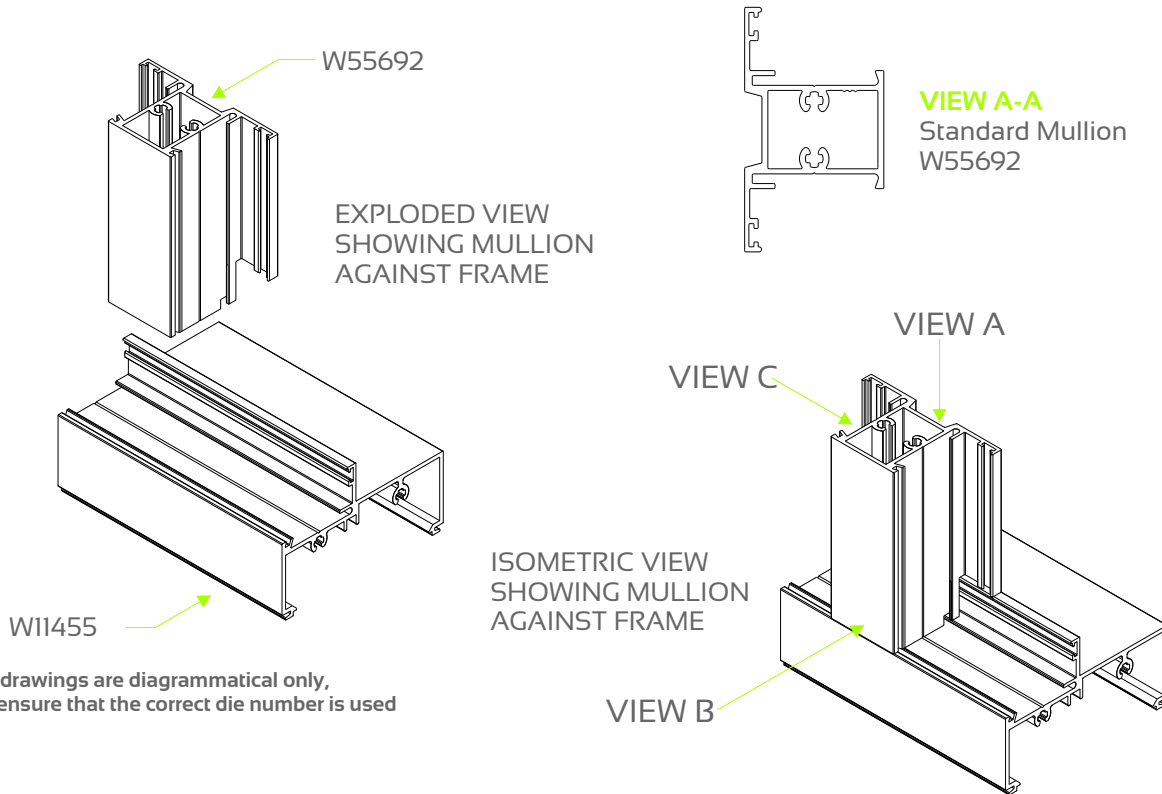

VIEW B-B
Section not to scale

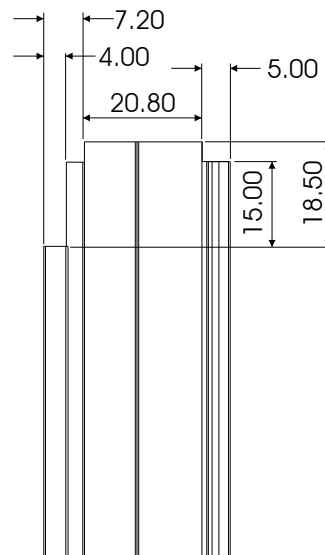

VIEW C-C
Section not to scale

Standard Machining Detail for End Milling on Sidelight Box Sill 72mm

Please Note: These details pertain to the machining of profiles. Lengths of profiles and cutting lists need to be confirmed using the StarFront Program to ensure compliance to the SANS Building Regulations.

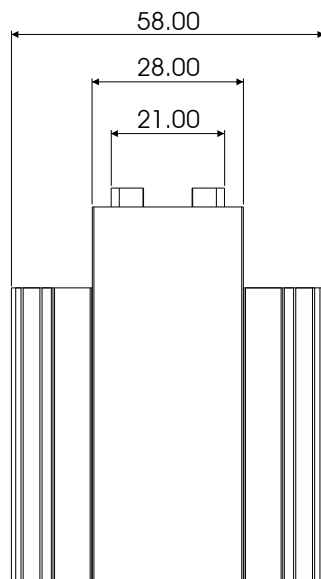
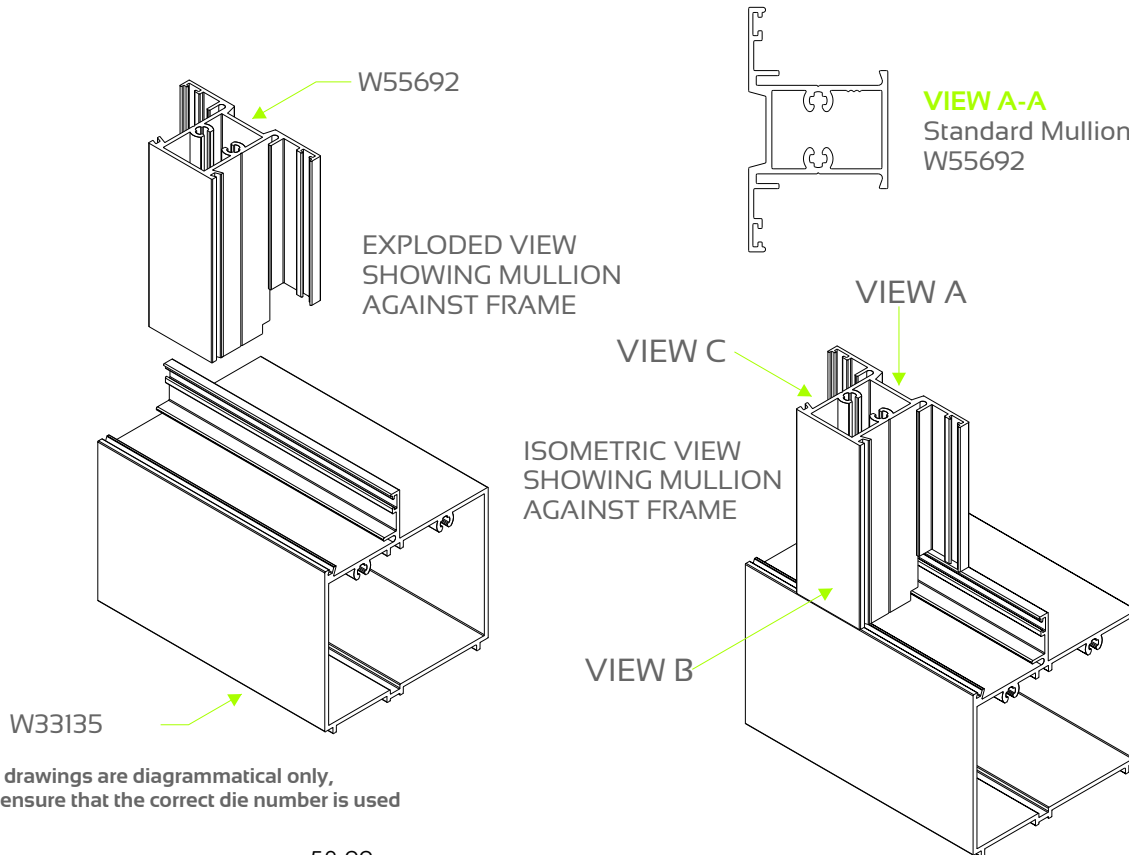

VIEW B-B
Section not to scale

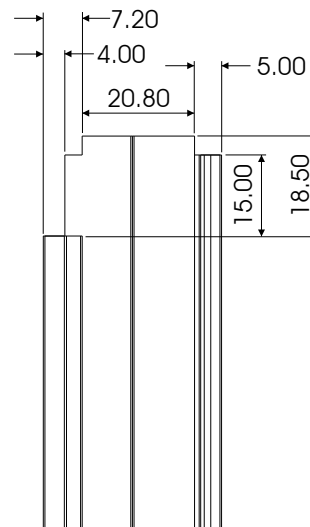

VIEW C-C
Section not to scale

Cottage Pane Mullion Machining Details

Standard Machining Detail for End Milling on Equal Leg Outer Frame

Please Note: These details pertain to the machining of profiles. Lengths of profiles and cutting lists need to be confirmed using the StarFront Program to ensure compliance to the SANS Building Regulations.

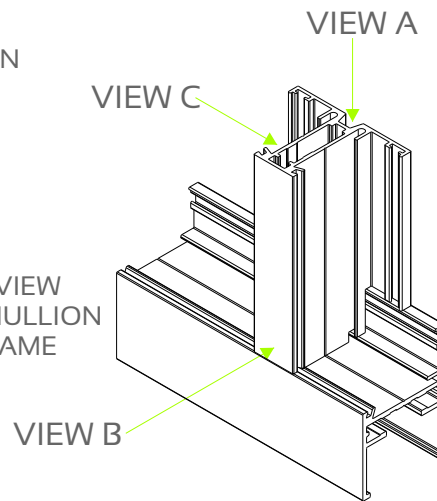
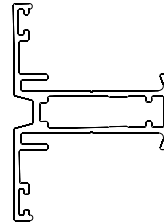
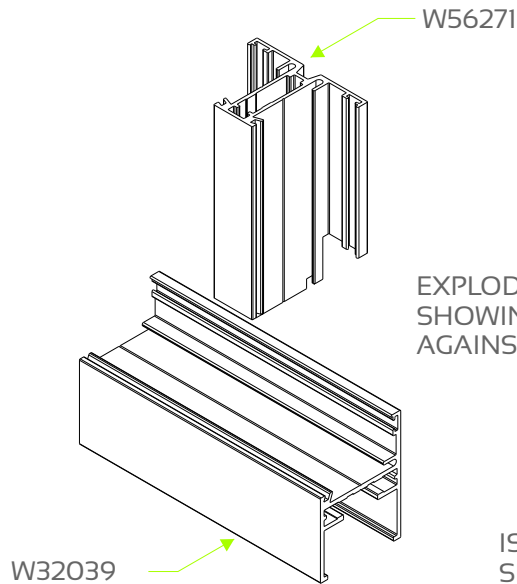

The 3D drawings are diagrammatical only,
please ensure that the correct die number is used

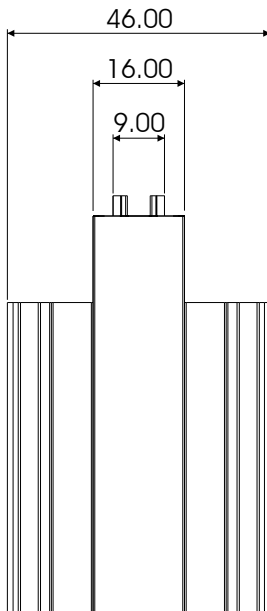

VIEW B-B
Section not to scale

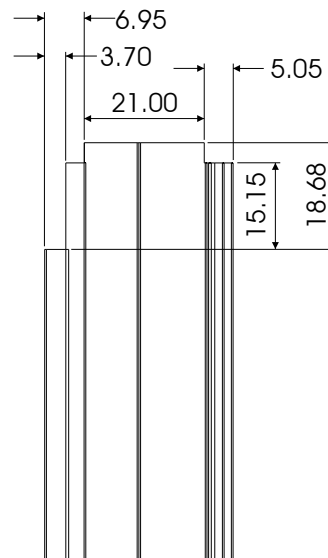

VIEW C-C
Section not to scale

Cottage Pane Mullion Machining Details

Standard Machining Detail for End Milling on Short Leg Outer Frame

Please Note: These details pertain to the machining of profiles. Lengths of profiles and cutting lists need to be confirmed using the StarFront Program to ensure compliance to the SANS Building Regulations.

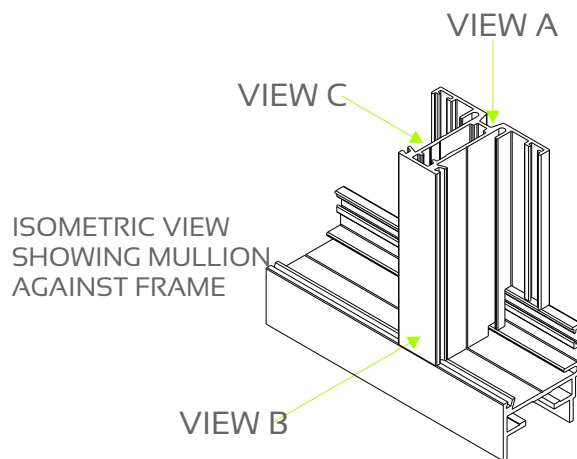
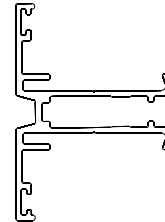
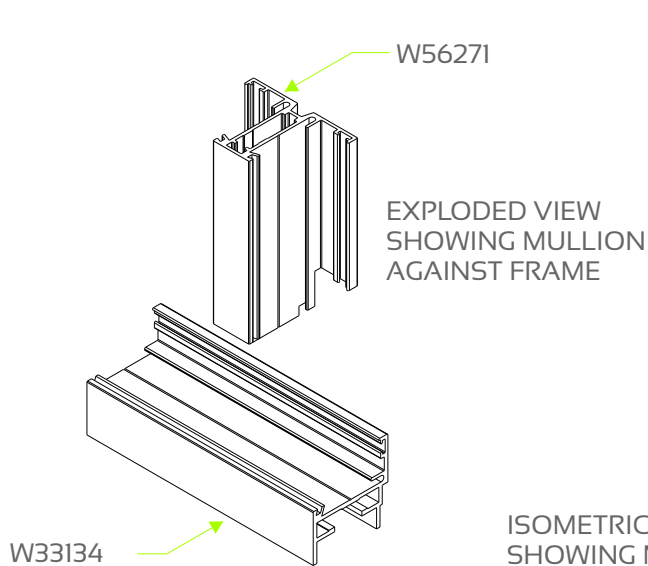

The 3D drawings are diagrammatical only,
please ensure that the correct die number is used

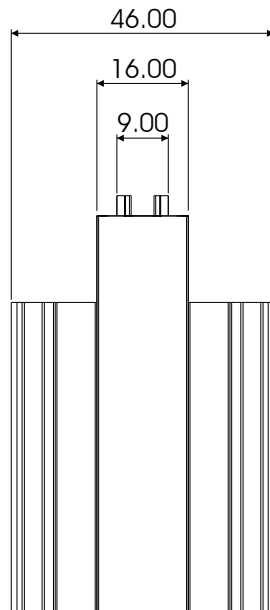

VIEW B-B
Section not to scale

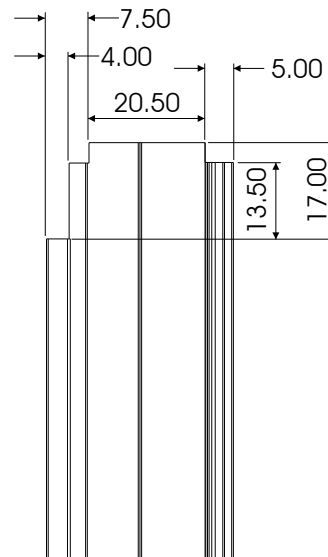

VIEW C-C
Section not to scale

Cottage Pane Mullion Machining Details

Standard Machining Detail for End Milling on Sidelight Frame 72mm

Please Note: These details pertain to the machining of profiles. Lengths of profiles and cutting lists need to be confirmed using the StarFront Program to ensure compliance to the SANS Building Regulations.

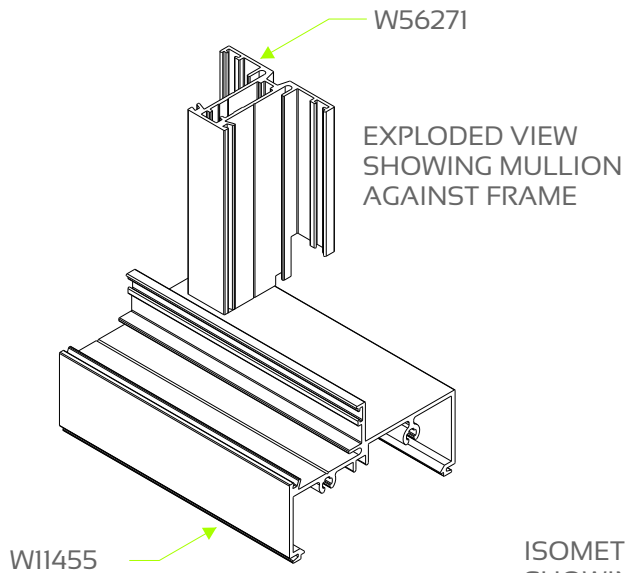

The 3D drawings are diagrammatical only,
please ensure that the correct die number is used

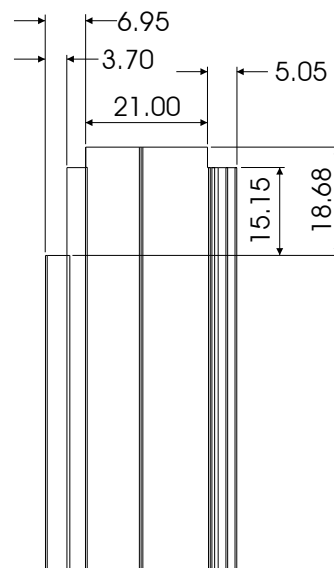
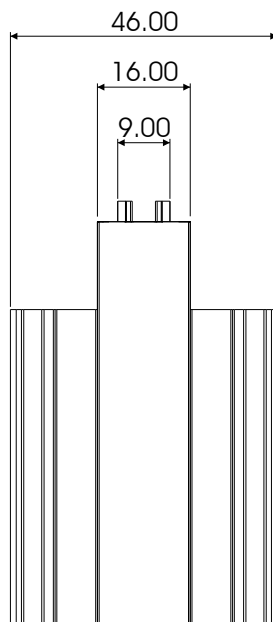
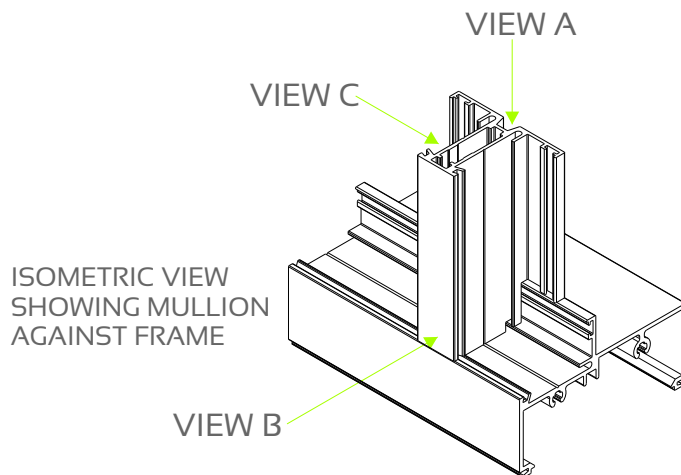
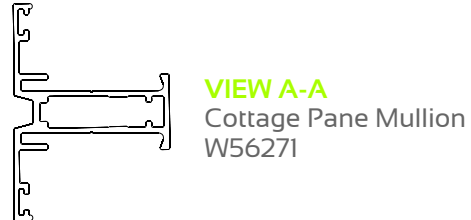

Cottage Pane Mullion Machining Details

Standard Machining Detail for End Milling on Sidelight Box Sill 72mm

Please Note: These details pertain to the machining of profiles. Lengths of profiles and cutting lists need to be confirmed using the StarFront Program to ensure compliance to the SANS Building Regulations.

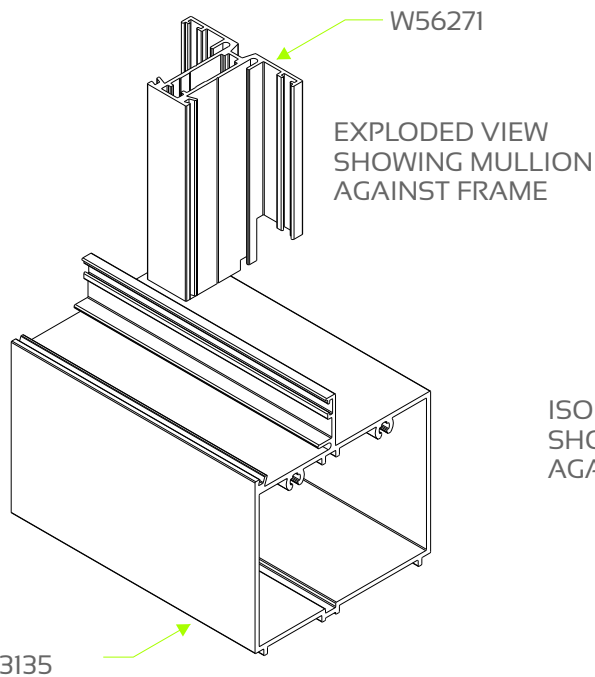

The 3D drawings are diagrammatical only,
please ensure that the correct die number is used

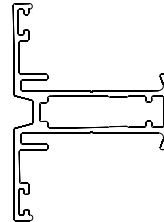

VIEW A-A
Cottage Pane Mullion
W56271

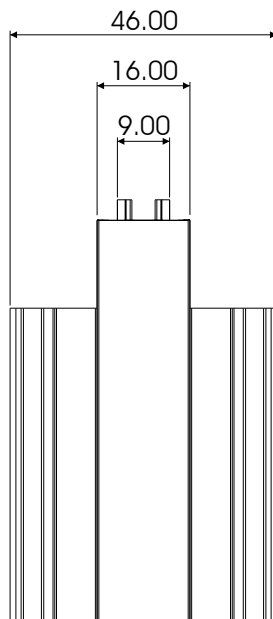
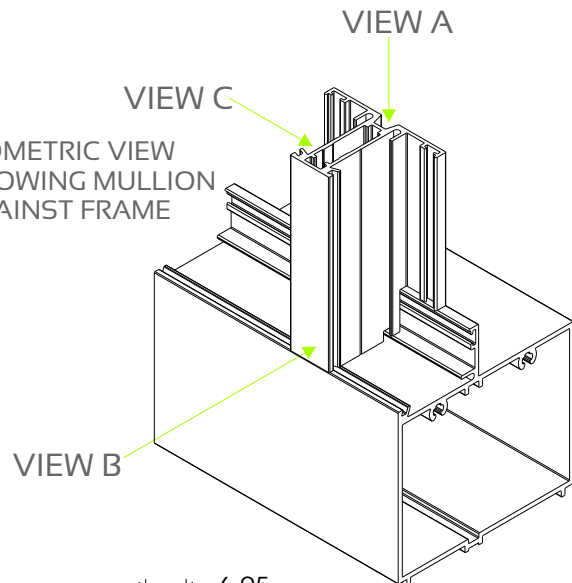

VIEW B-B
Section not to scale

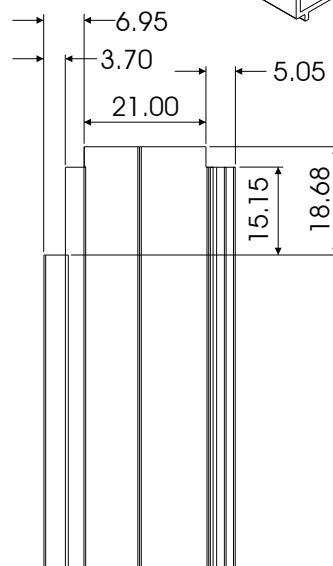

VIEW C-C
Section not to scale

Transom with W/Bar Machining Detail

for End Milling on 70mm Outer Frame

Please Note: These details pertain to the machining of profiles. Lengths of profiles and cutting lists need to be confirmed using the StarFront Program to ensure compliance to the SANS Building Regulations.

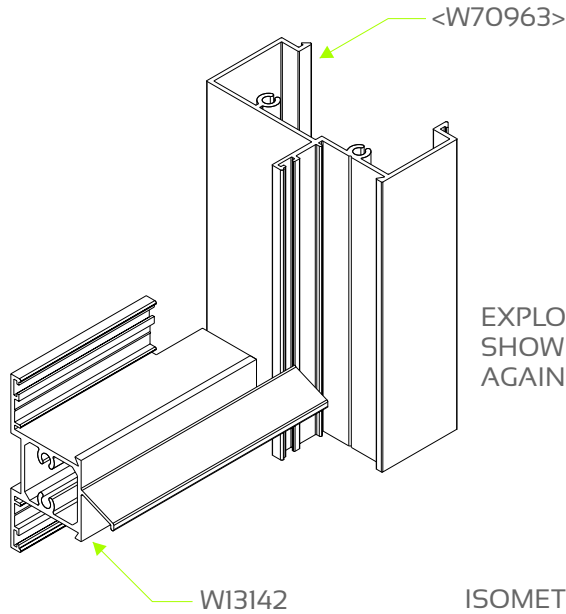

EXPLODED VIEW
SHOWING TRANSOM
AGAINST FRAME

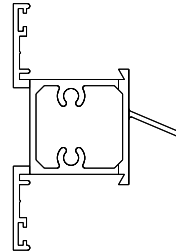

VIEW A-A
Transom with W/Bar
W13142

ISOMETRIC VIEW
SHOWING TRANSOM
AGAINST FRAME

VIEW C

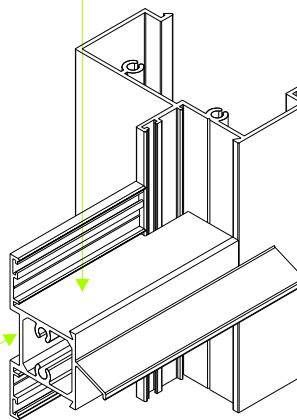

VIEW A

VIEW B

The 3D drawings are diagrammatical only,
please ensure that the correct die number is used

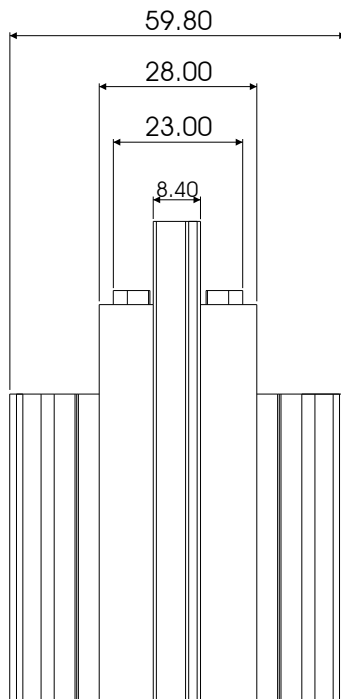

VIEW B-B
Section not to scale

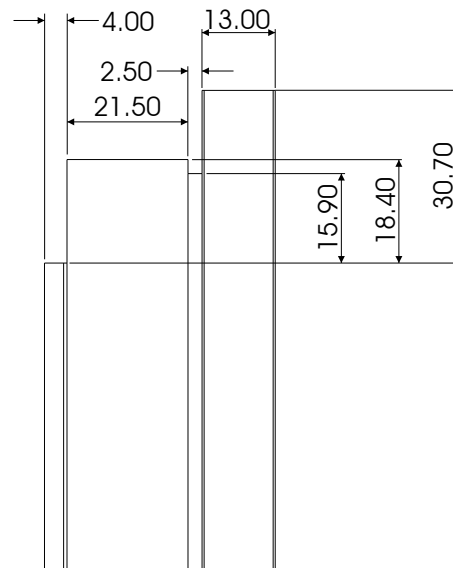

VIEW C-C
Section not to scale

Corner Cleat Assembly Detail

for Tubular Sash

Please Note: These details pertain to the machining of profiles. Lengths of profiles and cutting lists need to be confirmed using the StarFront Program to ensure compliance to the SANS Building Regulations.

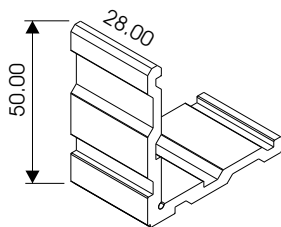
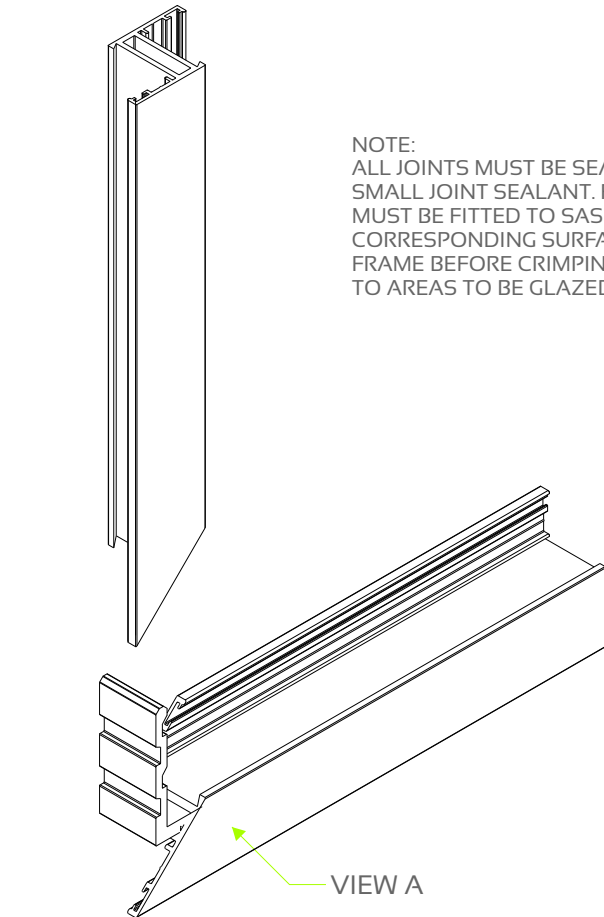

CL10241P

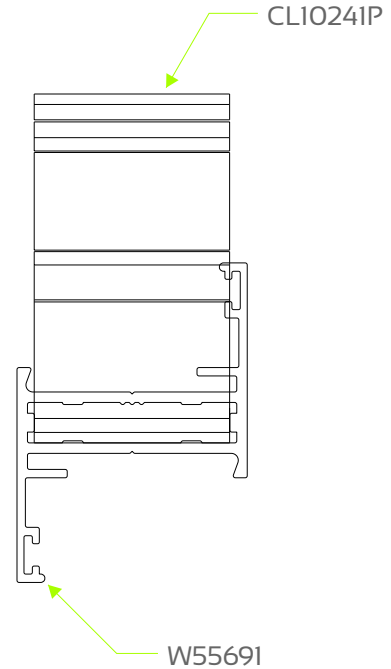

THE CORNER CLEAT HAS BEEN SPECIALLY DESIGNED SO THAT THE CORNER CAN BE CRIMPED EITHER FROM THE INSIDE WITH A HAND OPERATED CRIMPING MACHINE OR FROM THE OUTSIDE WITH A HYDRAULICALLY OPERATED CRIMPING MACHINE

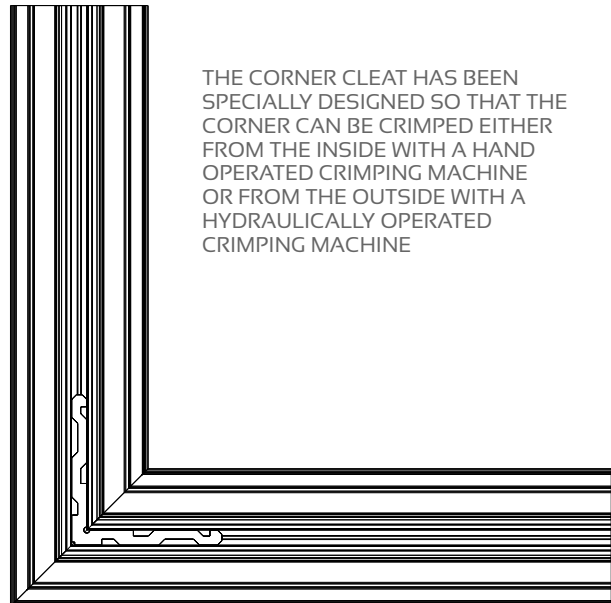

VIEW A-A

The 3D drawings are diagrammatical only, please ensure that the correct die number is used

NOTE: ALL JOINTS MUST BE SEALED WITH SMALL JOINT SEALANT. FINPILE MUST BE FITTED PRIOR TO ASSEMBLY IF SASH IS TO BE FITTED INTO FRAME. FINPLIE MUST NOT RUN BEHIND GLAZING BAR AND GAP MUST BE SEALED TO PREVENT WATER INFILTRATION.

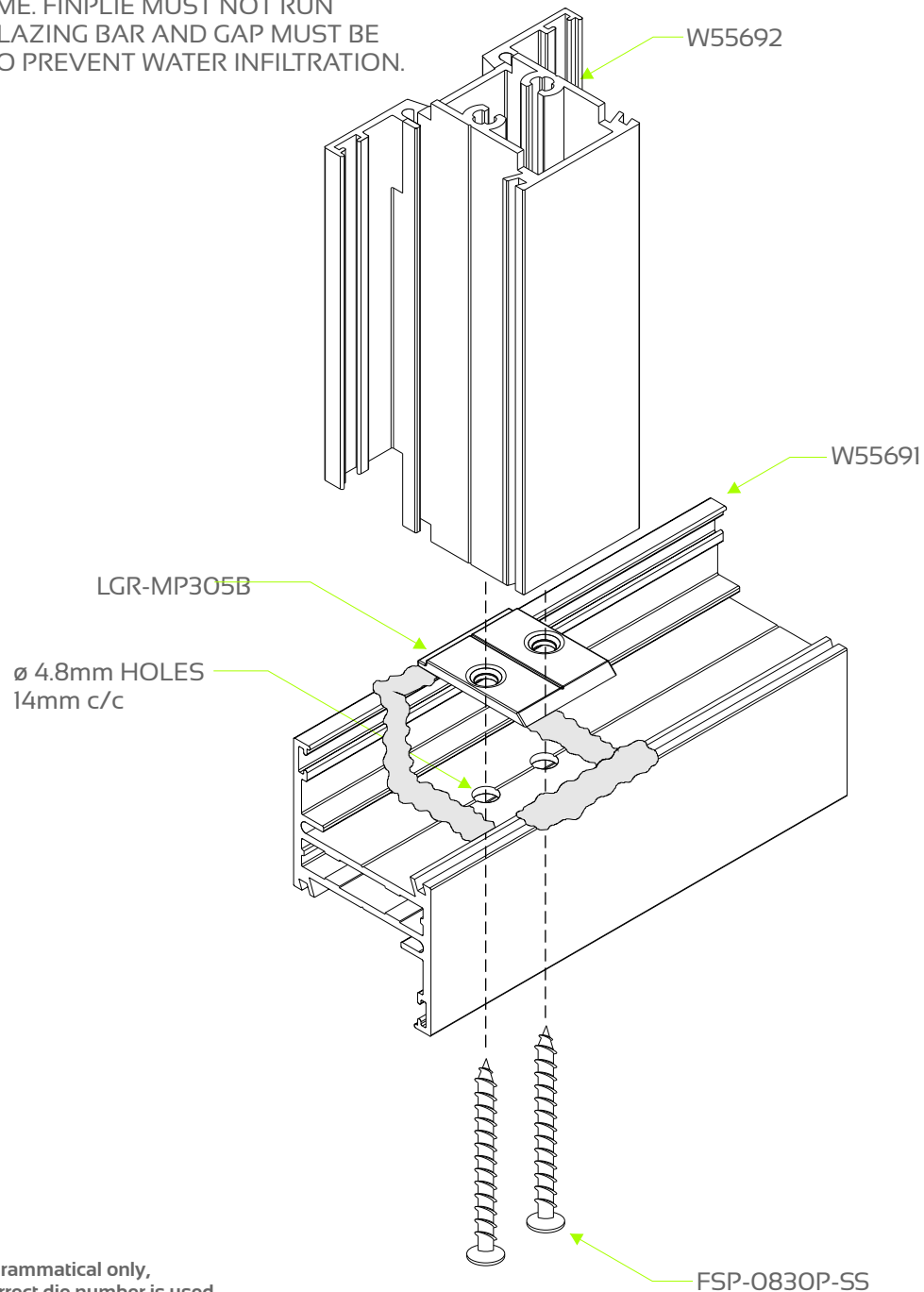

The 3D drawings are diagrammatical only,
please ensure that the correct die number is used

NOTE: ALL JOINTS MUST BE SEALED WITH SMALL JOINT SEALANT. FINPILE MUST BE FITTED PRIOR TO ASSEMBLY IF SASH IS TO BE FITTED INTO FRAME. FINPILE MUST NOT RUN BEHIND GLAZING BAR AND GAP MUST BE SEALED TO PREVENT WATER INFILTRATION.

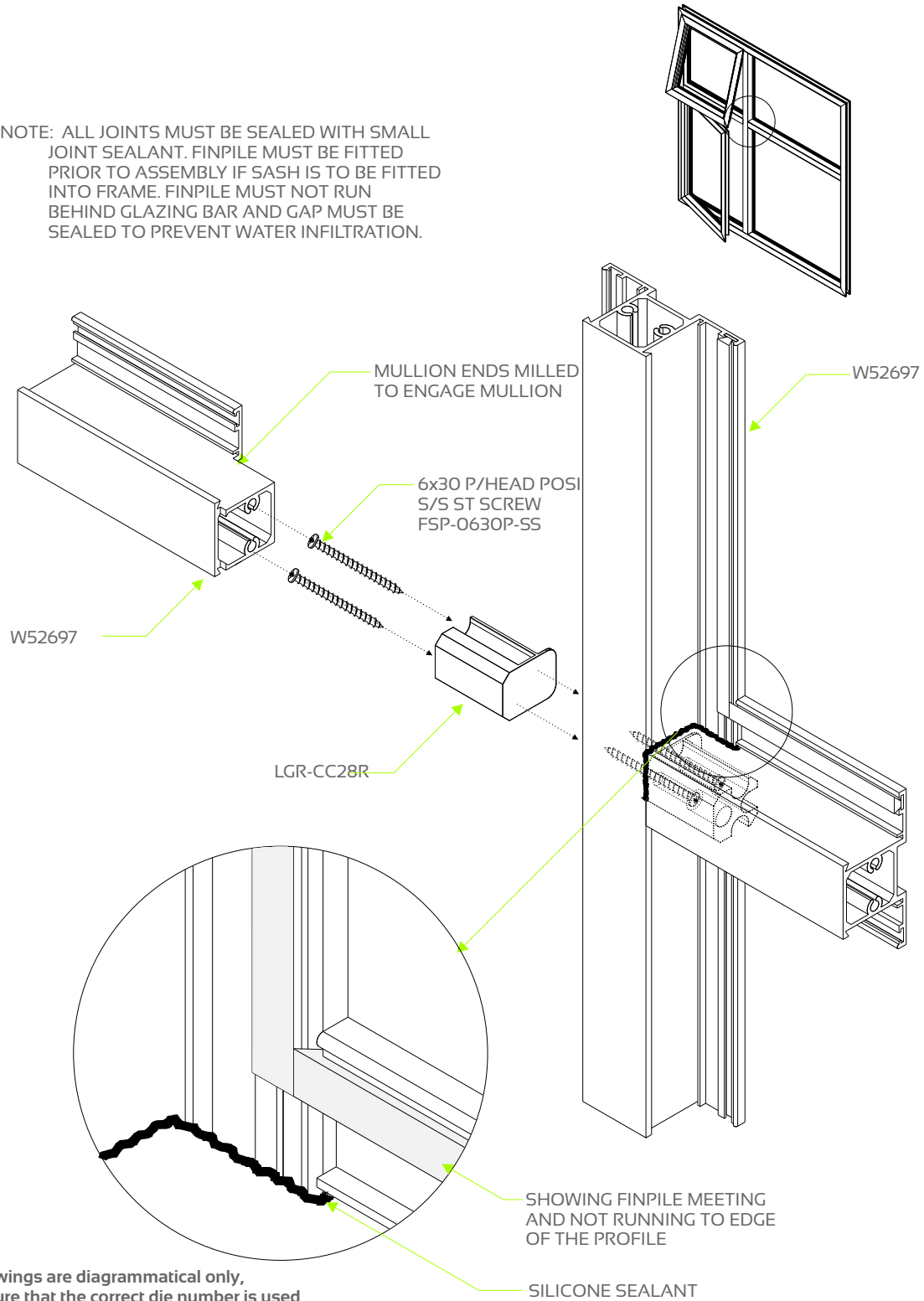

The 3D drawings are diagrammatical only,
please ensure that the correct die number is used

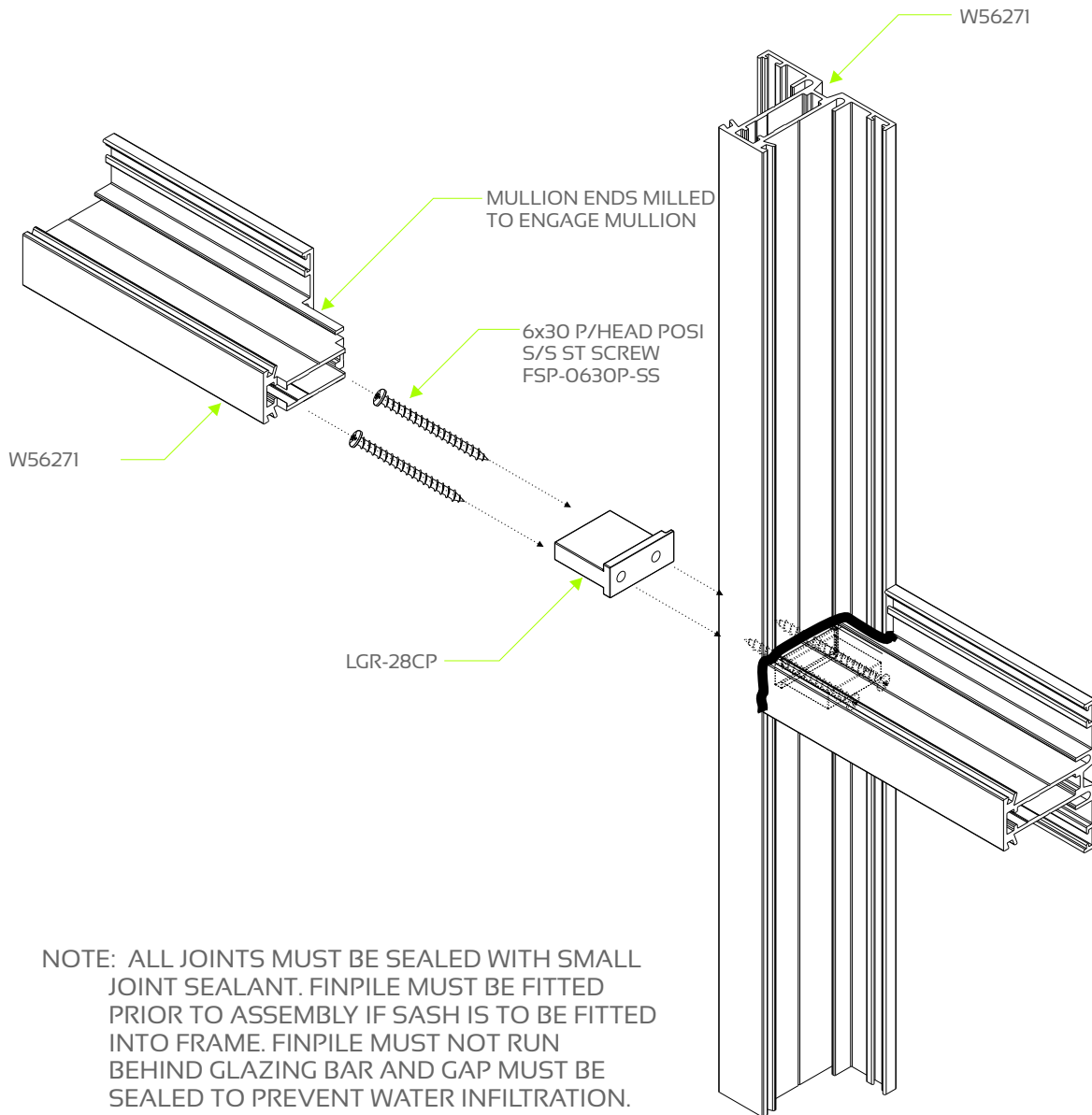

The 3D drawings are diagrammatical only,
please ensure that the correct die number is used

Friction Stay Assembly Detail

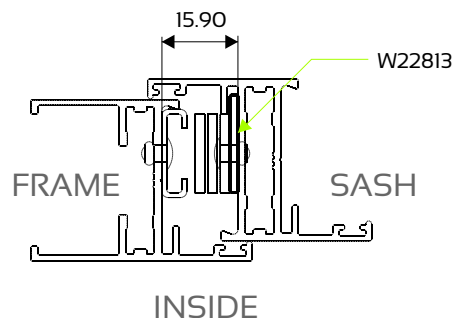
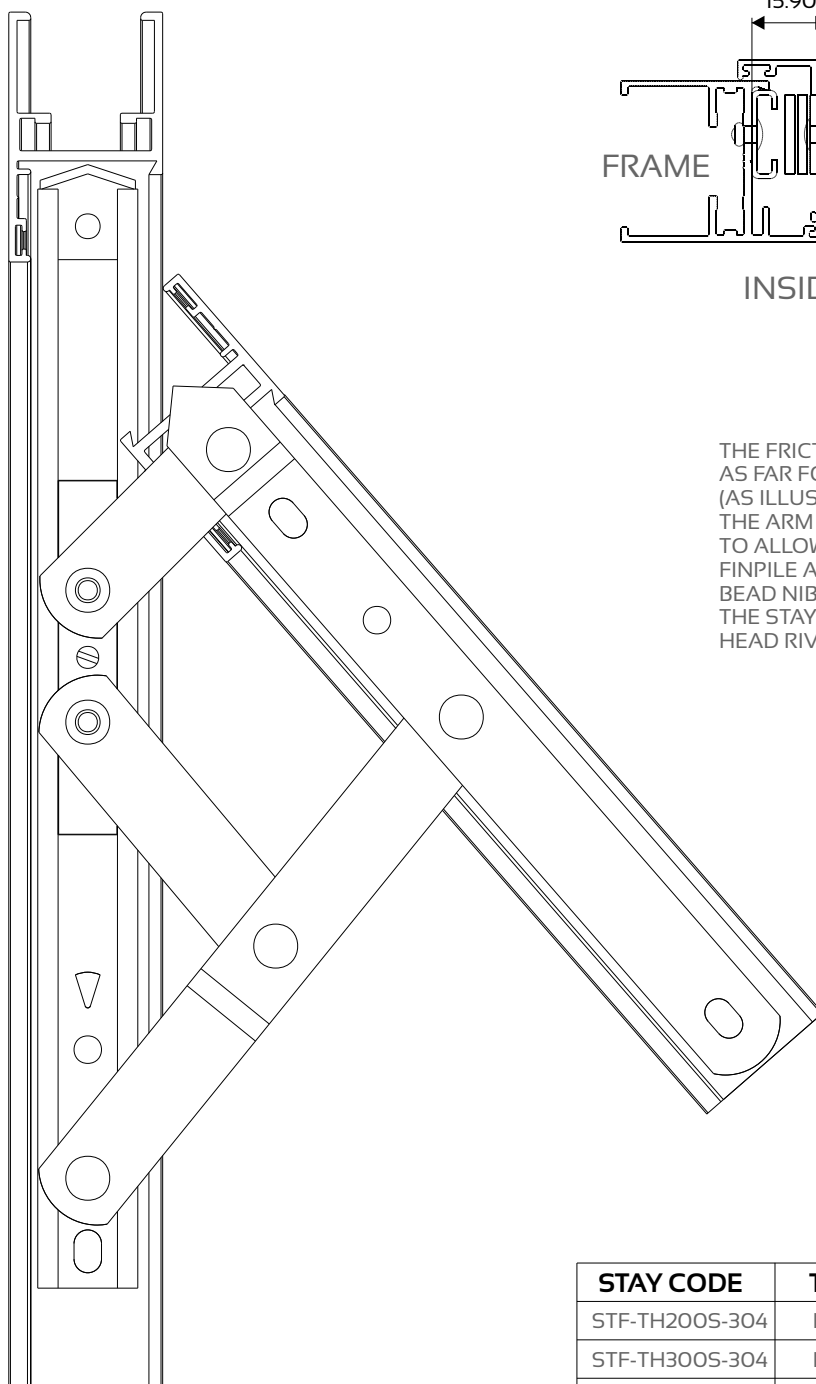

THE FRICTION STAY SHOULD ALWAYS BE FITTED AS FAR FORWARD IN THE FRAME AS POSSIBLE. (AS ILLUSTRATED)
THE ARM FIXED TO THE SASH SHOULD BE FITTED TO ALLOW CORRECT COMPRESSION OF THE FINPILE AND PACKED TO CLEAR GLAZING BEAD NIB.
THE STAYS ARE SECURED WITH 4.8 x 10 DOME HEAD RIVETS.

STAY CODE	TO BE USED FOR SASH SIZE
STF-TH200S-304	LESS THAN OR EQUAL TO 300mm
STF-TH300S-304	BETWEEN 301mm AND 450mm
STF-TH400S-304	BETWEEN 451mm AND 600mm
STF-TH500S-304	BETWEEN 601mm AND 750mm
STF-T600S-304	GREATER THAN 750mm

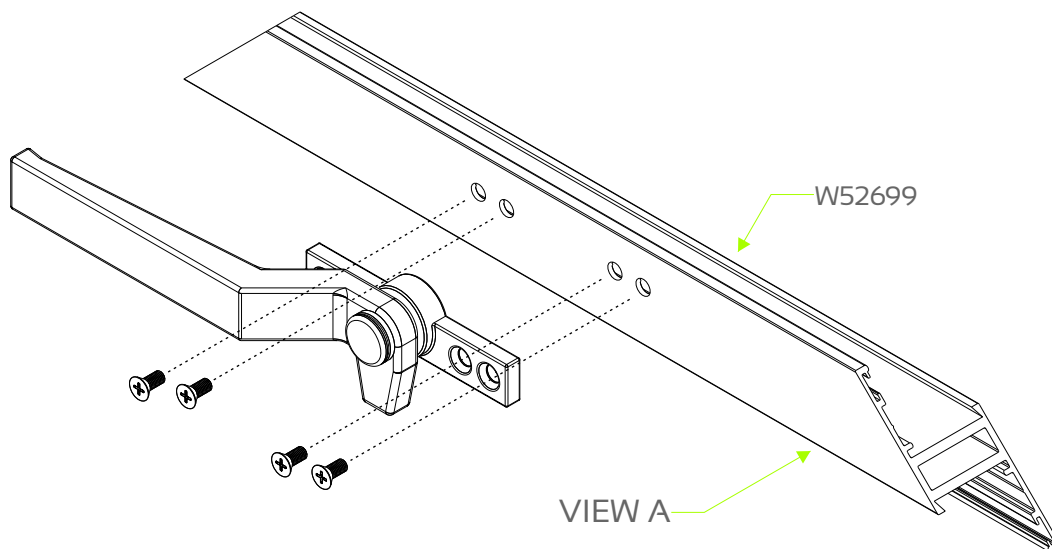

NO 8 x 10 COUNTERSUNK SELF-TAPPING
FLAT END SCREWS

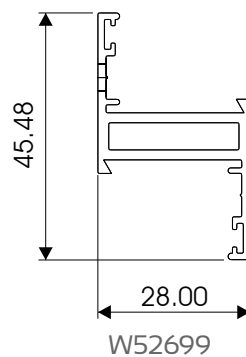
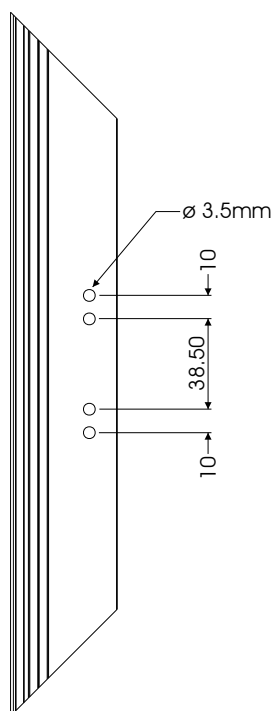

VIEW A-A

The 3D drawings are diagrammatical only,
please ensure that the correct die number is used

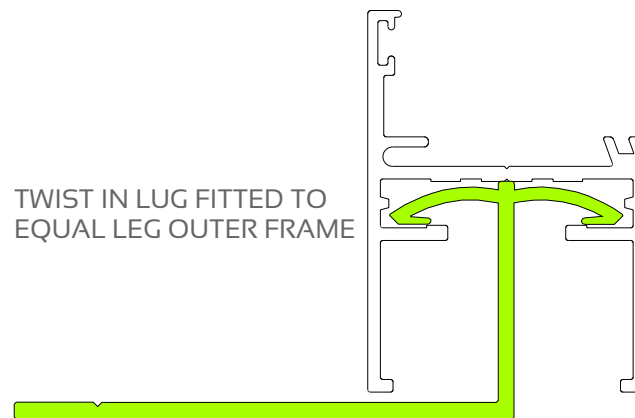

Bead Cut-Out for Setting Block

Bead must be notched out at position of all glass setting blocks according to the length of the glass setting block used.

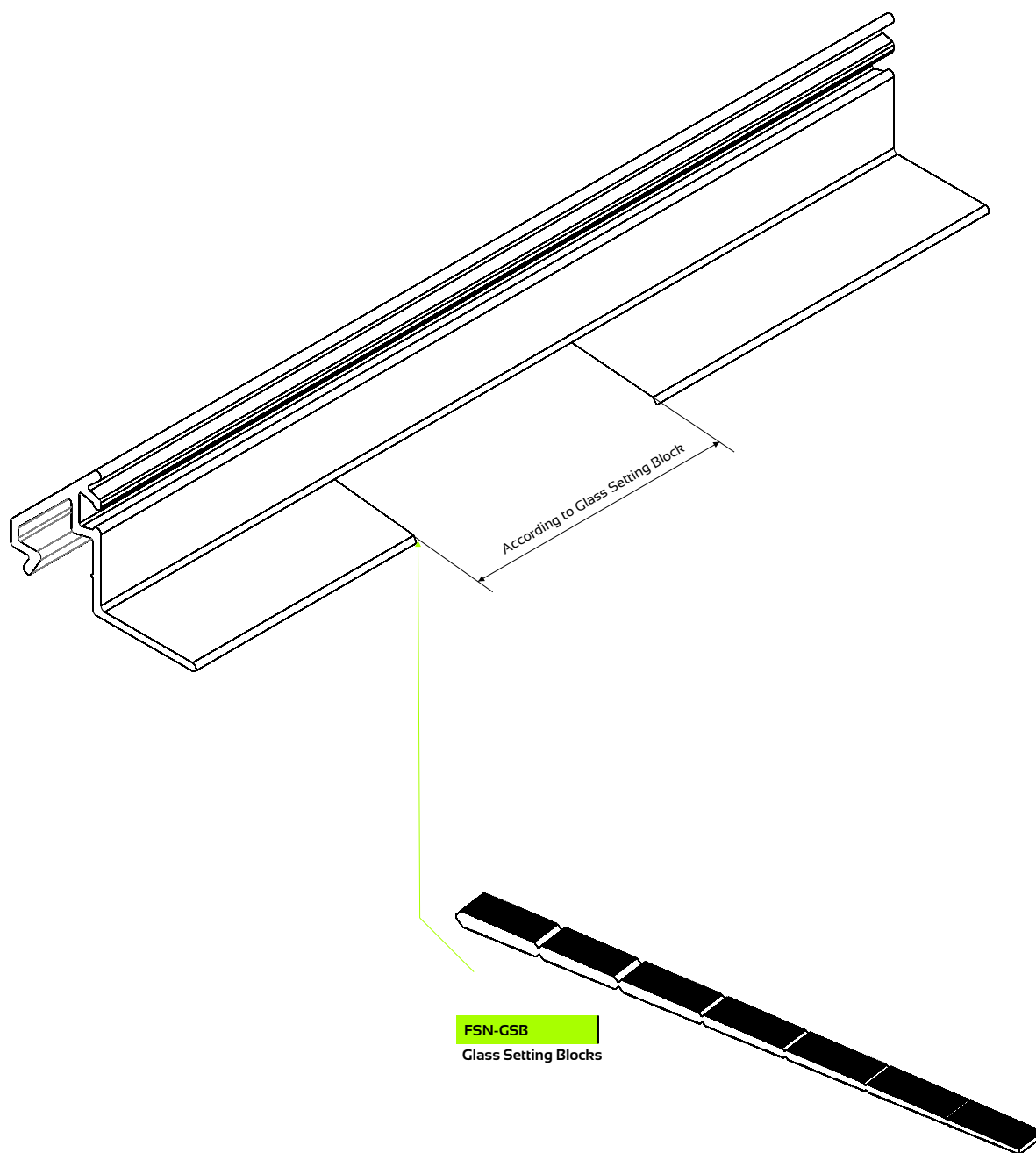

The 3D drawings are diagrammatical only,
please ensure that the correct die number is used

Insert the pull-in vinyl gasket into glazing beads by sliding or pressing it into the groove (1). Before cutting gasket, ensure that it has not stretched and cut 6mm longer so that corners are in compression at all times.

Position bottom glazing bead in glazing bead rebate (2).

Place glass on glazing blocks (3).

Insert top and then side glazing beads ensuring that they are in correctly.

Starting from top centre, insert roll in gasket (4) without stretching it (5). Stop 150mm from corner and partly cut gasket 6mm longer than the edge of the vertical bead. Insert gasket at corner and then roll in remaining 150mm. Repeat this on the other sides. Where gasket ends meet, cut gasket 6mm longer. Insert cut ends first and complete.

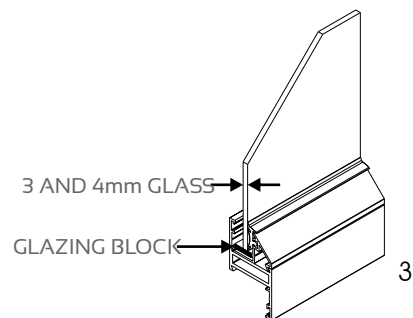
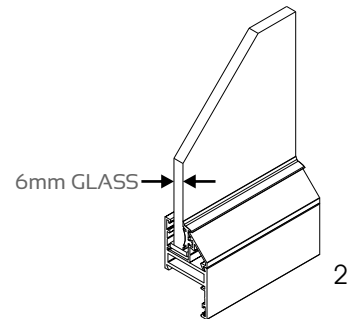
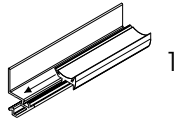

ENSURE GASKETS ARE NOT STRETCHED AT ANY STAGE

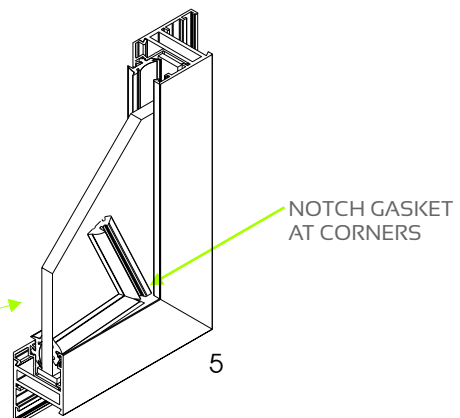
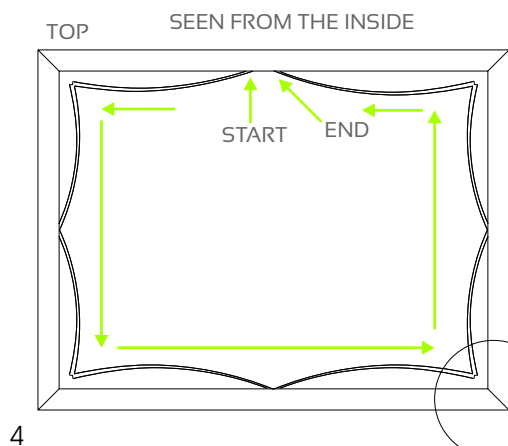

GLAZING

1. SELECTION OF GLAZING METHODS

1.1 SETTING AND LOCATION BLOCKS

Glass-to-metal contact must be avoided at all times by using setting and location blocks having a hardness of 50° to 90° shore A durometer. Use only blocks made of Neoprene, EPDM, Silicone or other elastomeric material.

Setting blocks are to have a minimum thickness of 3mm and must be at least 27mm in length per square metre of glass area.

The position of the setting and location blocks is illustrated in Figure 2.

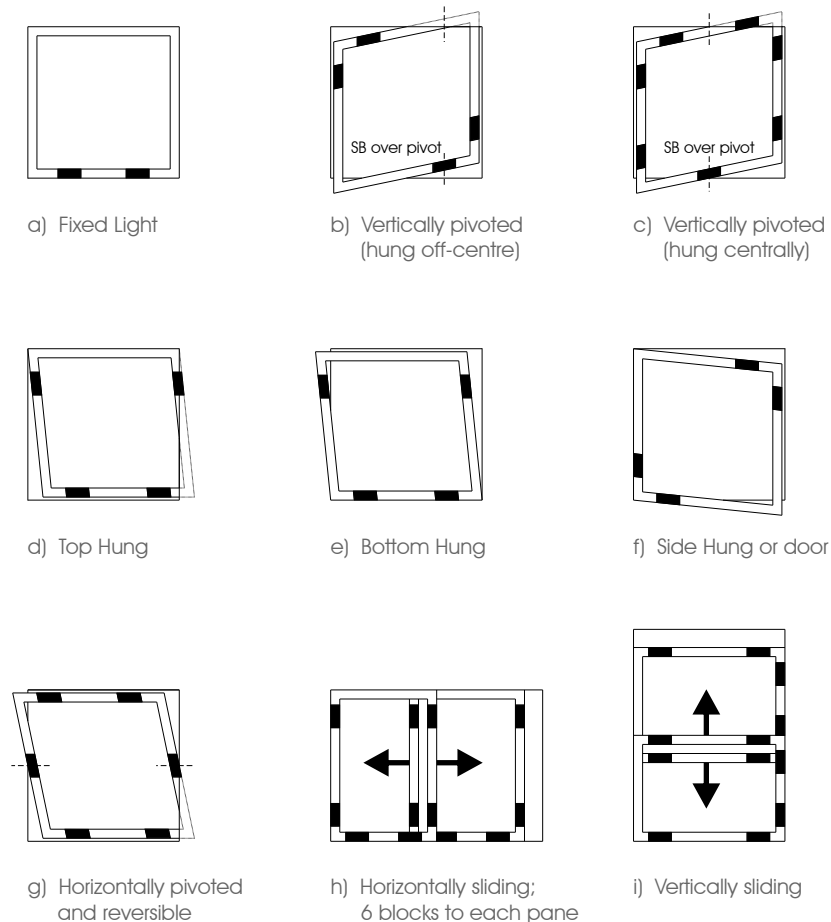

FIGURE 2 - POSITION OF SETTING AND LOCATION BLOCKS