

PRODUCT MANUAL
March 2018

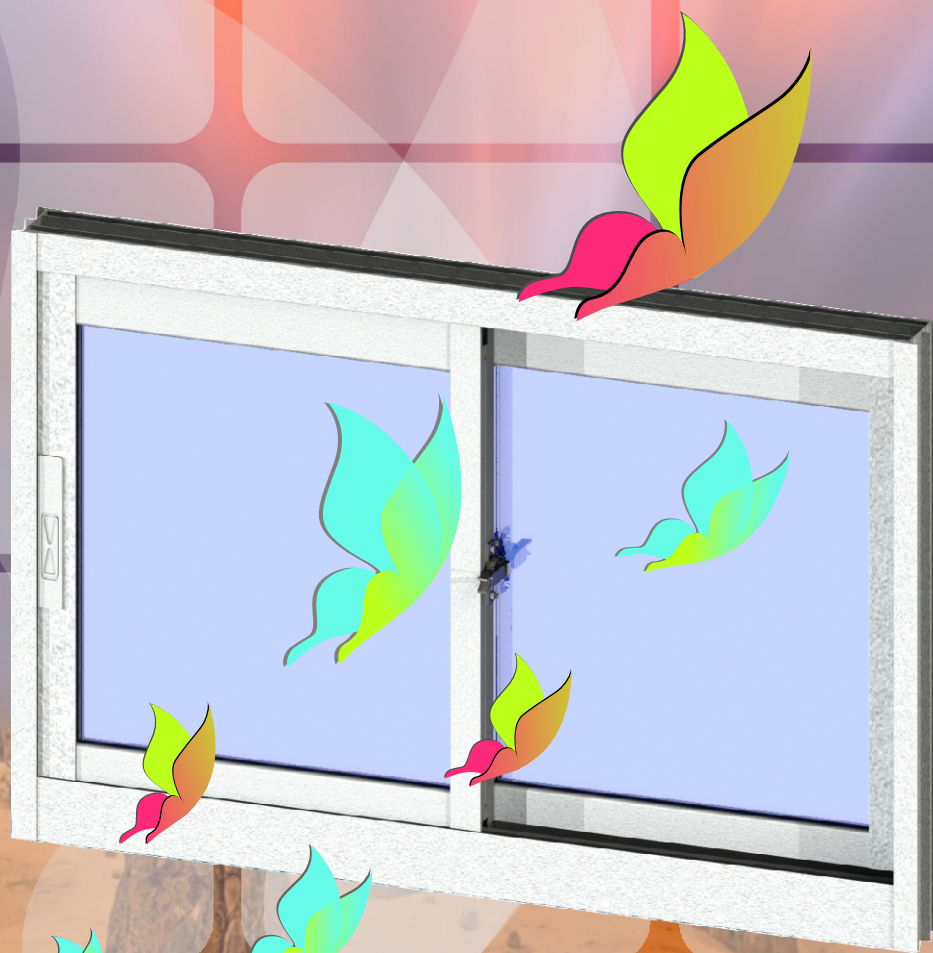

ELITE™
SLIDING WINDOW

General Documentation Disclaimer

This manual is intended as a manufacturing and installation advisory document. For correct specifications, sizing of profiles and structural information please consult the StarFront Application. If the information you require is not available through the StarFront Application, please contact your stockist before proceeding. It is advisable to have all sizing and performance criteria checked by a qualified structural engineer to ensure that the required criteria will be met.

All information, recommendations or advice contained in this documentation is given in good faith to the best of Wispeco's knowledge and is based on current procedures in effect.

Since the actual use of this documentation by the user is beyond the control of Wispeco, such use is within the exclusive responsibility of the user. Wispeco cannot be held responsible for any loss incurred through incorrect or faulty use of this documentation. Training of Wispeco systems is important for ensuring correct procedures in the manufacturing of products.

Great care has been taken to ensure that the information provided is correct.

Ensure that you have the latest available manual. The revision number and date can be checked on the latest StarFront version.

Wispeco will accept no responsibility for any errors and/or omissions, which may have inadvertently occurred.

Specifications concerning products and applications

This manual is based on standard configurations only. As there are many configurations not covered in this manual, contact your stockist with regards to a configuration not represented herein if required.

AutoDesk drawings (CAD Symbol Library) are available on request and can be issued with the consent of the Wispeco Technical Department.

All mechanical joints must be sealed with a **Crealco approved joint sealer**. Failure to correctly seal the joints can affect the performance of the system. Information on joint sealing can be found in the Cleaning & Maintenance Manual available for download from the Wispeco website or from StarFront.

All drawings in the Wispeco Documentation are NOT to scale and are used for illustrative purposes only.

Wispeco will not accept responsibility for the use of standard products since Wispeco does not know where these products are being installed.

The hardware recommended in this documentation is suitable for use in most atmospheric environments. When hardware is used in severe coastal environments the manufacturer of the hardware must be consulted.

For the coastal regions and any other high corrosion areas, the following is advised: to minimize phylliform corrosion use SurTec650 RTU spray during the manufacturing of aluminium profile systems. This should be applied, before assembly, on all pre-work aluminium where the powder coating covering has been removed thereby exposing the raw aluminium base.

The use of non-specified hardware or incorrect mechanical fasteners can adversely affect the mechanical and weathering performance of the system and we strongly advise against deviations. A Wispeco Consultant can advise you of any hardware issues and limitations with regard to this system.

The use of anti-magnetic stainless steel screws and aluminium pop rivets is recommended to reduce galvanic corrosion in harsh environments.

Fixing lugs on frames must be positioned as per the user manual and used in accordance to the AAMSA specifications. When profiles are screwed together the screw centres must also be according to the user manual or as specified by an engineer.

All glass used within Wispeco products must comply with SAGGA regulations. Laminated glass must not stand in water.

By continuing to use this documentation you acknowledge that you understand and accept the legal disclaimer.

This manual must be read in conjunction with the Installation, Cleaning & Maintenance Document and the Performance Certificates for the relevant system. The manual must also be used in conjunction with the design and cutting list from the latest version of StarFront.

Legal Disclaimer.....	i
Index.....	1

General System

Profile Identification.....	2
Hardware Components.....	3
Size Limitation Guide.....	4
Typical Configurations.....	5
Fixing Details.....	6
Cross-Sectional Detail.....	
Cutting Sizes.....	7-8
H/D Interlocker.....	9
XXXX Configuration.....	10
Assembly Detail.....	
Outer Frame Component.....	11
Sash Frame Component with Lock.....	12
Sash Frame Component with Catch and Keep.....	13
Bottom Roller Detail.....	14
Sidelight Bottom Rail.....	
Casement 30.5.....	15
Casement 28.....	16
Machining Detail.....	
Meeting Stile.....	17
for Sill Drainage.....	18-21
Jamb Rail.....	22
Lock Stile.....	23
Interlock.....	24
Assembly Detail.....	
Head Sill Rail.....	25
Latch.....	26
Anti-Lift Block.....	27
Sub-Light Detail.....	28
Side Light Adaptor.....	
Casement 28.....	29
Casement 30.5.....	30
Casement 38.....	31
Fitting of Sill Extension for A2 and A3.....	32
Glazing Procedure.....	33

Profile Identification

Elite Window Profiles

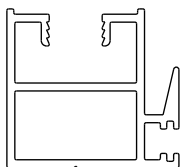

DIE No. W55168

Elite Interlocker

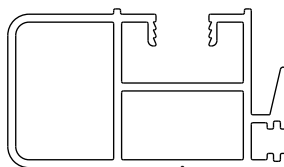

DIE No. W55167

Elite Heavy Duty
Interlocker



DIE No. W31082

Elite Sash
Top&Bottom

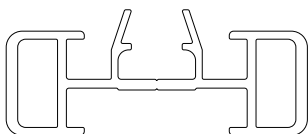

DIE No. W57553

Elite Meeting
Stile

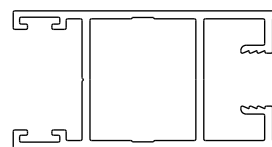

DIE No. W55166

Elite Lock Stile

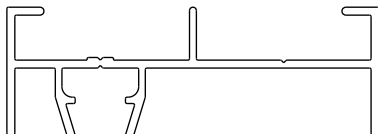

DIE No. W31080

Elite Frame Jamb

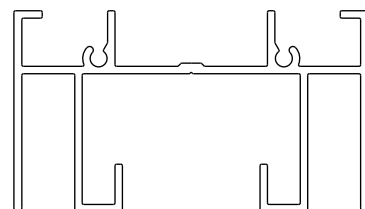

DIE No. W31079

Elite Frame Head

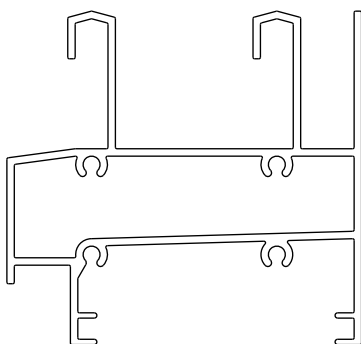

DIE No. W55169

Elite Frame Sill

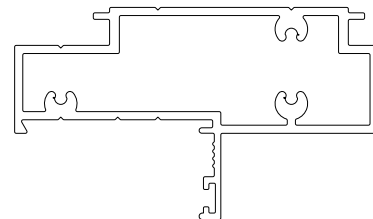

DIE No. W57363

Elite Sub Light

Hardware Components

RECOMMENDED ELITE SLIDING WINDOW COMPONENTS

All hardware is available through our Stockists as well as through Crealco Components, and can be viewed on www.crealco-components.com

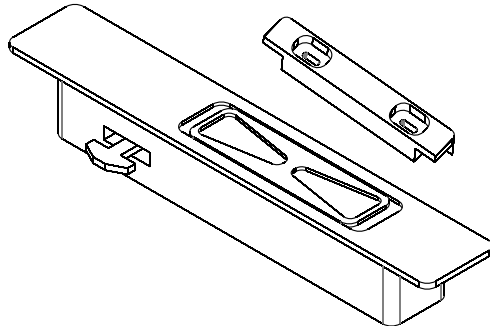

HFP-HWK-NAT
HFP-HWK-WHT
HFP-HWK-BLK
Handle

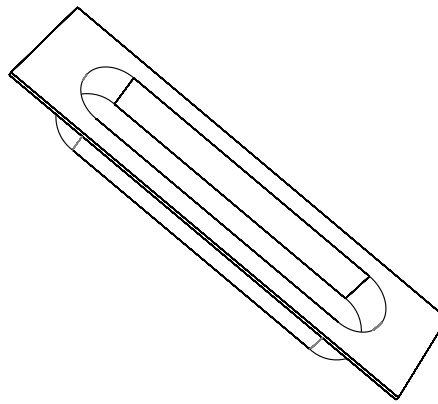

HPL-MFP-BLK
HPL-MFP-WHT
Mini Flush Pull Handle

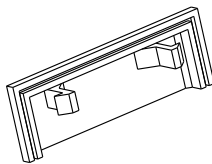

PEX-WDC
Drainage Cover

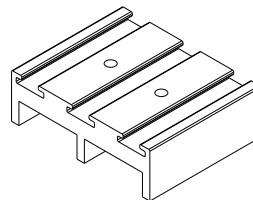

SGD-AL
Draught Excluder Anti Lift

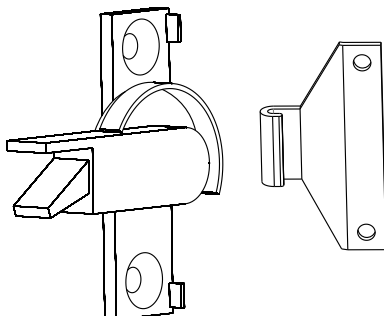

HCC-CC
Cam Catch

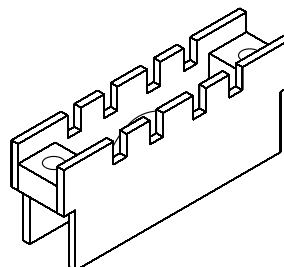

SDW-RH
Roller Housing

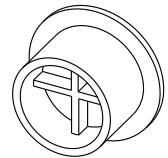

PEX-NRV
Non-Return Valve

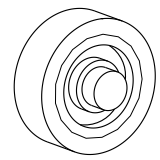

SDW-ROLL
Roller Only

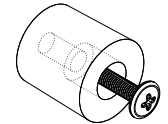

SGD-VST + FSP-0820P-SS
Stopper With Screw

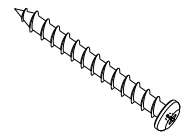

FSP-0830P-SS
P/Head POSI
8x30 S/S Screw

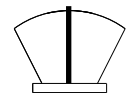

GFP-6790
Finpile

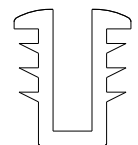

GCH-H33
Channel H33

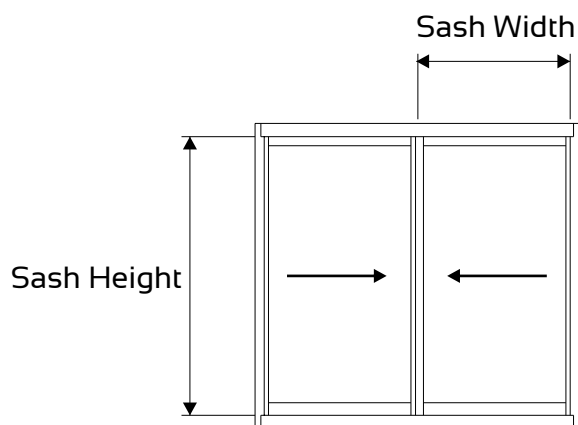

MAXIMUM SASH WIDTH = 1500mm

MAXIMUM SASH HEIGHT = 1800mm

(SEE LIMITATION CHARTS)

XX CONFIGURATION

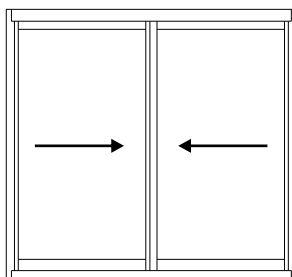

XOX EQUAL PANE CONFIGURATION

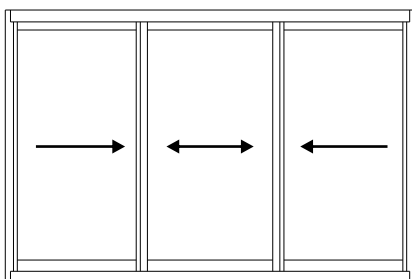

XOX UNEQUAL PANE CONFIGURATION

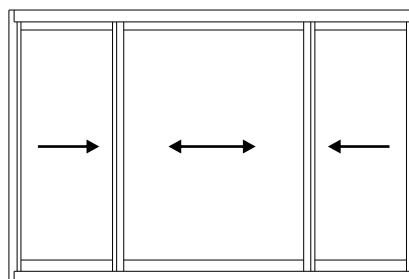

XXXX CONFIGURATION

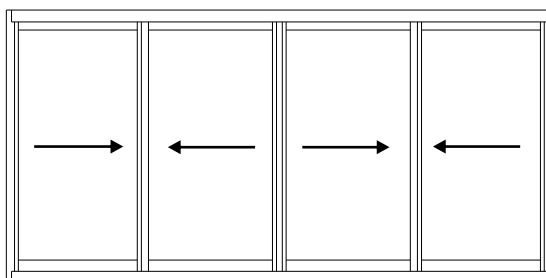

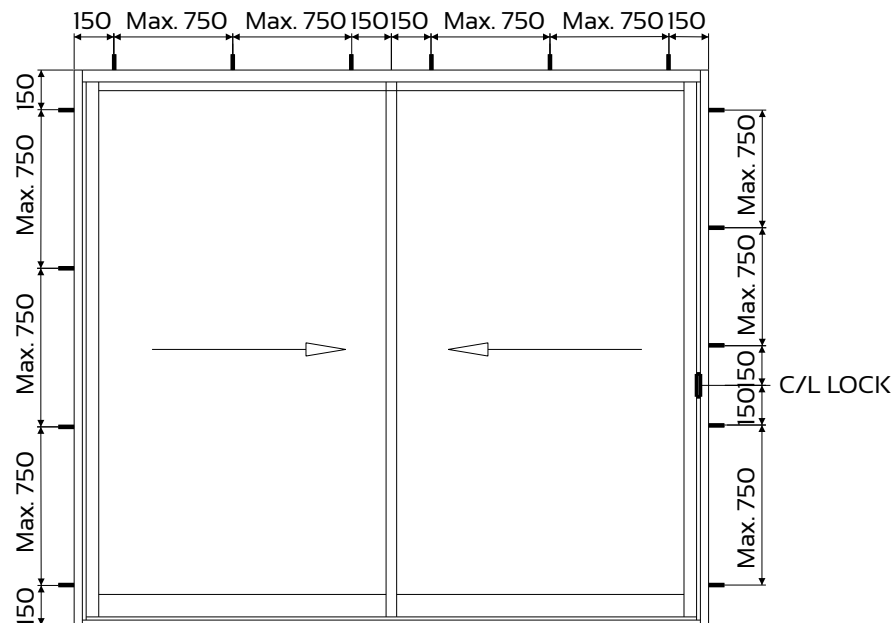

**TYPICAL OX SLIDING DOOR &
HORIZONTAL SLIDING WINDOW**

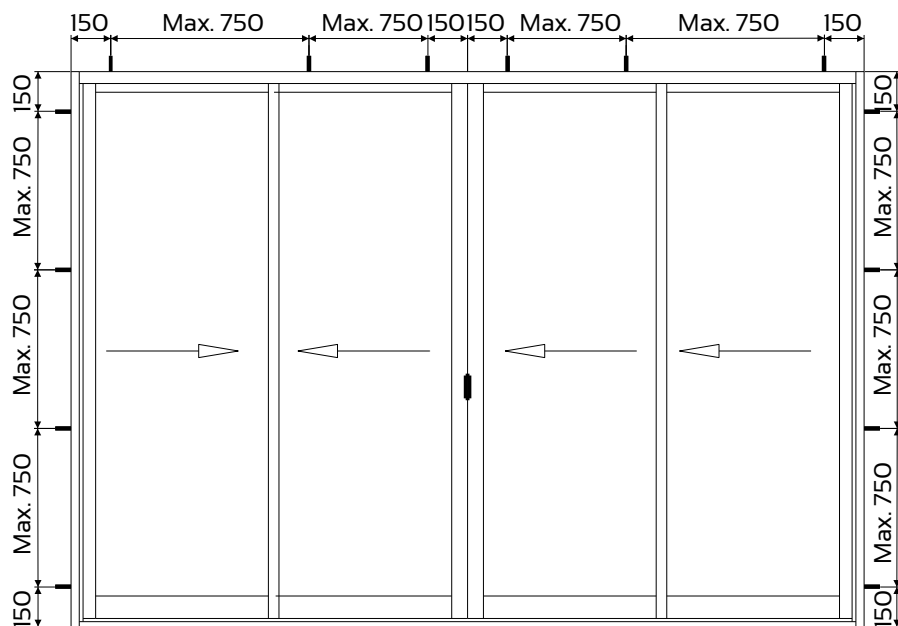

**TYPICAL OXXO SLIDING DOOR &
HORIZONTAL SLIDING WINDOW**

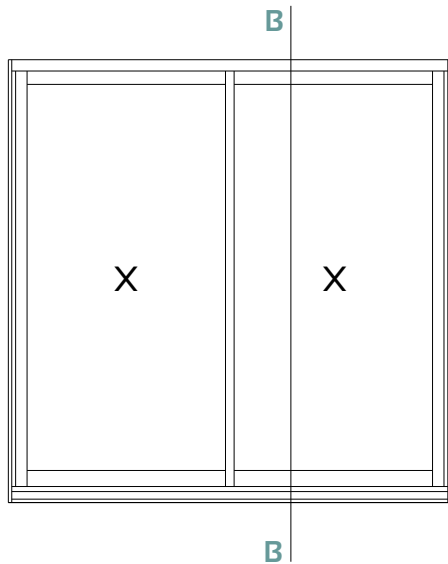

OUTSIDE

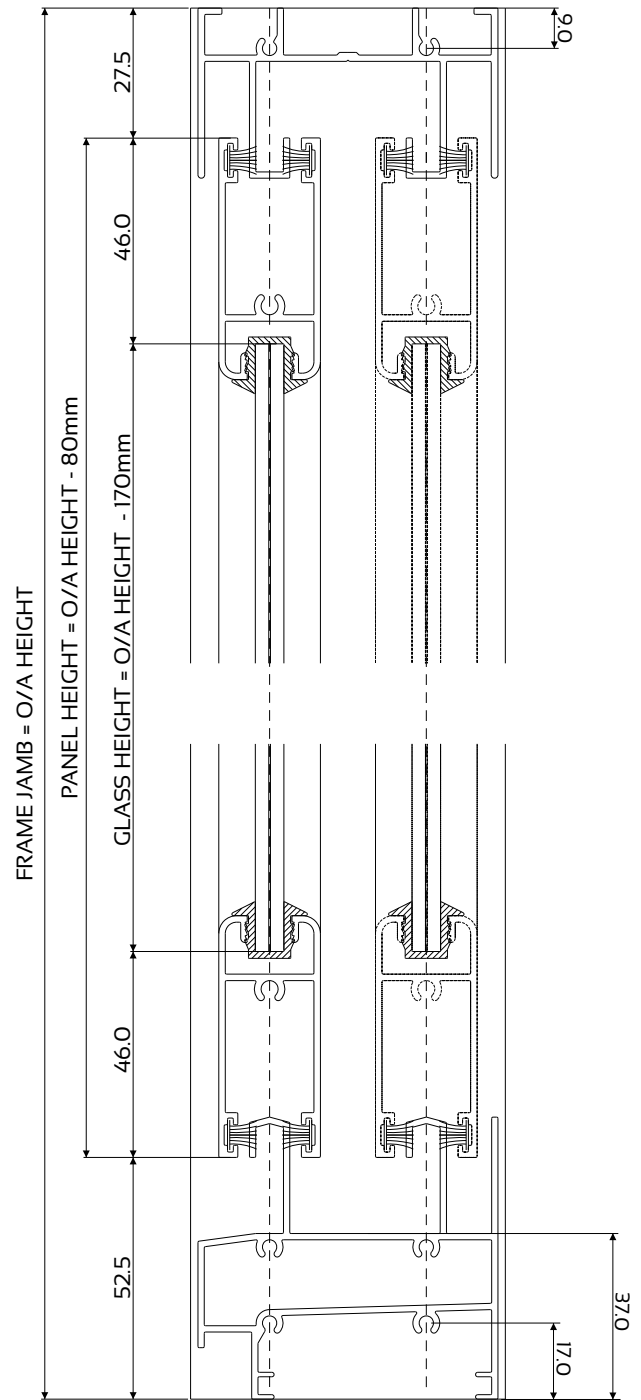

SECTION B-B
Section not to scale

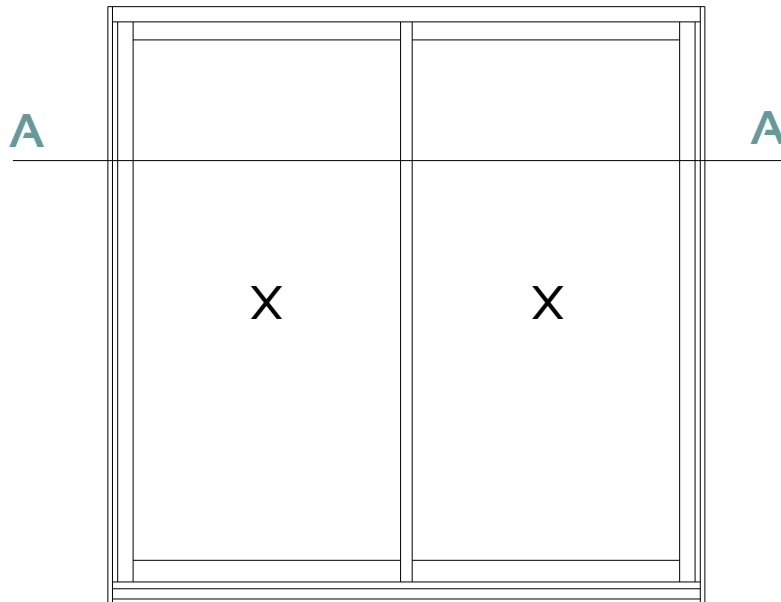

SECTION A-A

Section not to scale

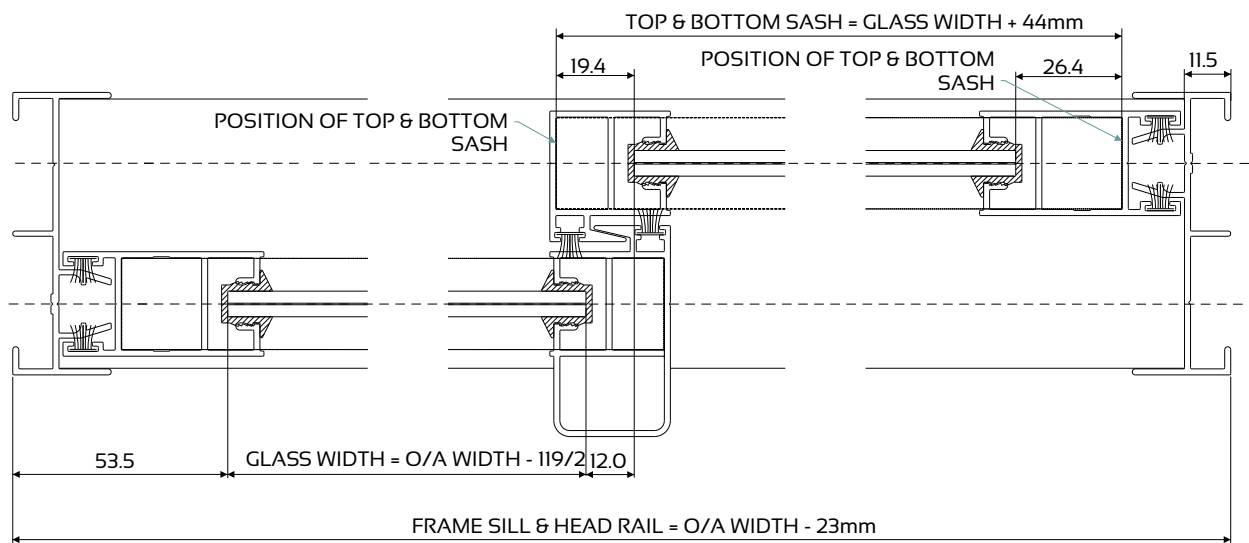

OUTSIDE

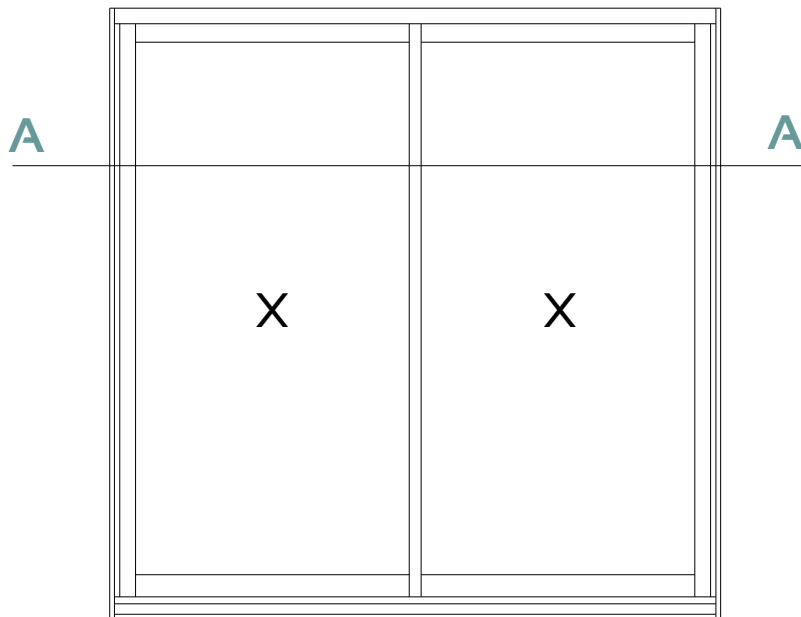

SECTION A-A

Section not to scale

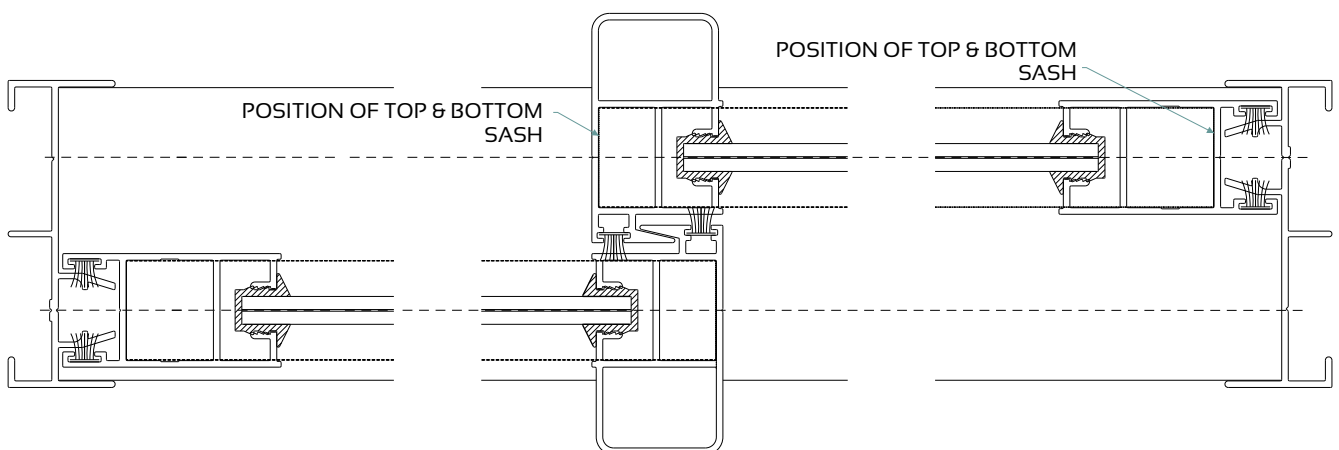

OUTSIDE

Cross-Sectional Detail

XXXX Configuration

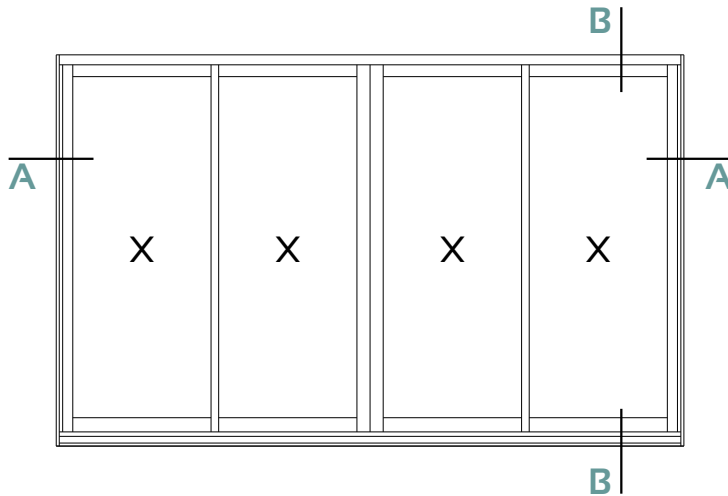

SECTION B-B
Section not to scale

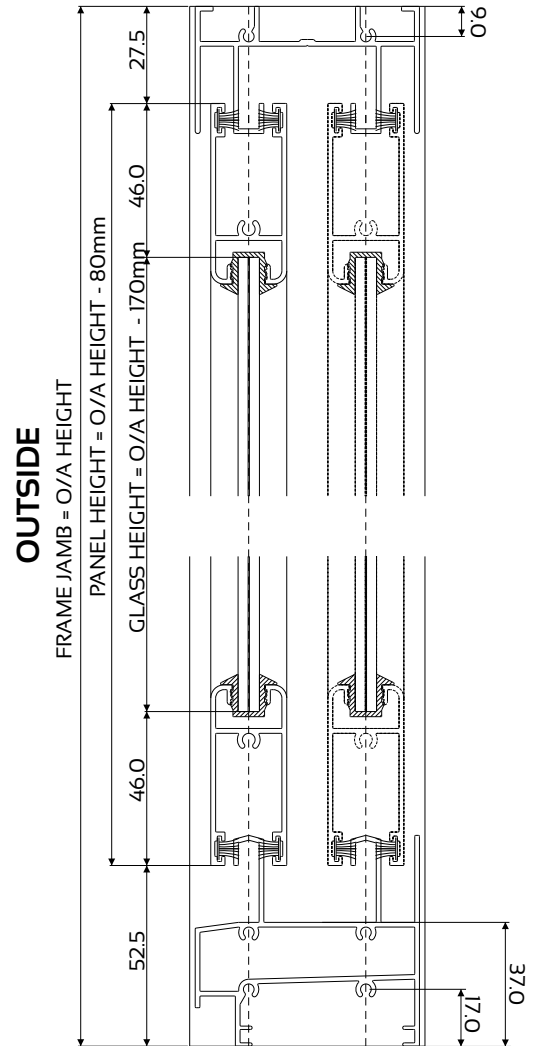

SECTION A-A
Section not to scale

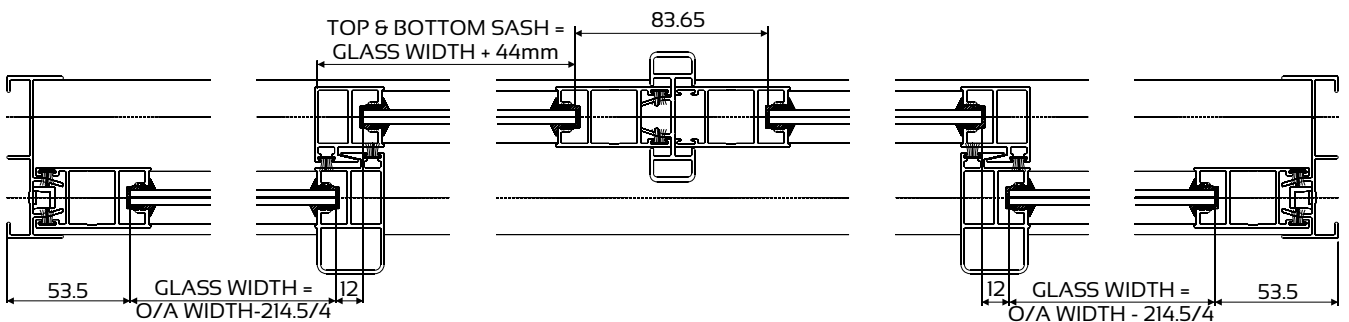

OUTSIDE

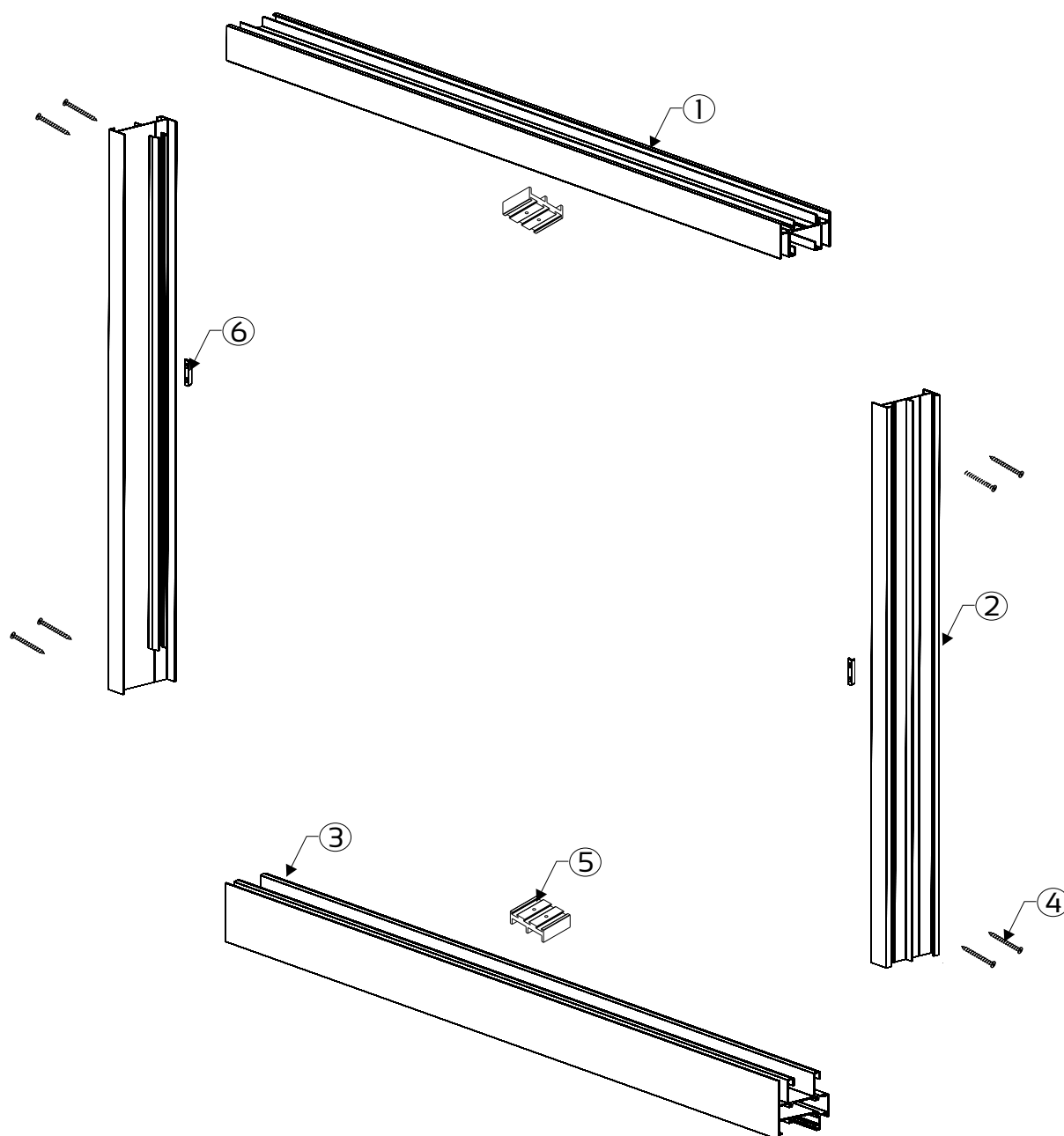

System Profiles

ITEM	QTY	DIE No.	DESCRIPTION
1	1	W31079	Elite Frame Head
2	2	W31080	Elite Frame Jamb
3	1	W55169	Elite Frame Sill

Hardware

ITEM	QTY	COMPONENT DESCRIPTION
4	8	8x30 P/Head POSI S/S Screw
5	2	Draught Excluder
6	2	Handle Catch & Keep

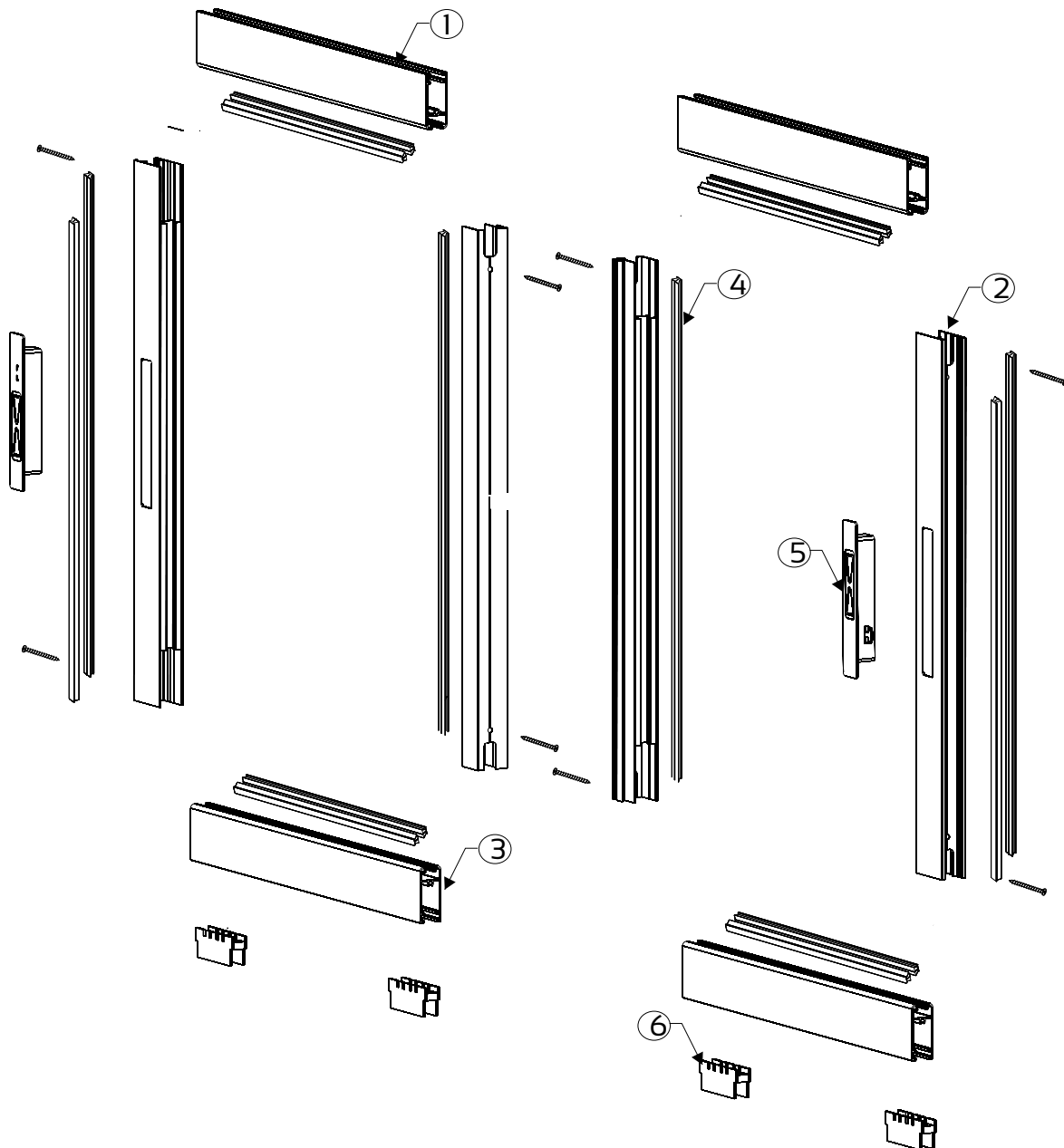

System Profiles

ITEM	QTY	DESCRIPTION
1	2	Elite Sash Frame Head
2	2	Elite Sash Frame Jamb
3	1	Elite Sash Frame Sill

Hardware

ITEM	QTY	COMPONENT DESCRIPTION
4	8	Finpile
5	1	Lock
6	4	Rollers

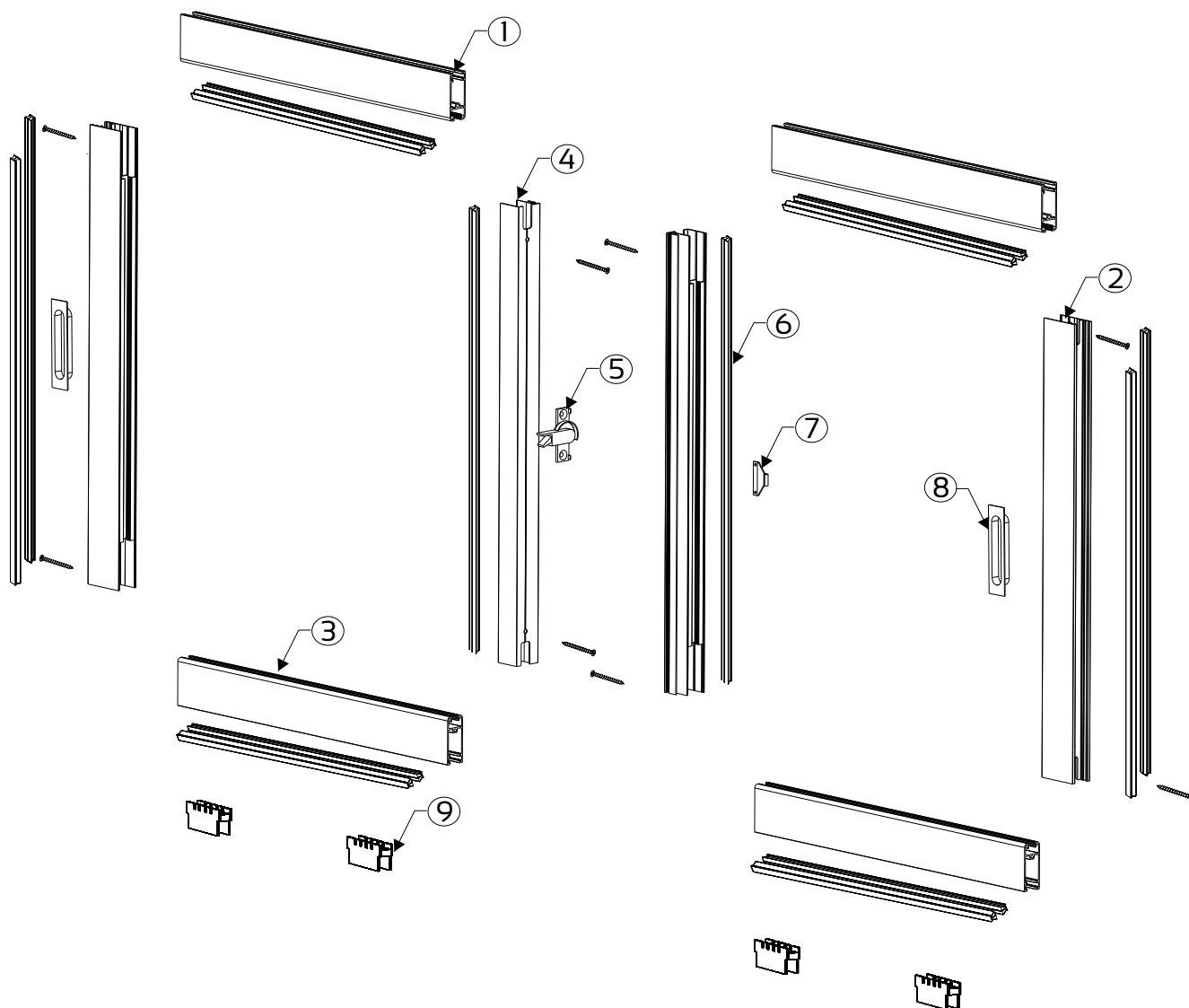

System Profiles

ITEM	QTY	DESCRIPTION
1	2	Elite Sash Frame Head
2	2	Elite Sash Frame Jamb
3	2	Elite Sash Frame Sill
4	2	Elite Sash Interlocker

Hardware

ITEM	QTY	COMPONENT DESCRIPTION
5	1	Catch
6	8	Finpile
7	1	Keep
8	1	Mini Flush Pull Handle
9	4	Rollers

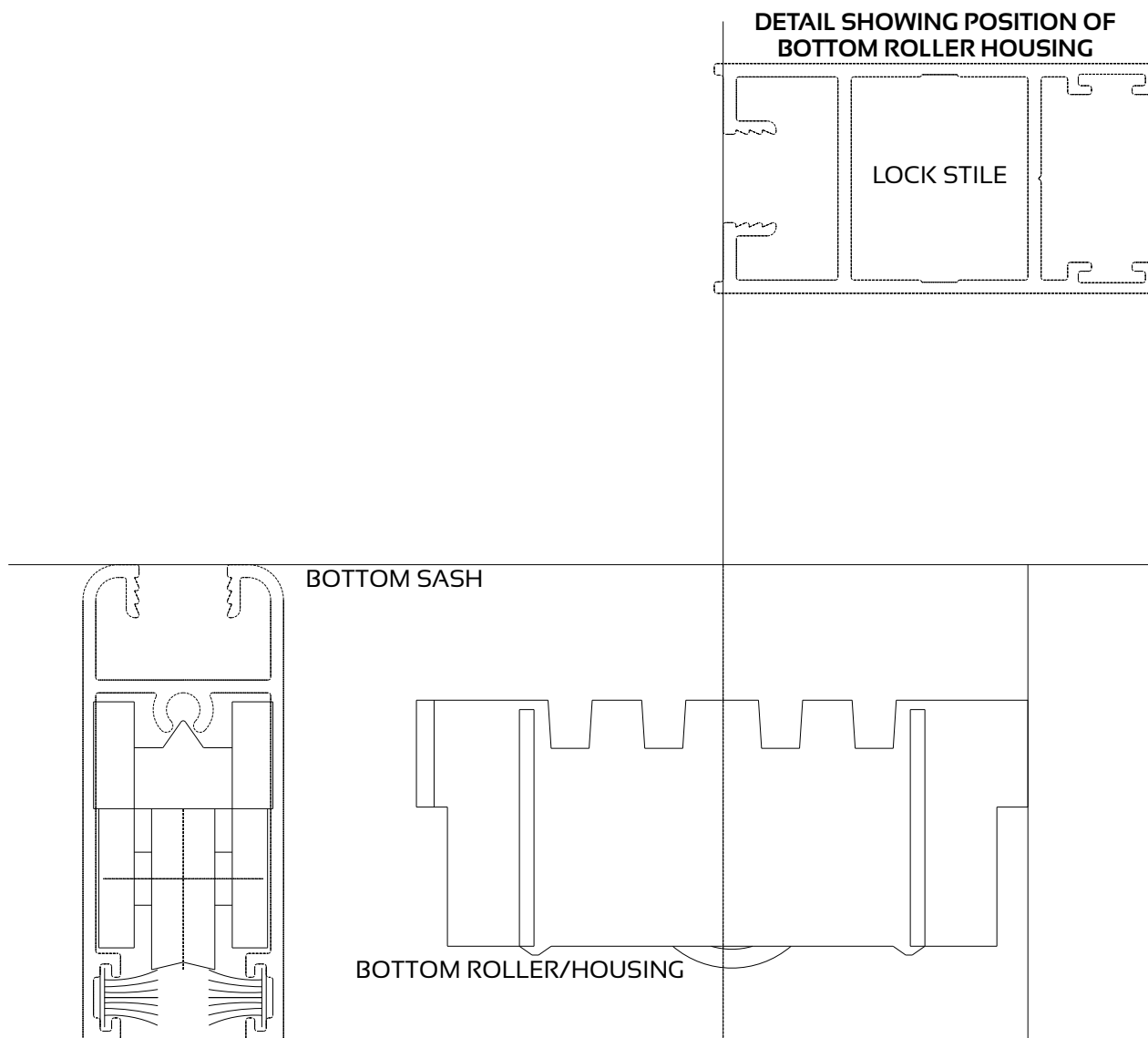

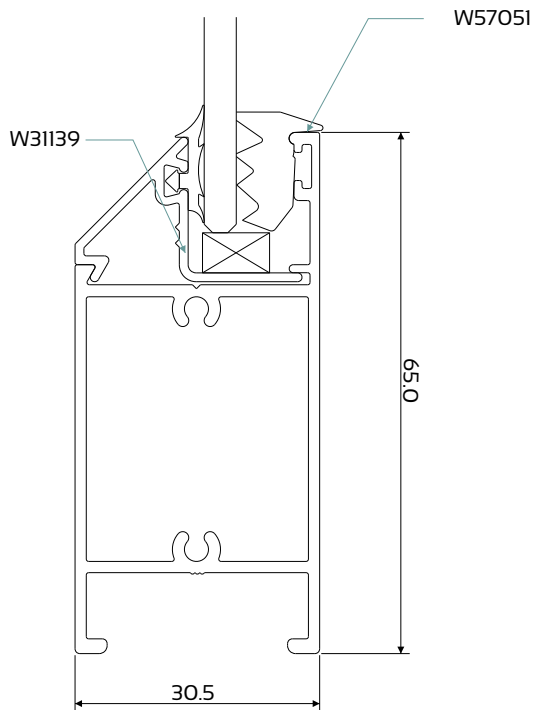

CASEMENT 30.5 SIDELIGHT
BOTTOM RAIL

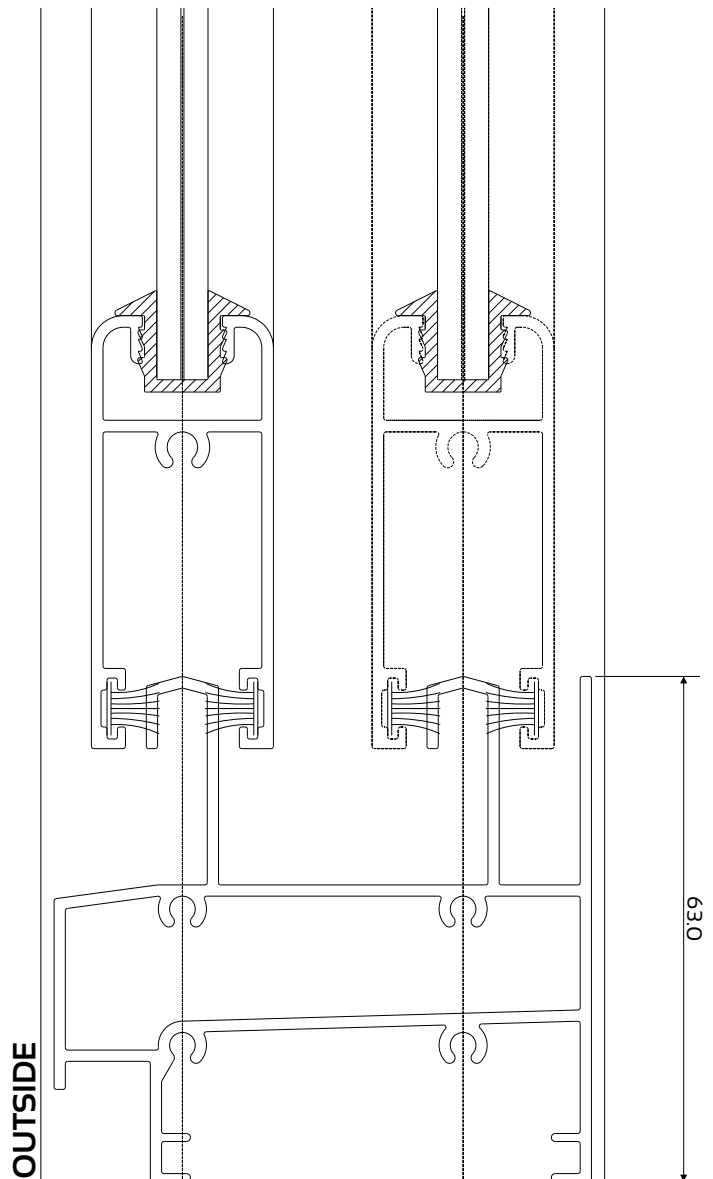

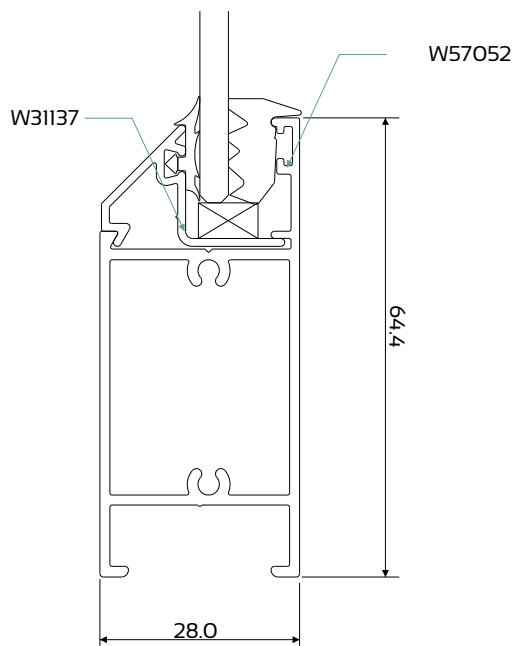

CASEMENT 28 SIDELIGHT
BOTTOM RAIL

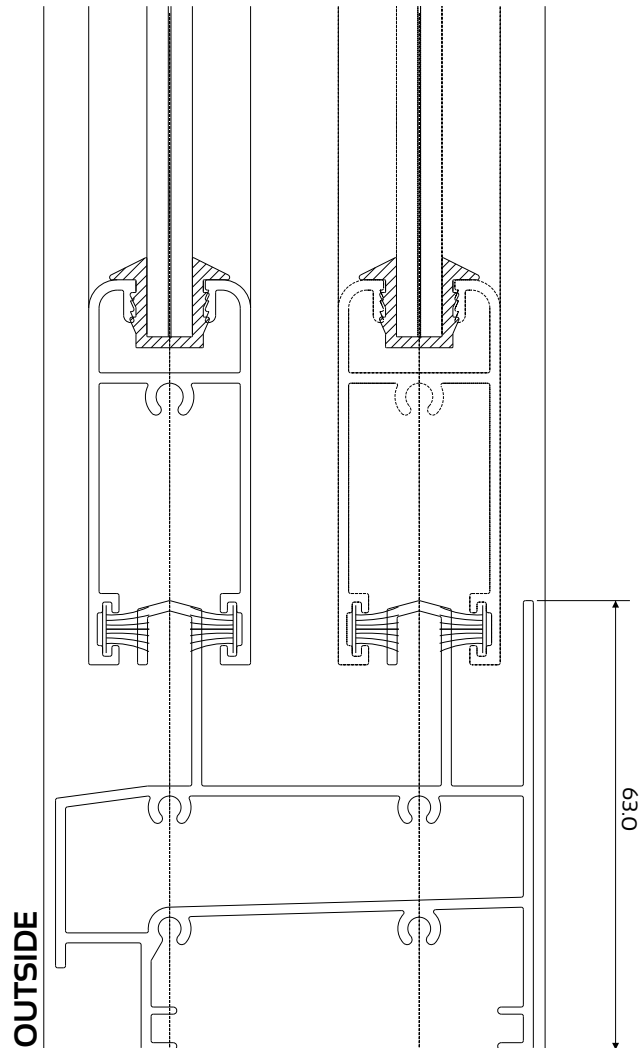

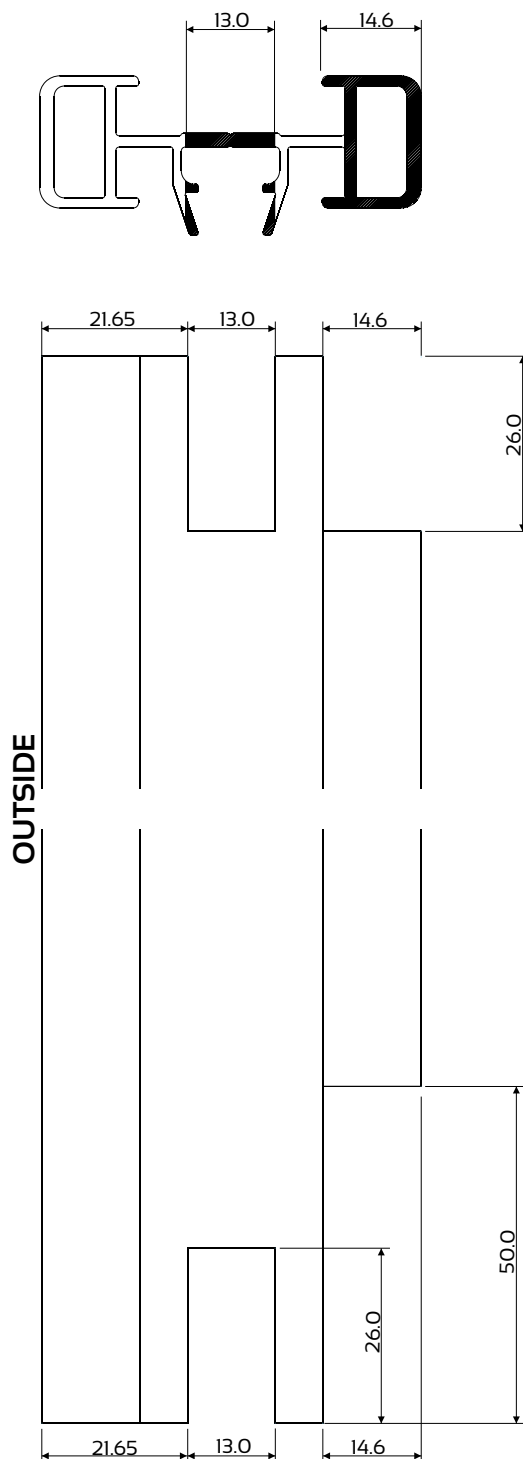

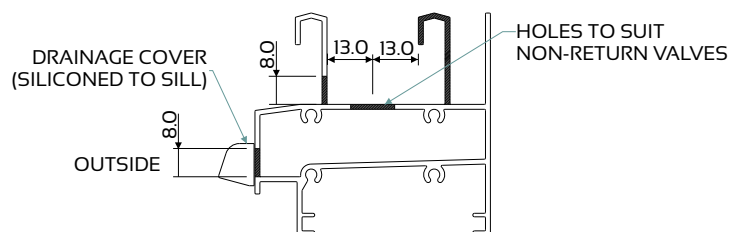
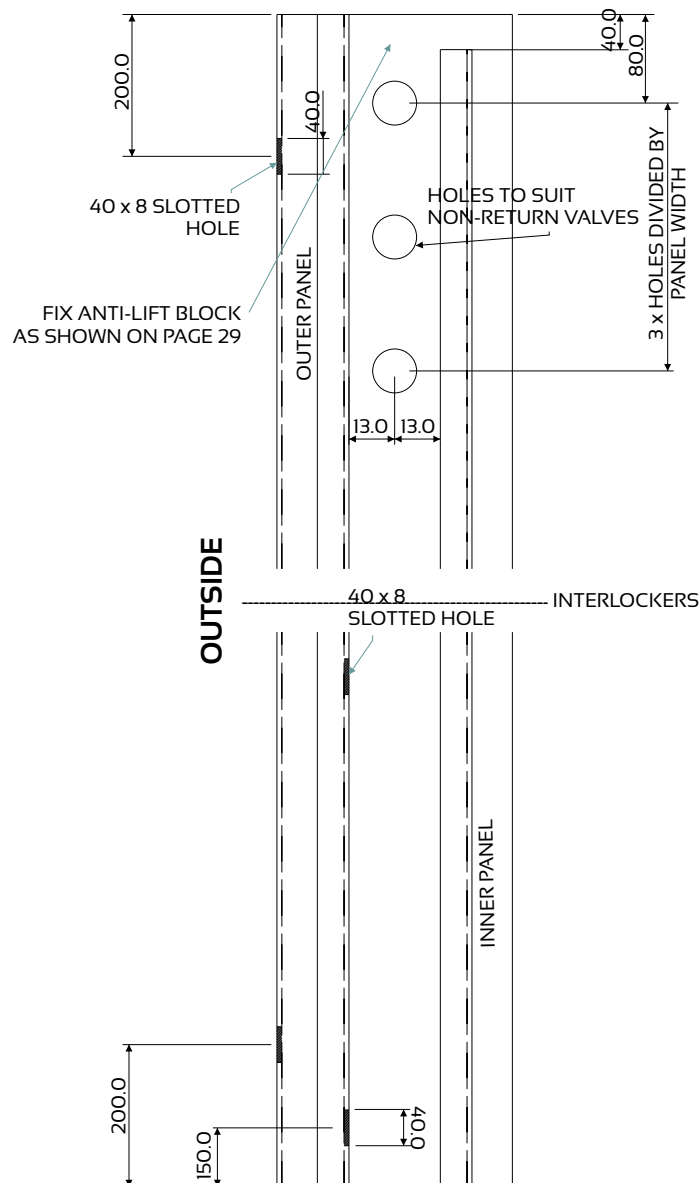

NOTE:
FOR SLIDING WINDOWS
OVER 1200mm WIDE,
3 x DRAINAGE COVERS TO BE ADDED

DRAINAGE FOR XX CONFIGURATION

This manual must be read in conjunction with the Installation, Cleaning & Maintenance Document and the Performance Certificates for the relevant system. The manual must also be used in conjunction with the design and cutting list from the latest version of StarFront.

Machining Detail

for Sill Drainage

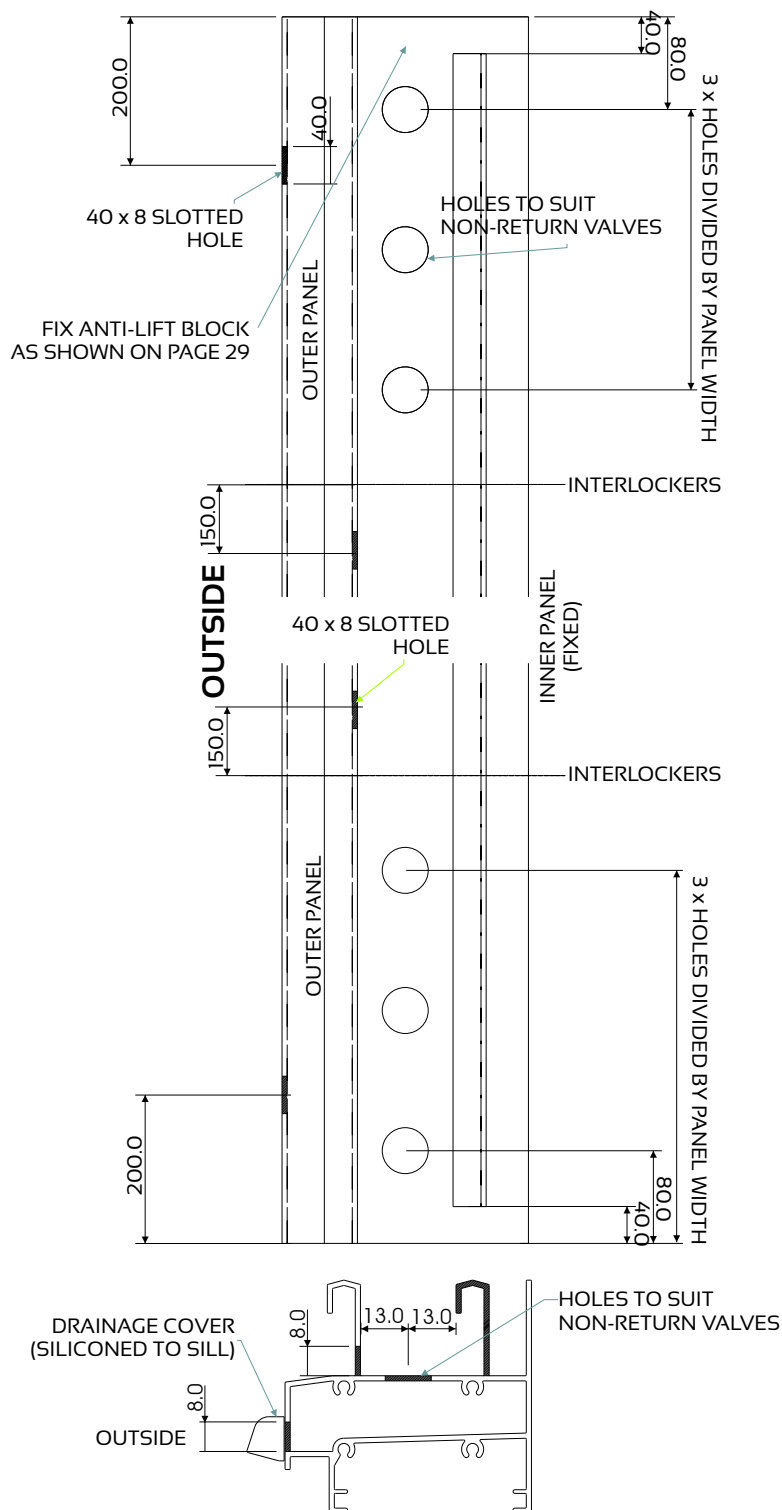

NOTE:
FOR SLIDING WINDOWS
OVER 1200mm WIDE,
3 x DRAINAGE COVERS TO BE ADDED

DRAINAGE FOR XOX CONFIGURATION

This manual must be read in conjunction with the Installation, Cleaning & Maintenance Document and the Performance Certificates for the relevant system. The manual must also be used in conjunction with the design and cutting list from the latest version of StarFront.

Machining Detail

for Sill Drainage

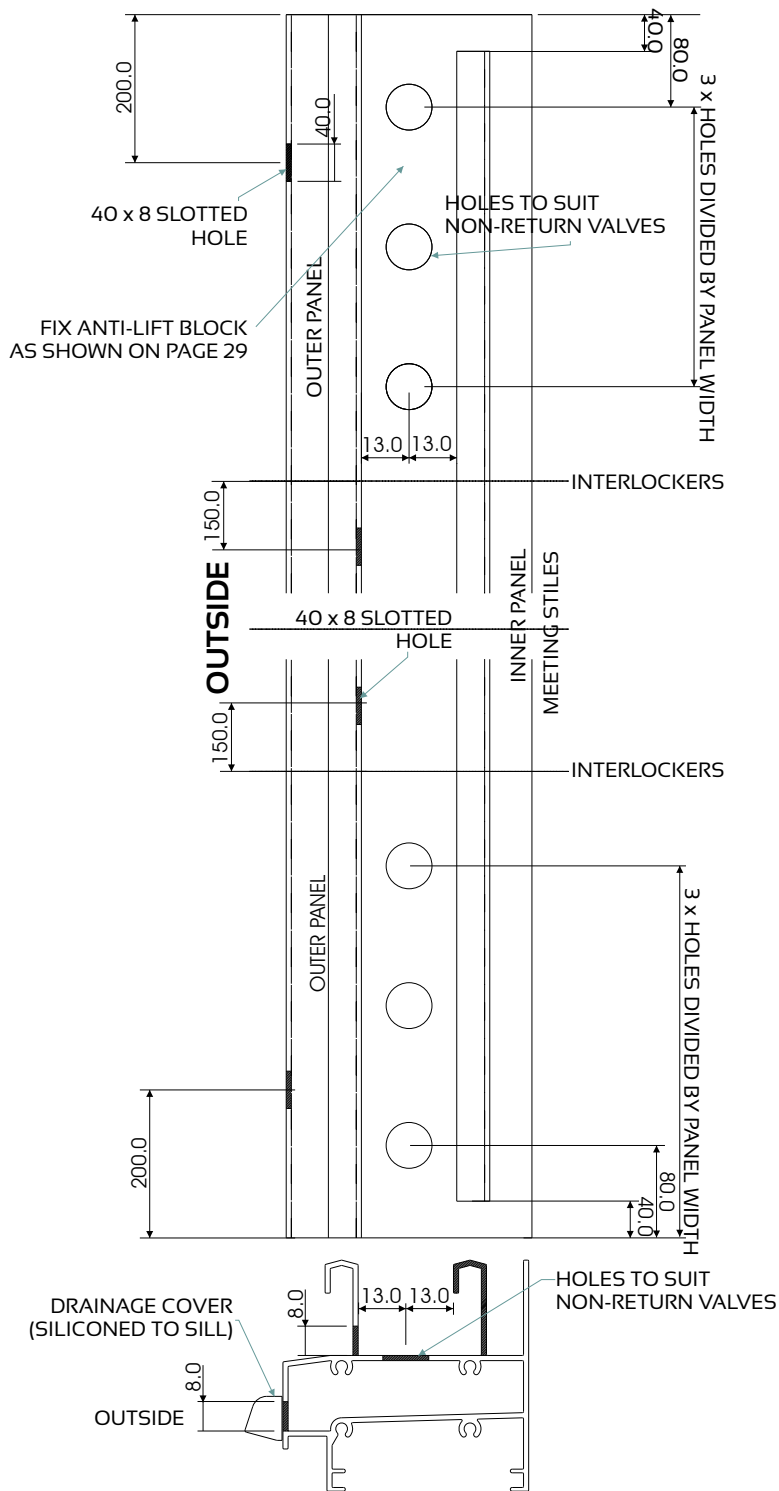

NOTE:
FOR SLIDING WINDOWS
OVER 1200mm WIDE,
3 x DRAINAGE COVERS TO BE ADDED

DRAINAGE FOR OXXO CONFIGURATION

This manual must be read in conjunction with the Installation, Cleaning & Maintenance Document and the Performance Certificates for the relevant system. The manual must also be used in conjunction with the design and cutting list from the latest version of StarFront.

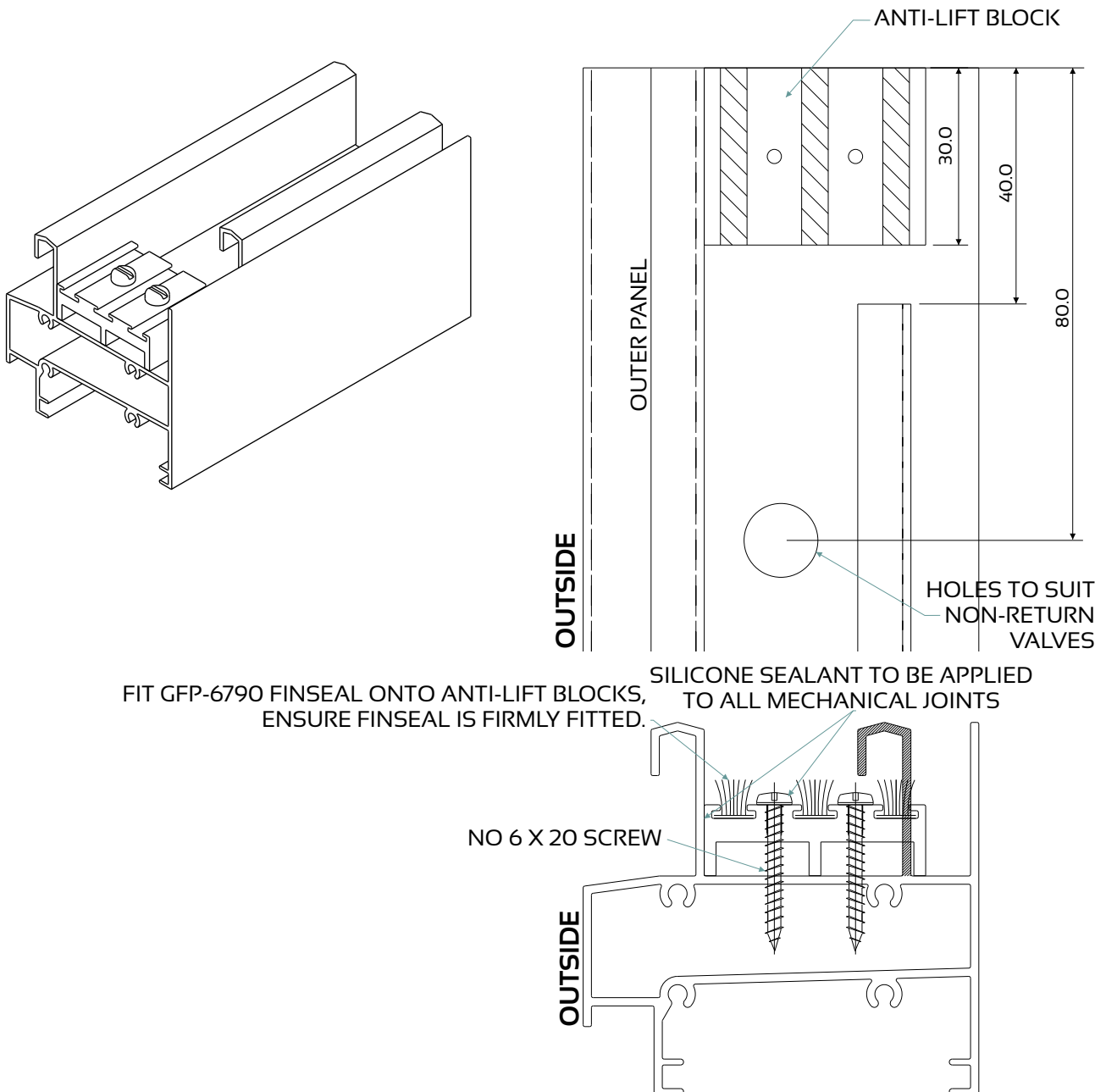

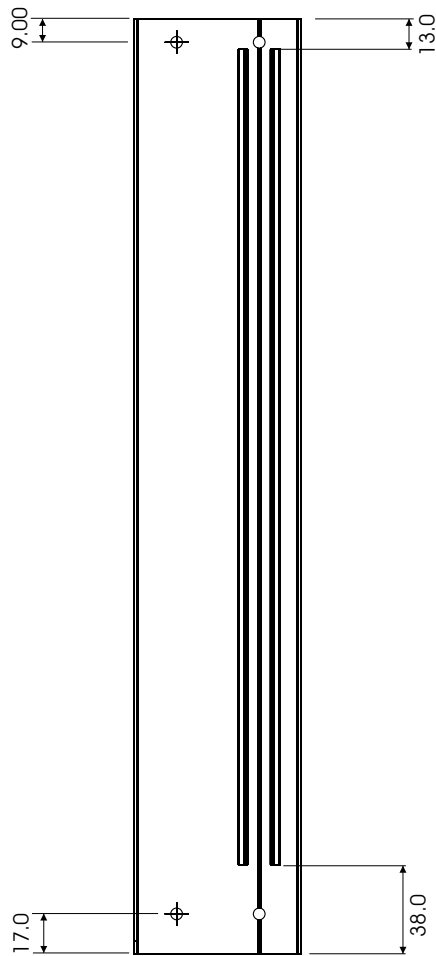

TOP VIEW

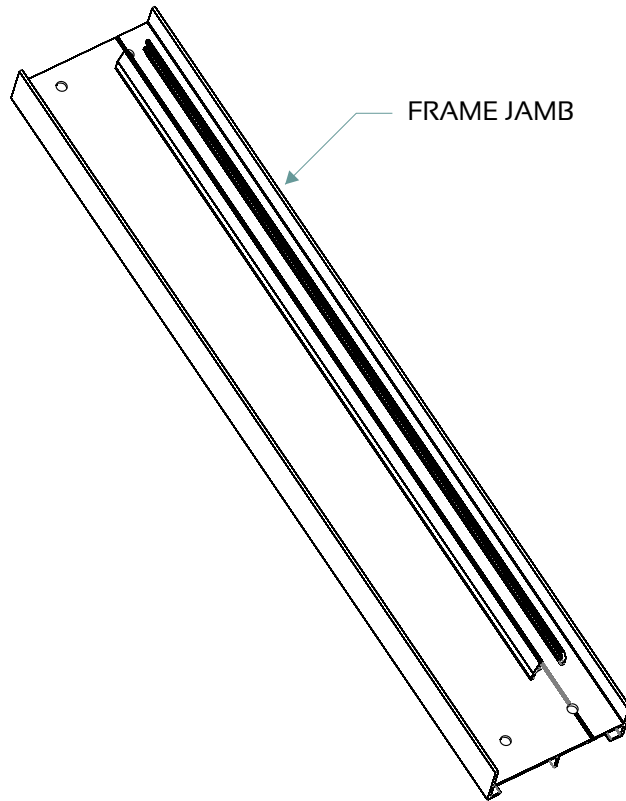

N.B:
A NEUTRAL SEALANT SHOULD BE
APPLIED TO THE PROFILE ENDS
OF THE SILL AND HEAD RAILS
ON ASSEMBLY TO PROVIDE A
GOOD SEAL ON THE OUTER
FRAME BUTT JOINTS.
(ENSURE THAT SEALANT USED IS
NON-CORROSIVE)

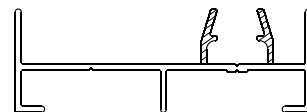

SECTION VIEW

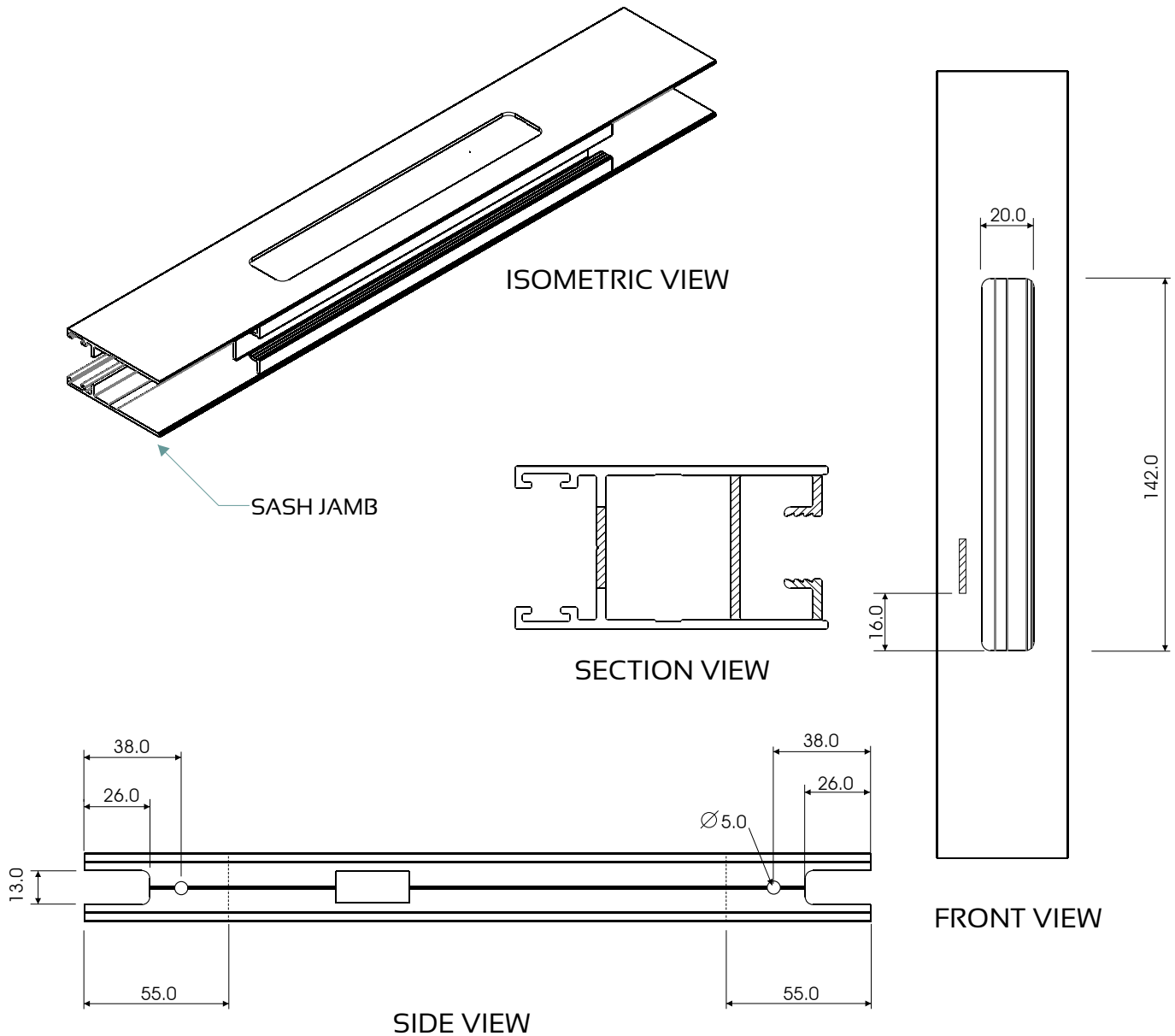

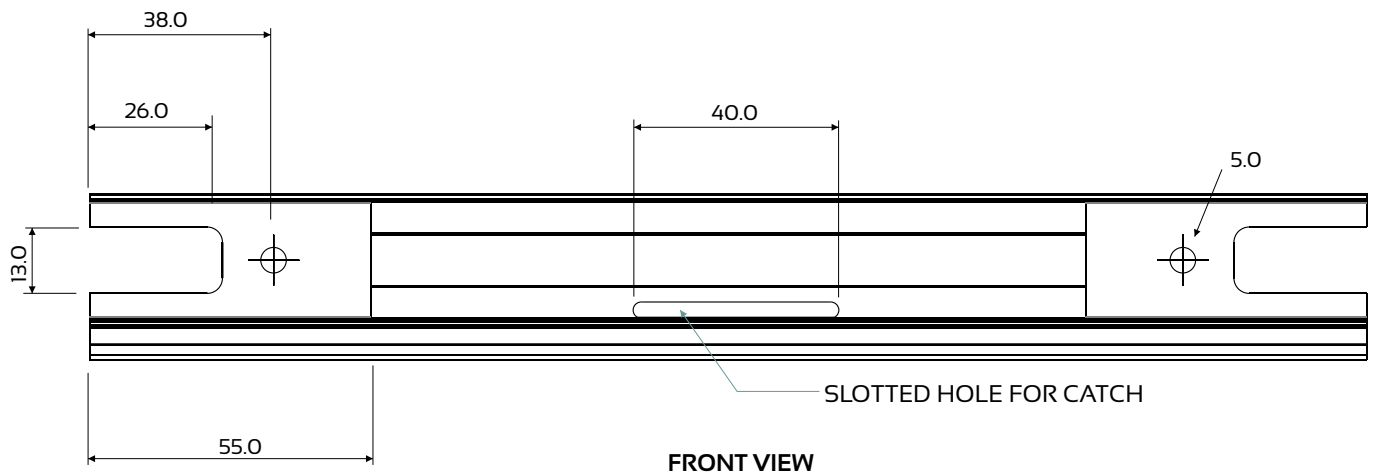
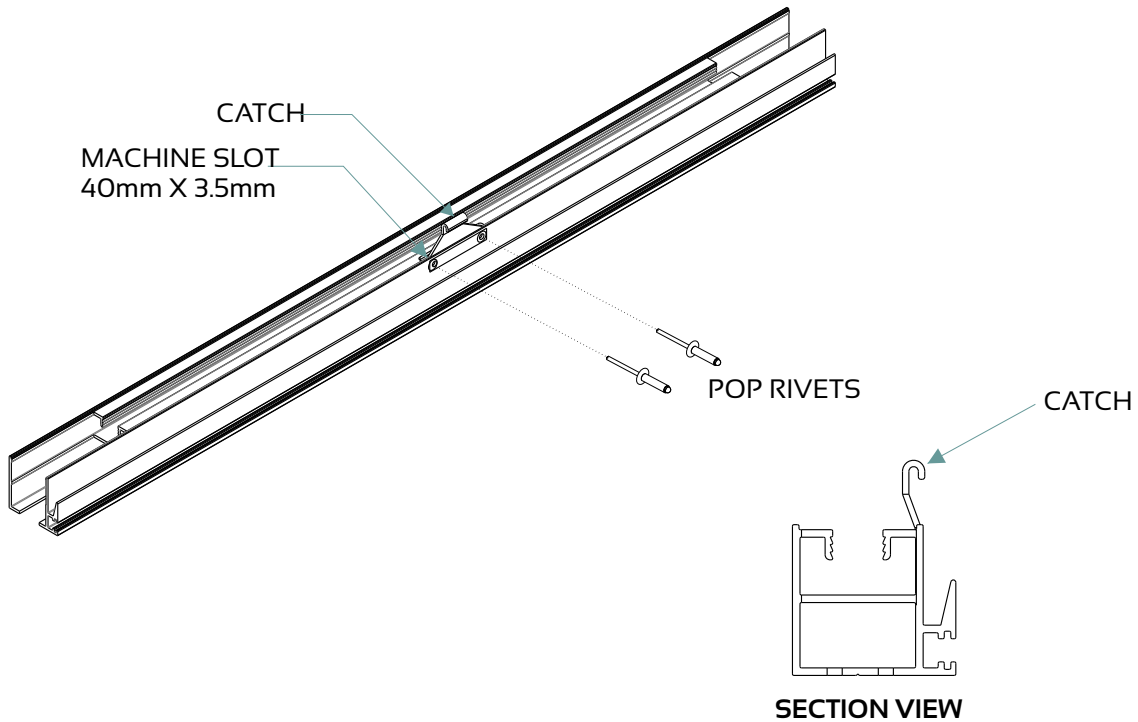

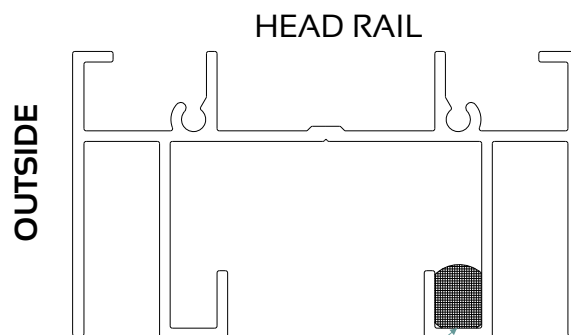

FIT DIA. 12mm POLYCORD (FROM SONDOR) OR EQUIVALENT
(ABOUT 100mm LONG)
TO CENTRE OF FRAME SILL & HEAD RAIL AS SHOWN
OR AT POSITION OF INTERLOCKERS

FIT DIA. 12mm POLYCORD (FROM SONDOR) OR EQUIVALENT
(ABOUT 100mm LONG)
TO CENTRE OF FRAME SILL & HEAD RAIL AS SHOWN
OR AT POSITION OF INTERLOCKERS

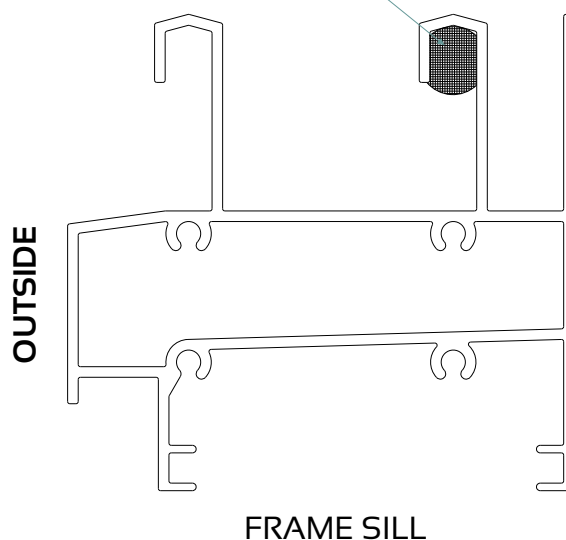

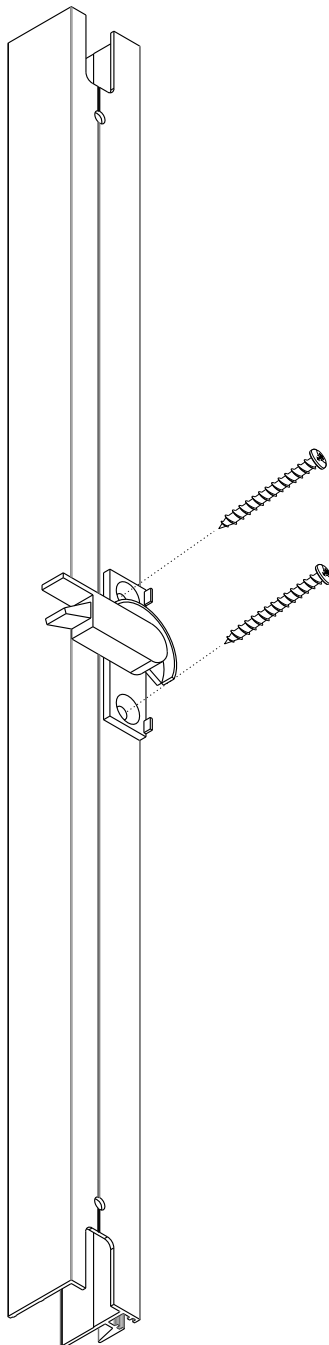

Note : Woolpile must be added to the anti-lift profile before fitting.

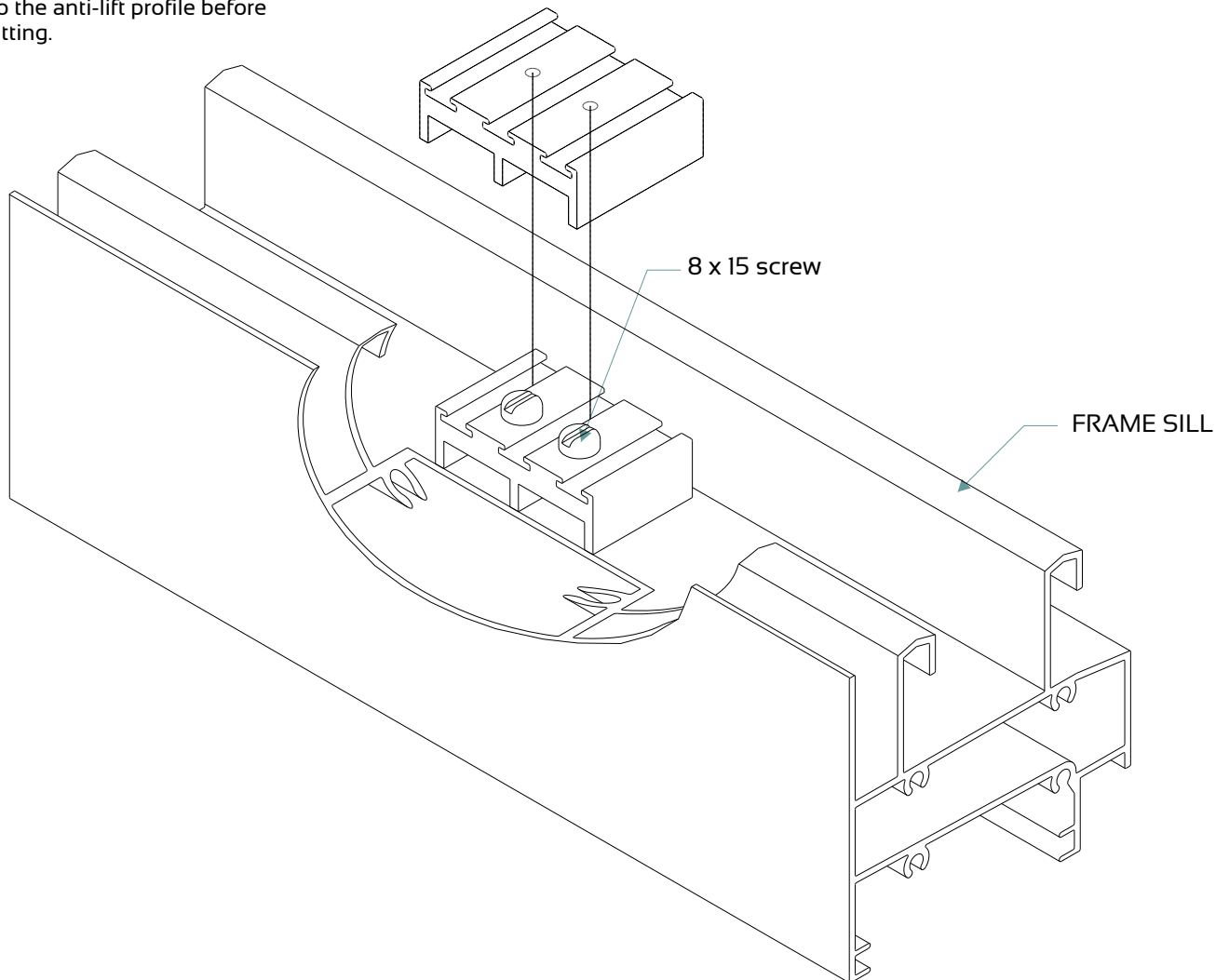

Note : Anti-lift profile must be fitted to both the head and the sill directly above the interlocks when the window is in the closed position.

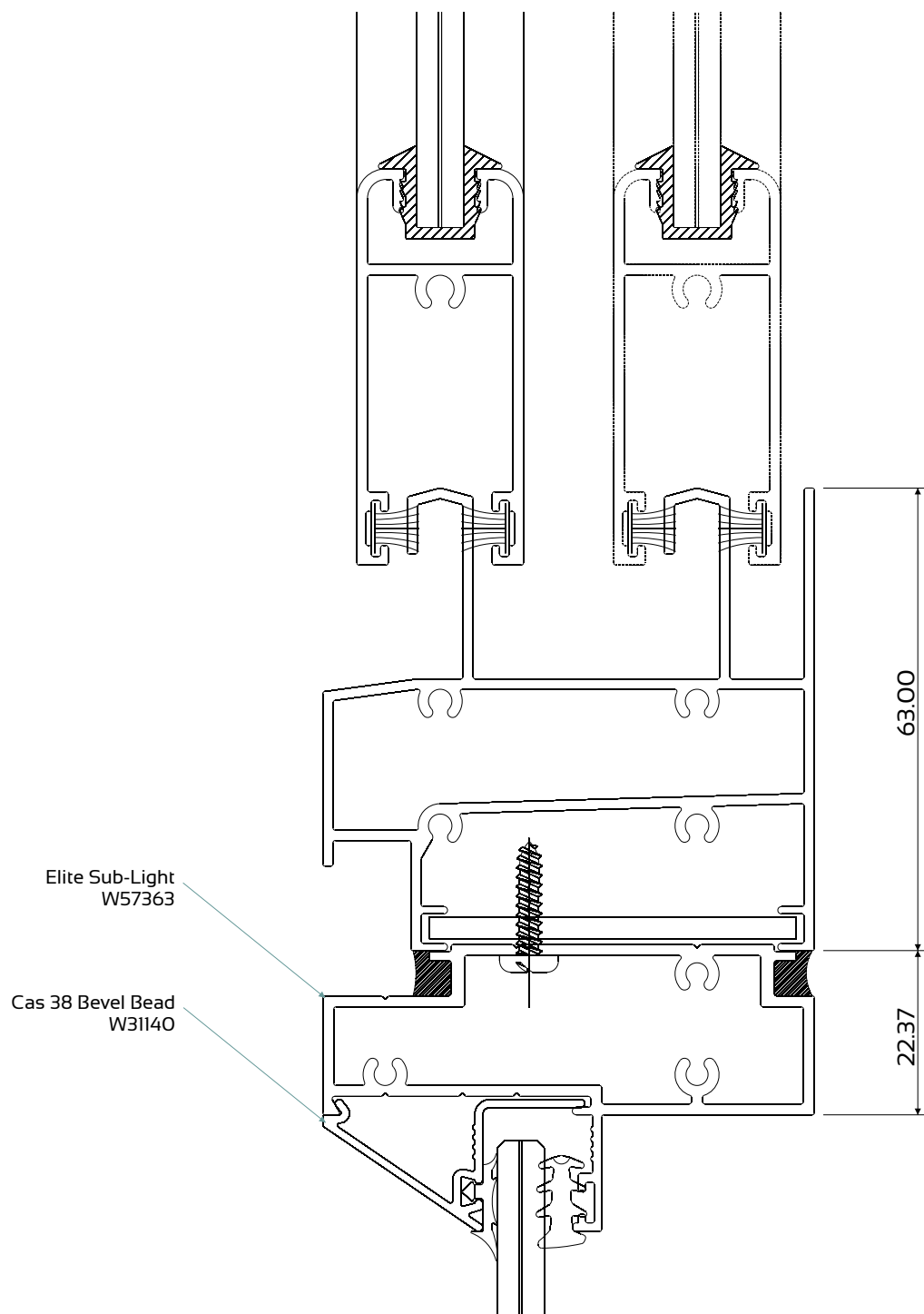

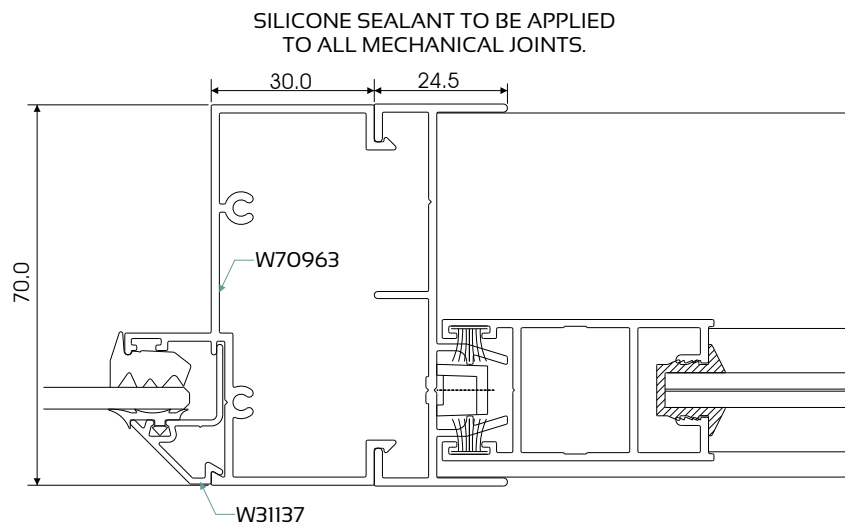

SIDELIGHT COMBO FOR CASEMENT 28

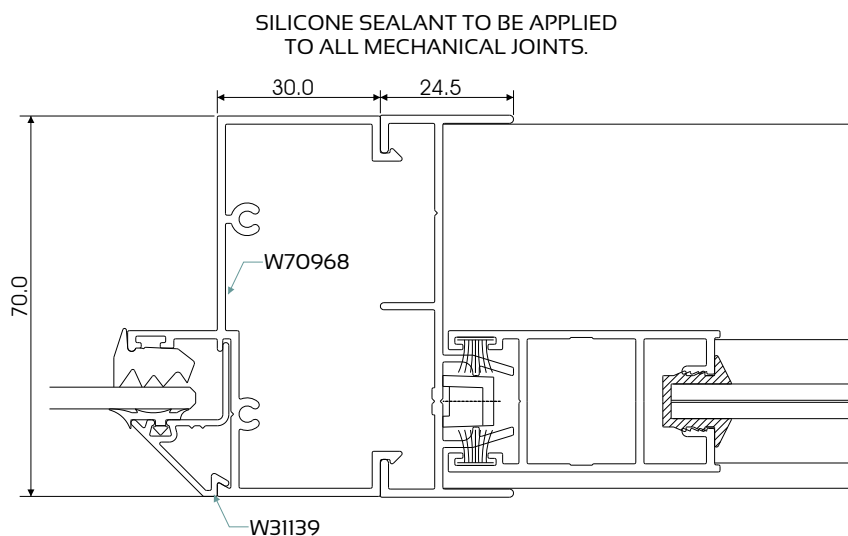

SIDELIGHT COMBO FOR CASEMENT 30.5

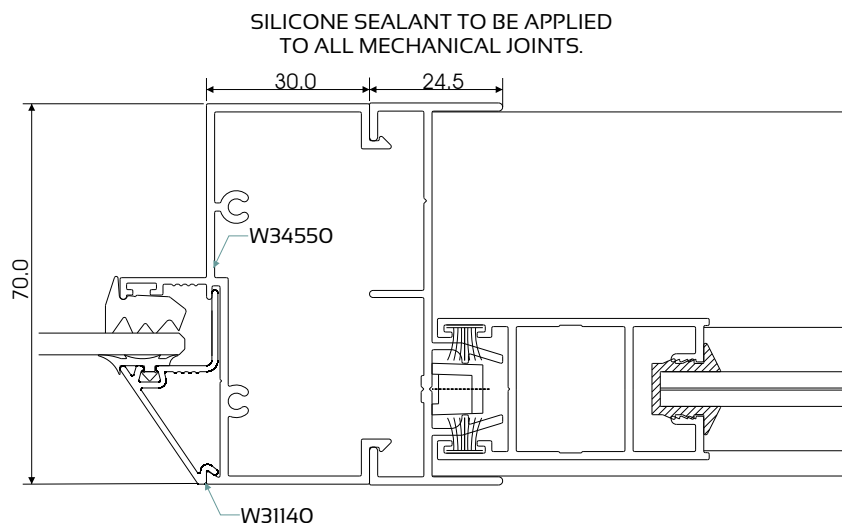

SIDELIGHT COMBO FOR CASEMENT 38

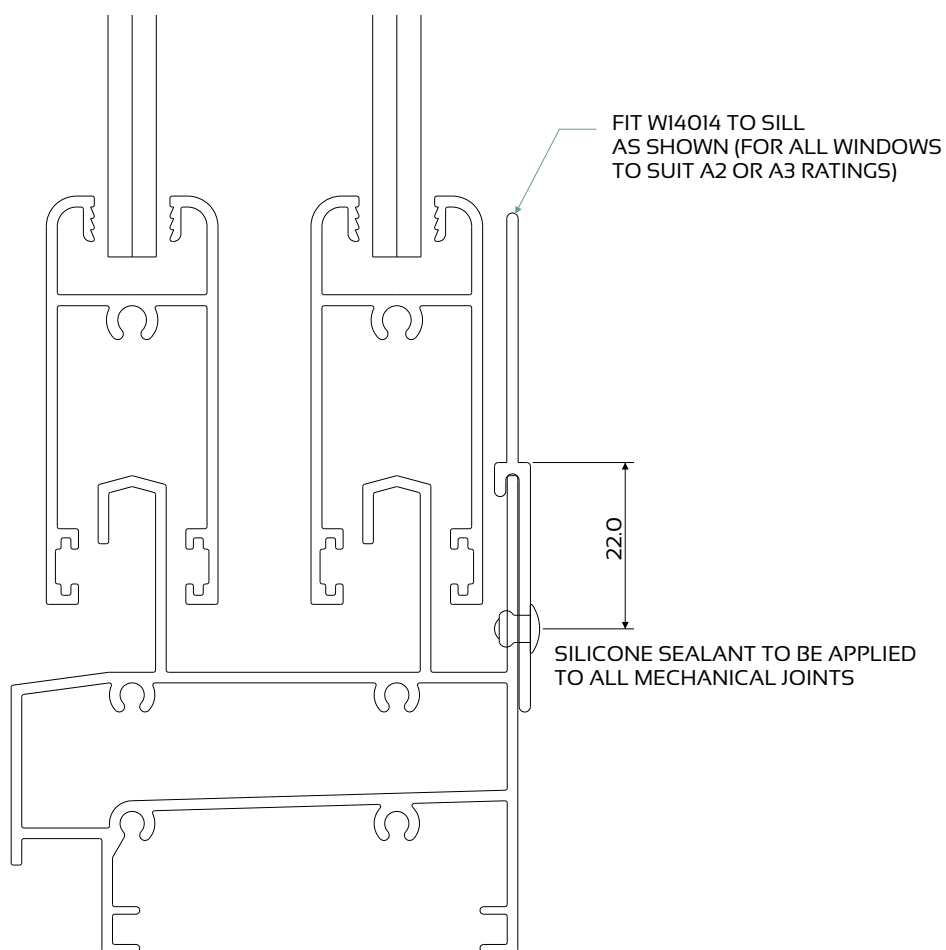

GLAZING

1. SELECTION OF GLAZING METHODS

1.1 SETTING AND LOCATION BLOCKS

Glass-to-metal contact must be avoided at all times by using setting and location blocks having a hardness of 50° to 90° shore A durometer. Use only blocks made of Neoprene, EPDM, Silicone or other elastomeric material.

Setting blocks are to have a minimum thickness of 3mm and must be at least 27mm in length per square metre of glass area.

The position of the setting and location blocks is illustrated in Figure 2.

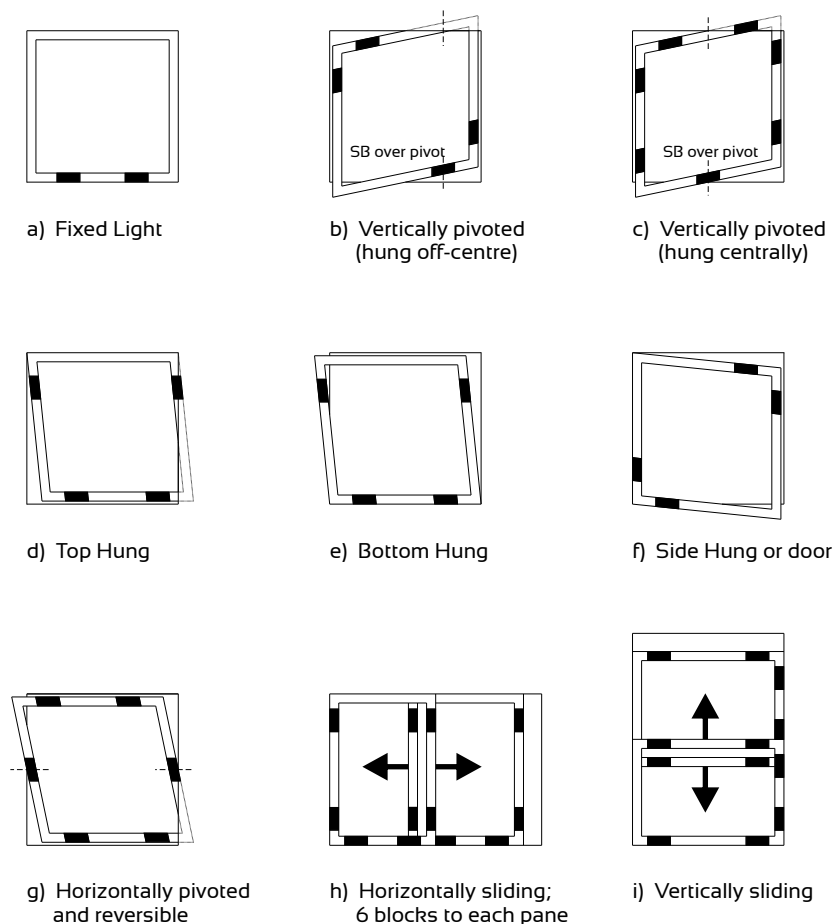

FIGURE 2 - POSITION OF SETTING AND LOCATION BLOCKS