

DUSK
INSECT SCREEN FOR WINDOWS

General Documentation Disclaimer

This manual is intended as a manufacturing and installation advisory document. For correct specifications, sizing of profiles and structural information please consult the StarFront Application. If the information you require is not available through the StarFront Application, please contact a Wispeco Technical Representative before proceeding. It is advisable to have all sizing and performance criteria checked by a qualified structural engineer to ensure that all performance and compliance will be met.

All information, recommendations or advice contained in this documentation is given in good faith to the best of Wispeco's knowledge and is based on current procedures in effect.

Since the actual use of this documentation by the user is beyond the control of Wispeco, such use is within the exclusive responsibility of the user. Wispeco cannot be held responsible for any loss incurred through incorrect or faulty use of this documentation. Training of Wispeco systems is important for ensuring correct procedures in the manufacturing of products.

Great care has been taken to ensure that the information provided is correct.

Ensure that you have the latest available manual. The revision number and date can be checked on the latest StarFront version.

Wispeco will accept no responsibility for any errors and/or omissions, which may have inadvertently occurred.

This Guide may be reproduced in whole or in part in any form or by any means provided the reproduction or transmission acknowledges the origin, revision number and copyright date.

Specifications concerning products and applications

This manual is based on standard configurations only. As there are many configurations not covered in this manual, contact a Wispeco Technical Consultant with regard to a configuration not represented herein.

AutoDesk drawings (CAD Symbol Library) are available on request and can be issued with the consent of the Wispeco Technical Department.

All mechanical joints must be sealed with Crealco Silicon. Failure to correctly seal the joints can affect the performance of the system. Information on joint sealing can be found in the Cleaning & Maintenance Manual available for download from the Wispeco website.

All drawings in the Wispeco Documentation are shown NOT to scale are used for illustrative purposes only. For correct sizing and machining of system profiles refer to the Wispeco StarFront Application.

Wispeco cannot accept responsibility for the use of standard products since Wispeco does not know where these products are being installed.

The hardware recommended in this documentation is suitable for use in most atmospheric environments. When hardware is used in severe coastal environments the manufacturer of the hardware must be consulted.

The use of non-specified hardware or incorrect mechanical fasteners can adversely affect the mechanical and weathering performance of the system and we strongly advise against deviations. A Wispeco Consultant can advise you of any hardware issues and limitations with regard to this system.

The use of anti-magnetic stainless steel screws and aluminium pop rivets is recommended to reduce galvanic corrosion in harsh environments.

Fixing lugs on frames must be positioned as per the user manual and used in accordance to the AAMSA specifications. When profiles are screwed together the screw centers must also be according to the user manual or as specified by an engineer.

All glass used within Wispeco products must comply with SAGGA regulations. Laminated glass must not stand in water.

By continuing to use this documentation you acknowledge that you understand and accept the legal disclaimer.

This manual must be read in conjunction with the Installation, Cleaning & Maintenance Document and the Performance Certificates for the relevant system. The manual must also be used in conjunction with the design and cutting list from the latest version of StarFront.

Legal Disclaimer.....	i
Index.....	1

General System

Profile Identification.....	2
Hardware Components.....	3
Typical Configurations	4
Cross-Sectional Detail.....	
Vertical Slider.....	5
Horizontal Slider.....	6
Component Assembly Detail.....	
Outer Frame.....	7
Bottom Sash Sliding.....	8
Top Sash Fixed.....	9
Assembly Detail.....	10-11
Casement Window Fixing Detail.....	12-13
Outer Frame Machining Detail.....	
for Casement Fixing.....	14
for Final Frame Fixing - Step 4.....	15
Assembly Detail.....	
Outer Frame Corner Cleat.....	16
Sash Corner Cleat.....	17
Handle.....	18
Plastic Button.....	19

DUSK

INSECT SCREEN FOR WINDOWS



crealco

This manual must be read in conjunction with the Installation, Cleaning & Maintenance Document and the Performance Certificates for the relevant system. The manual must also be used in conjunction with the design and cutting list from the latest version of StarFront.

Profile Identification

Dusk Flyscreen Profiles

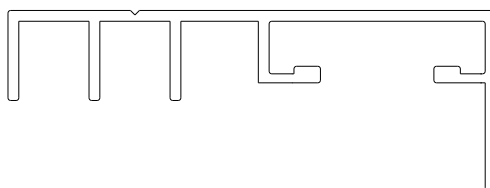

DIE No. W31069 Flyscreen
Outer Frame

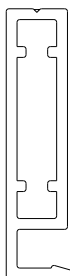

DIE No. W13484 Flyscreen
Sash

Hardware Components

RECOMMENDED DUSK FLYSCREEN COMPONENTS

All hardware is available through our Stockists as well as through Crealco Components, and can be viewed on www.crealco-components.com

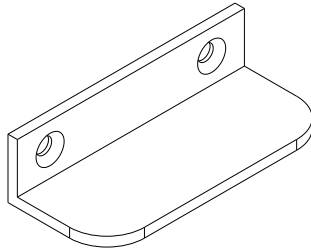

ISR-FSH

Dusk Handle

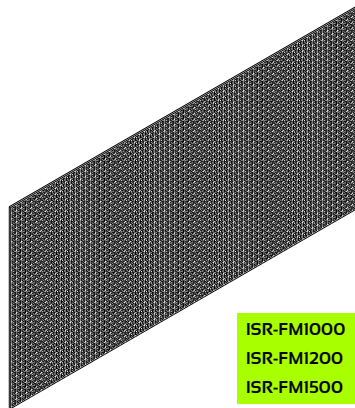

ISR-FMI000

ISR-FMI200

ISR-FMI500

Screen Mesh

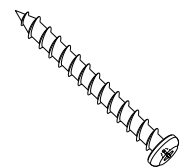

FSP-0830P-SS

8x30 P/Head POSI
S/S Screw



FSC-0809HBP

Handle Screw
Blunt Point



SGD-ARS

Plastic Button

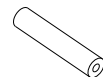

GSN-RS05

Dusk Flyscreen Spline

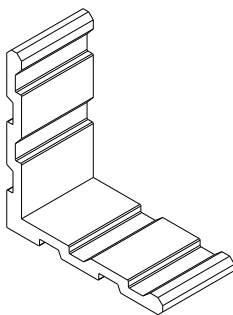

W52695

Dusk Corner Cleat

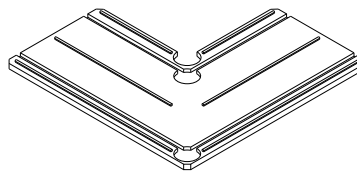

LGC-F54-PVC

Dusk Sash Corner Cleat

VERTICAL SLIDER

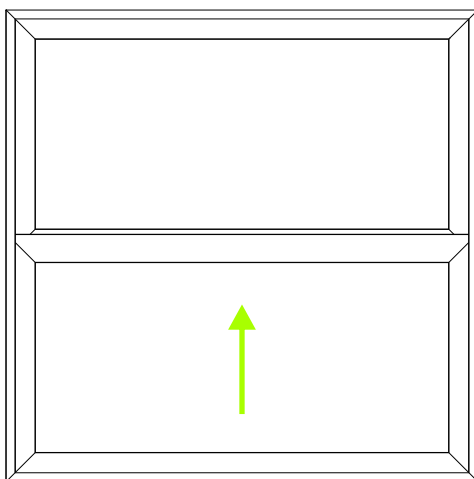

HORIZONTAL SLIDER

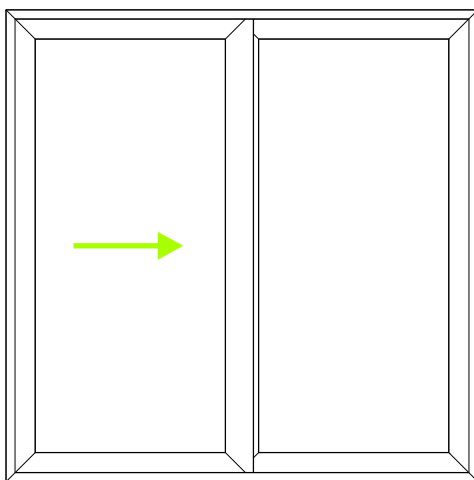

Cross-Sectional Detail

Vertical Slider

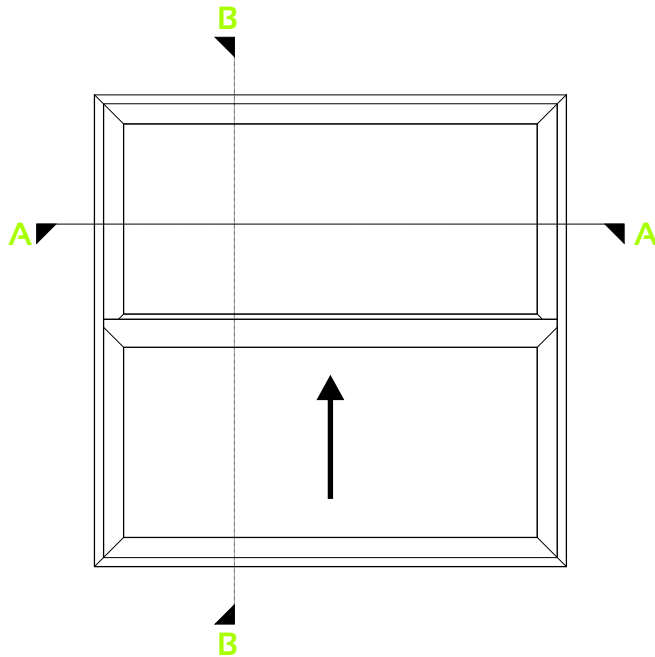

SECTION B-B
Section not to scale

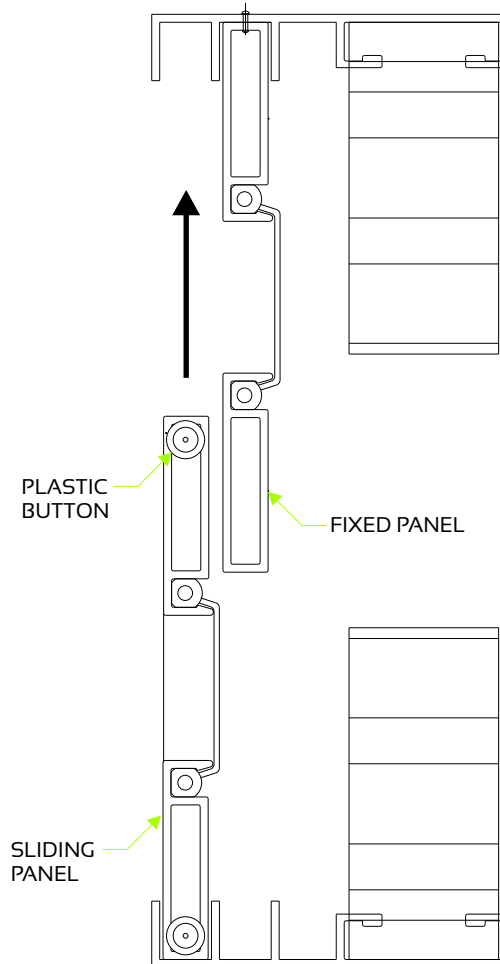

SECTION A - A
Section not to scale

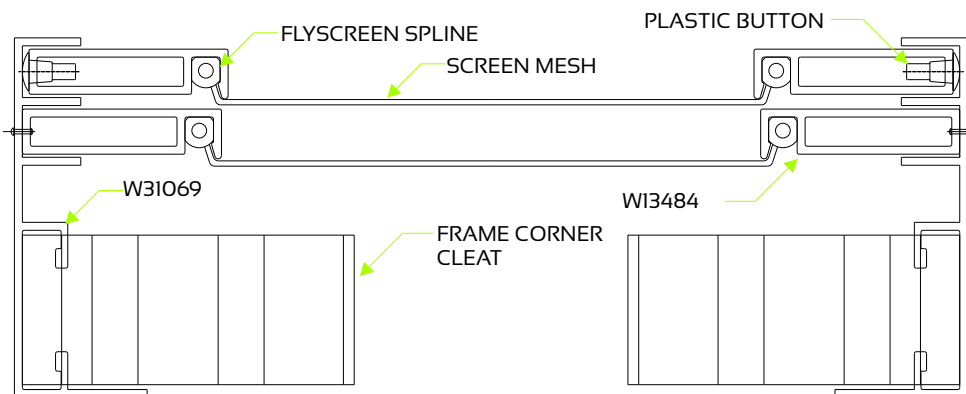

Cross-Sectional Detail

Horizontal Slider

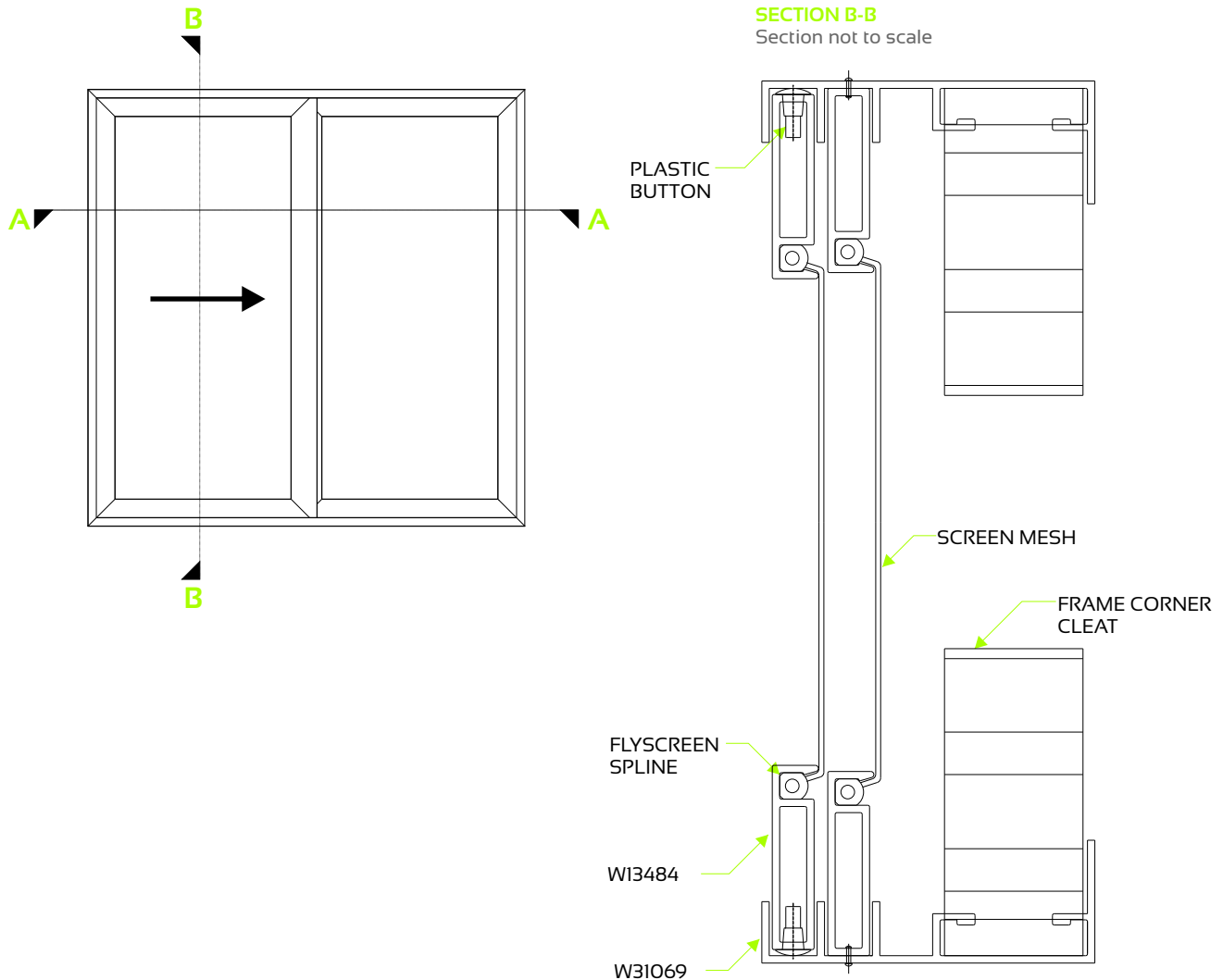

Component Assembly Detail

Outer Frame

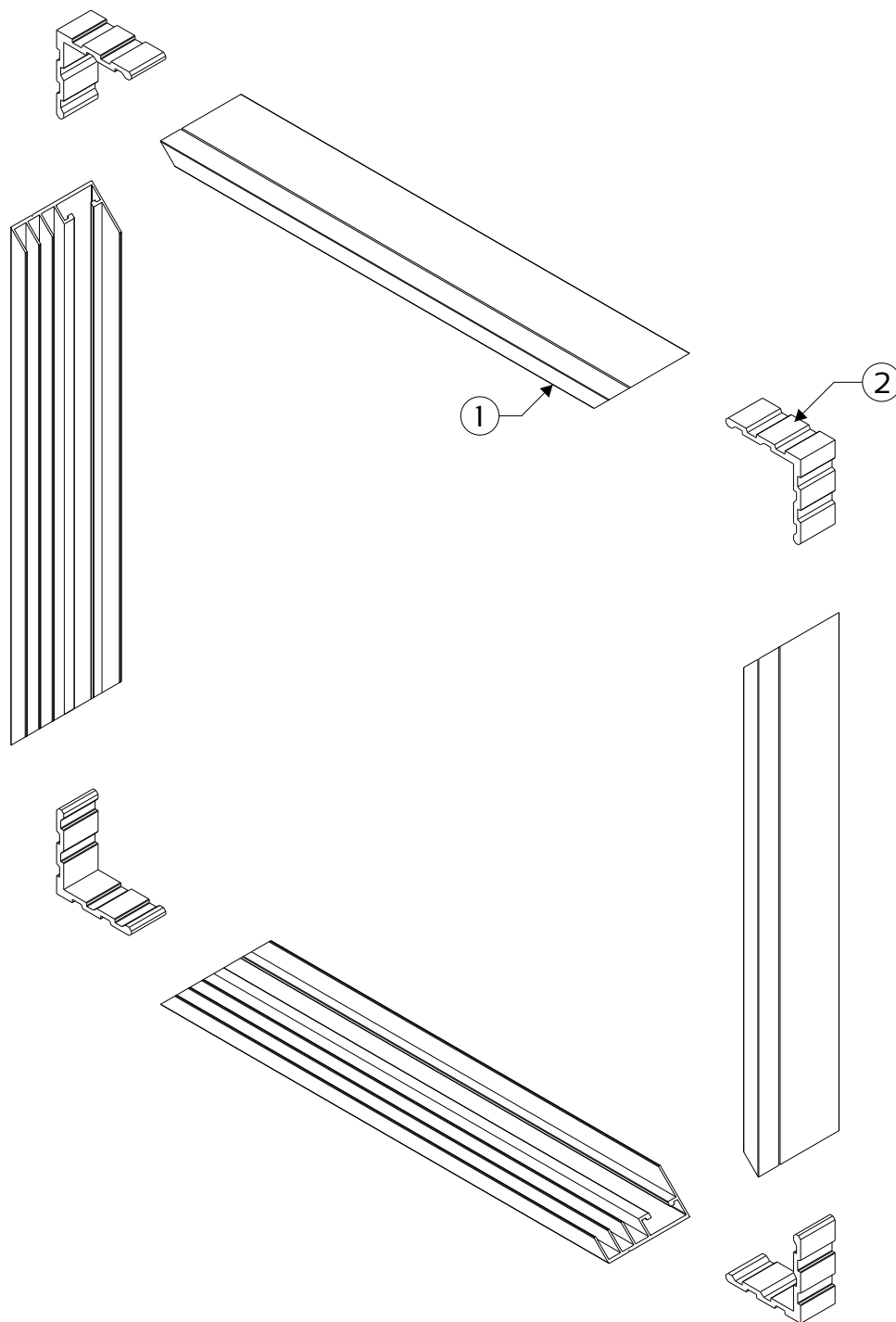

System Profiles

ITEM	QTY	DIE No.	DESCRIPTION
1	4	W31069	Outer Frame

Hardware

ITEM	QTY	COMPONENT DESCRIPTION
2	4	Frame Corner Cleat

Component Assembly Detail

Bottom Sash Sliding

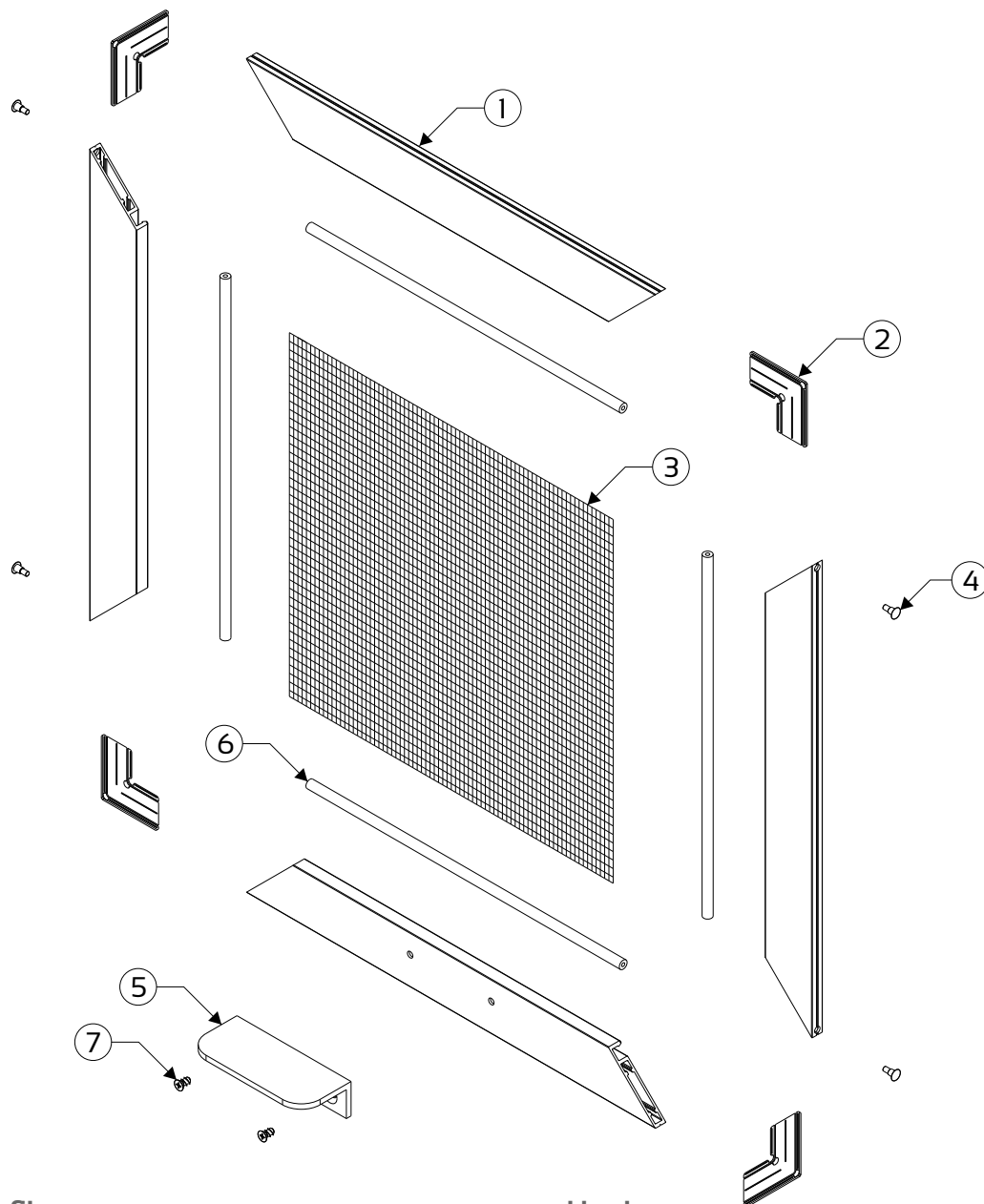

System Profiles

ITEM	QTY	DIE No.	DESCRIPTION
1	4	W13484	Sash

Hardware

ITEM	QTY	COMPONENT DESCRIPTION
2	4	Sash Corner Cleat
3	1	Screen Mesh
4	4	Plastic Button
5	1	Handle
6	4	Flyscreen Spline
7	2	Handle Screw Blunt Point

Component Assembly Detail

Top Sash Fixed

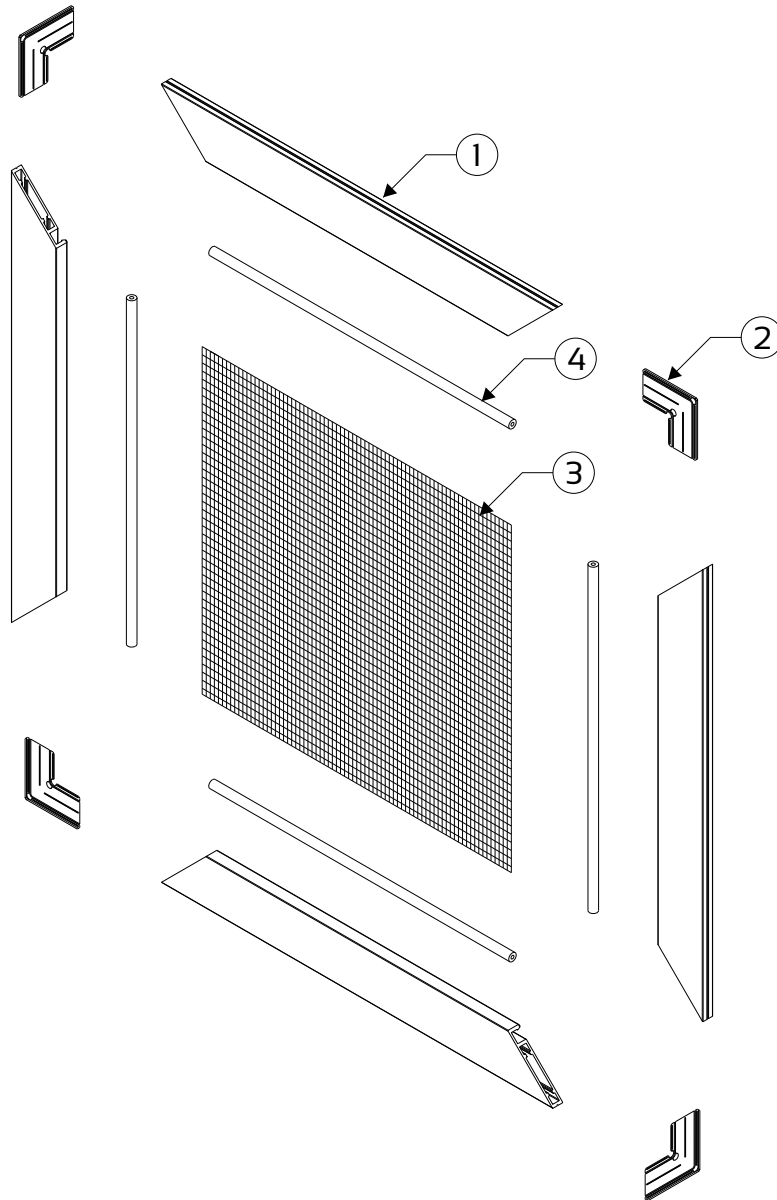

System Profiles

ITEM	QTY	DIE No.	DESCRIPTION
1	4	WI3484	Sash

Hardware

ITEM	QTY	COMPONENT DESCRIPTION
2	4	Sash Corner Cleat
3	1	Screen Mesh
4	4	Flyscreen Spline

STEP 1 - CRIMP OUTER FRAME CORNERS AS SHOWN

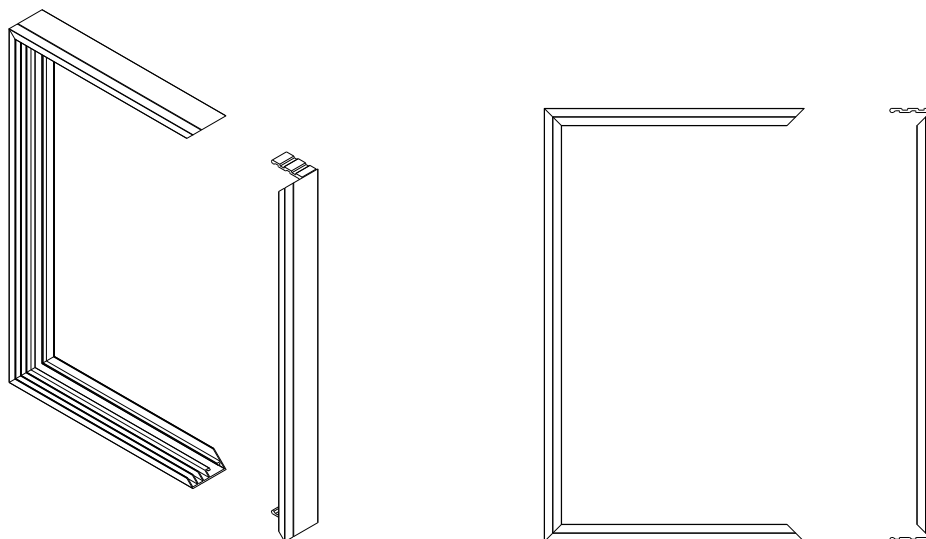

STEP 2 - FIX TOP SASH TO OUTER FRAME WITH SCREWS

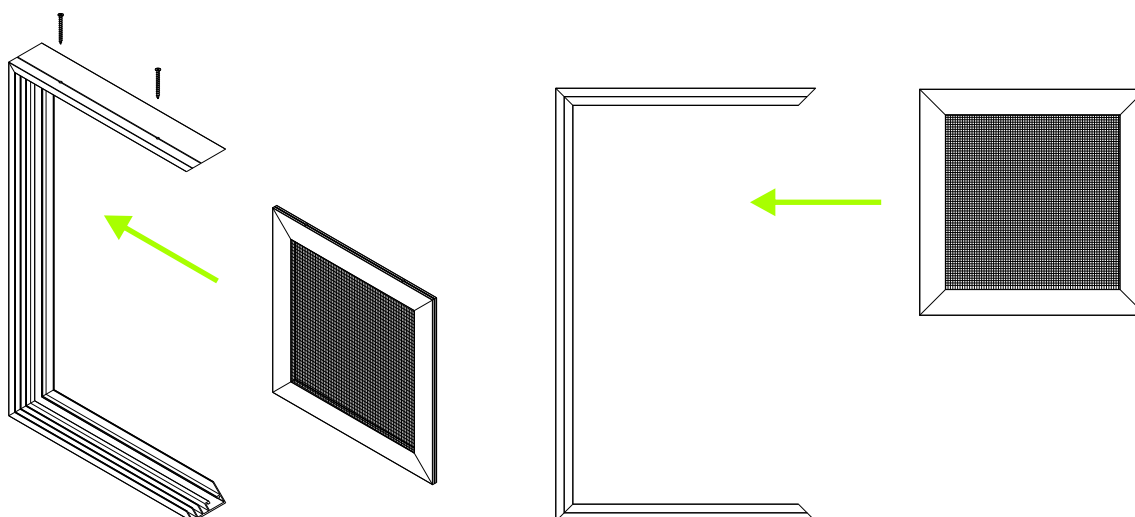

STEP 3 - SLIDE IN BOTTOM SASH

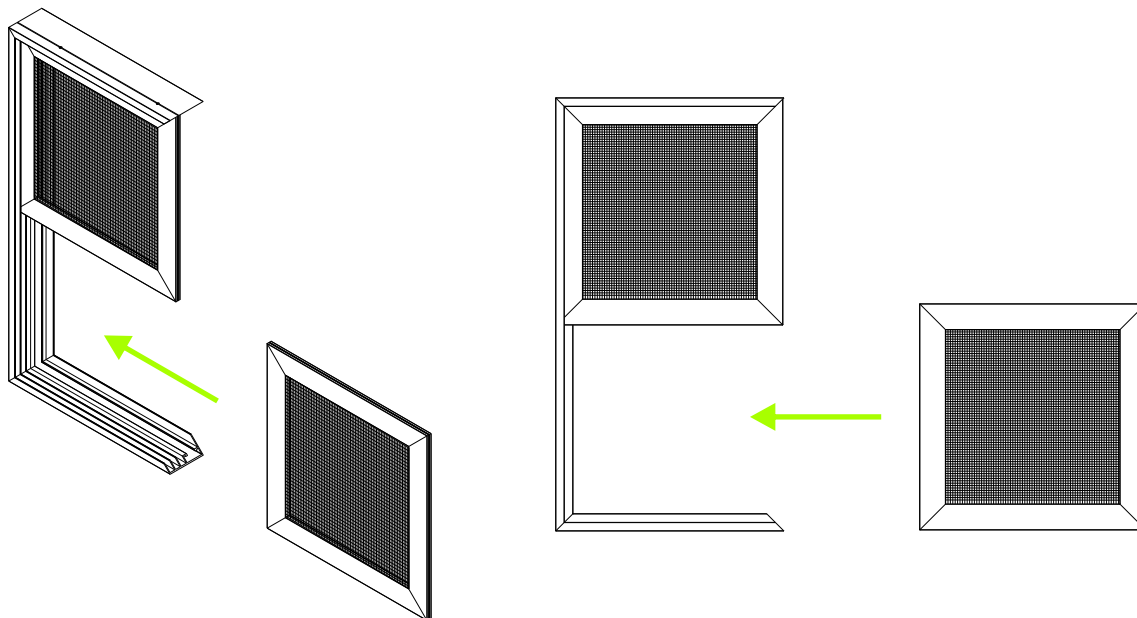

STEP 4 - FIX OUTER FRAME WITH SCREW

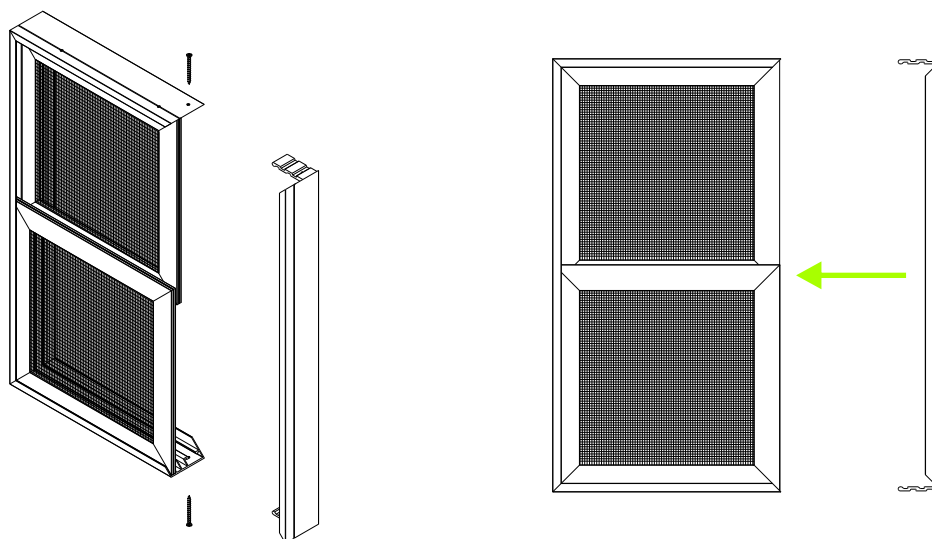

Casement Window Fixing Detail

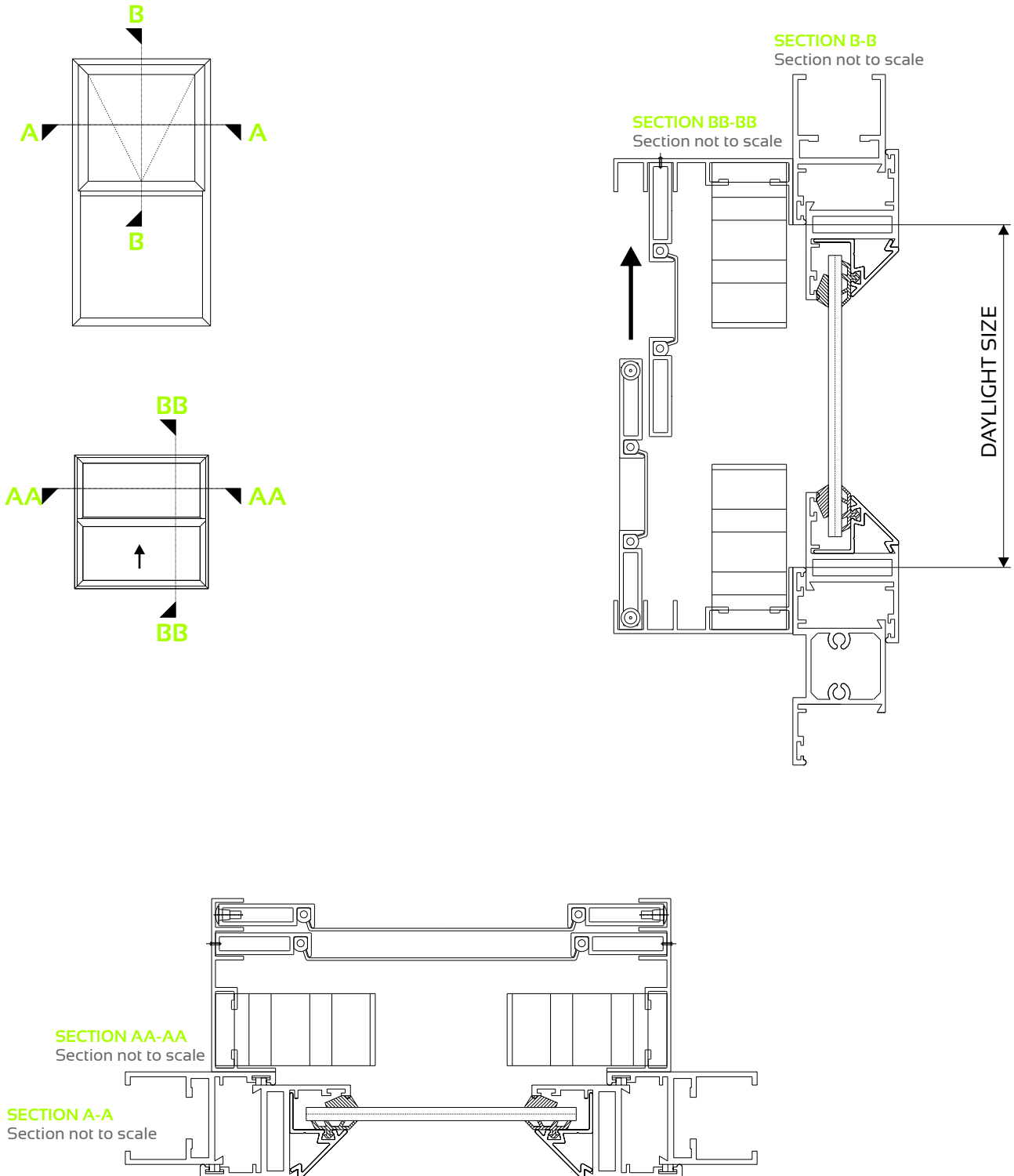

Casement Window Fixing Detail

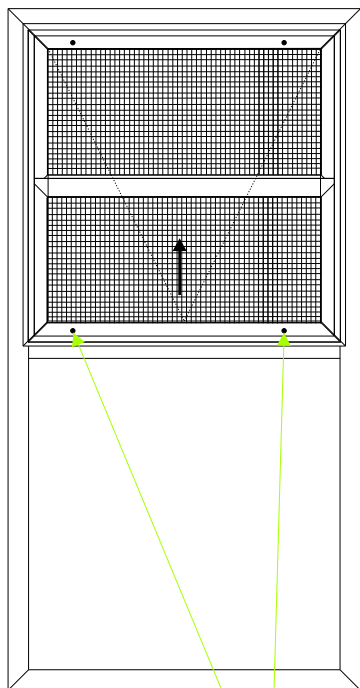

FIX WITH HANDLE SCREW
TO CASEMENT WINDOW

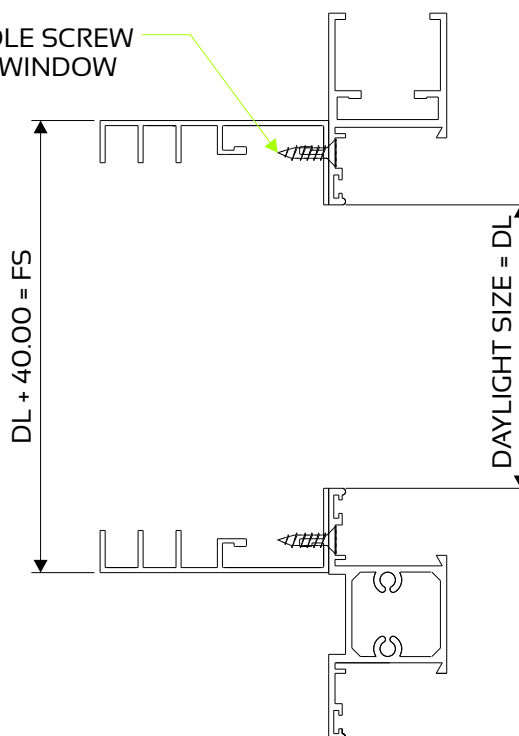

Outer Frame Machining Detail

For Casement Fixing

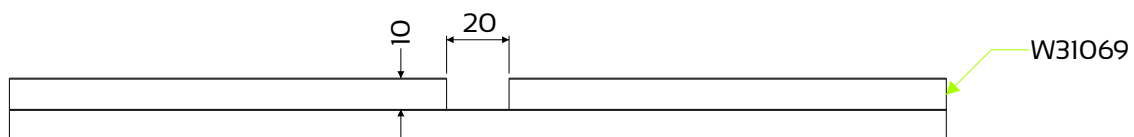
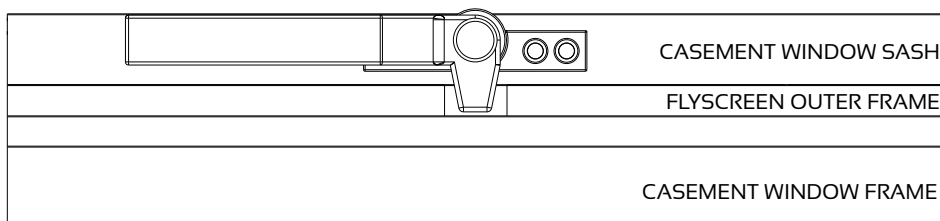
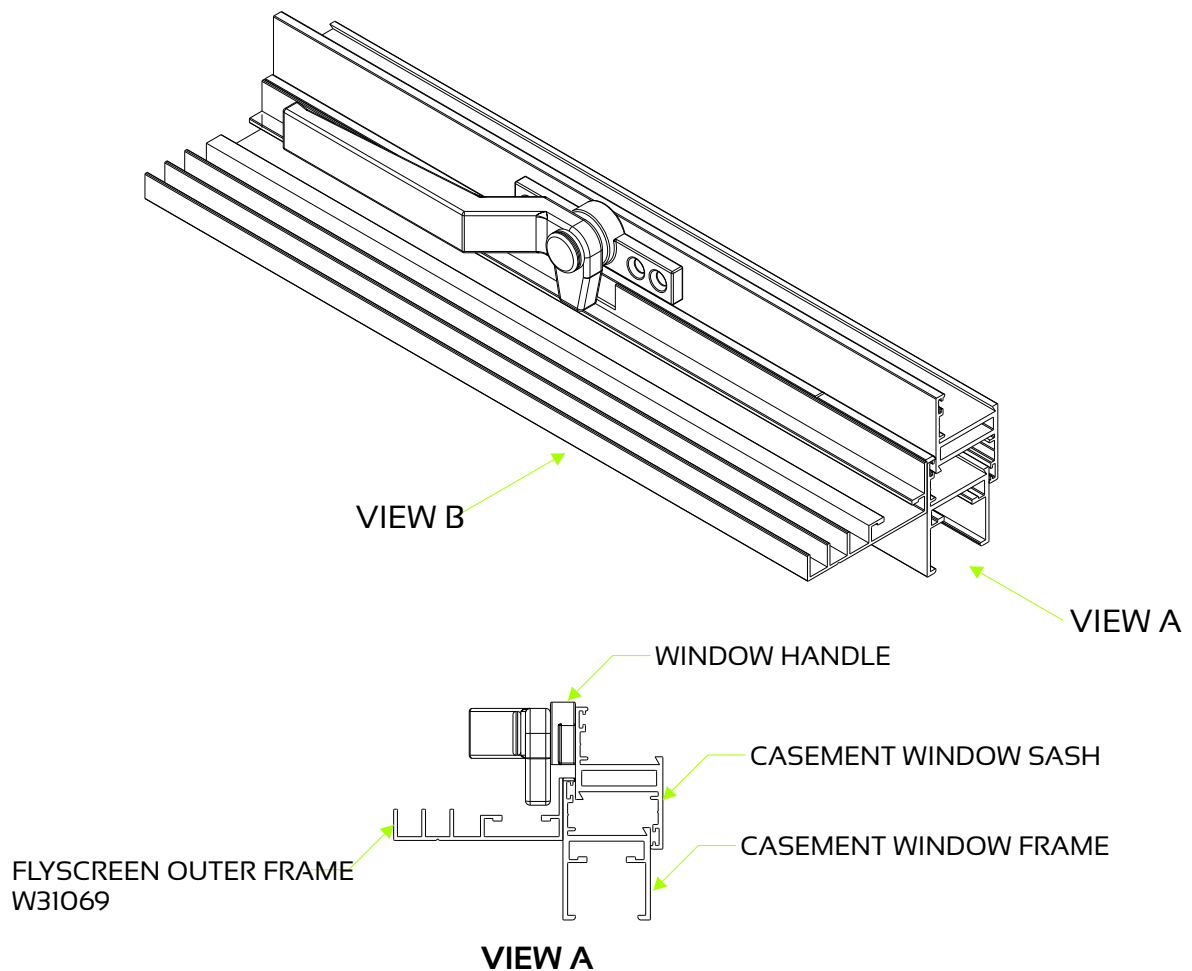

VIEW B

Outer Frame Machining Detail

For Final Frame Fixing-Step 4

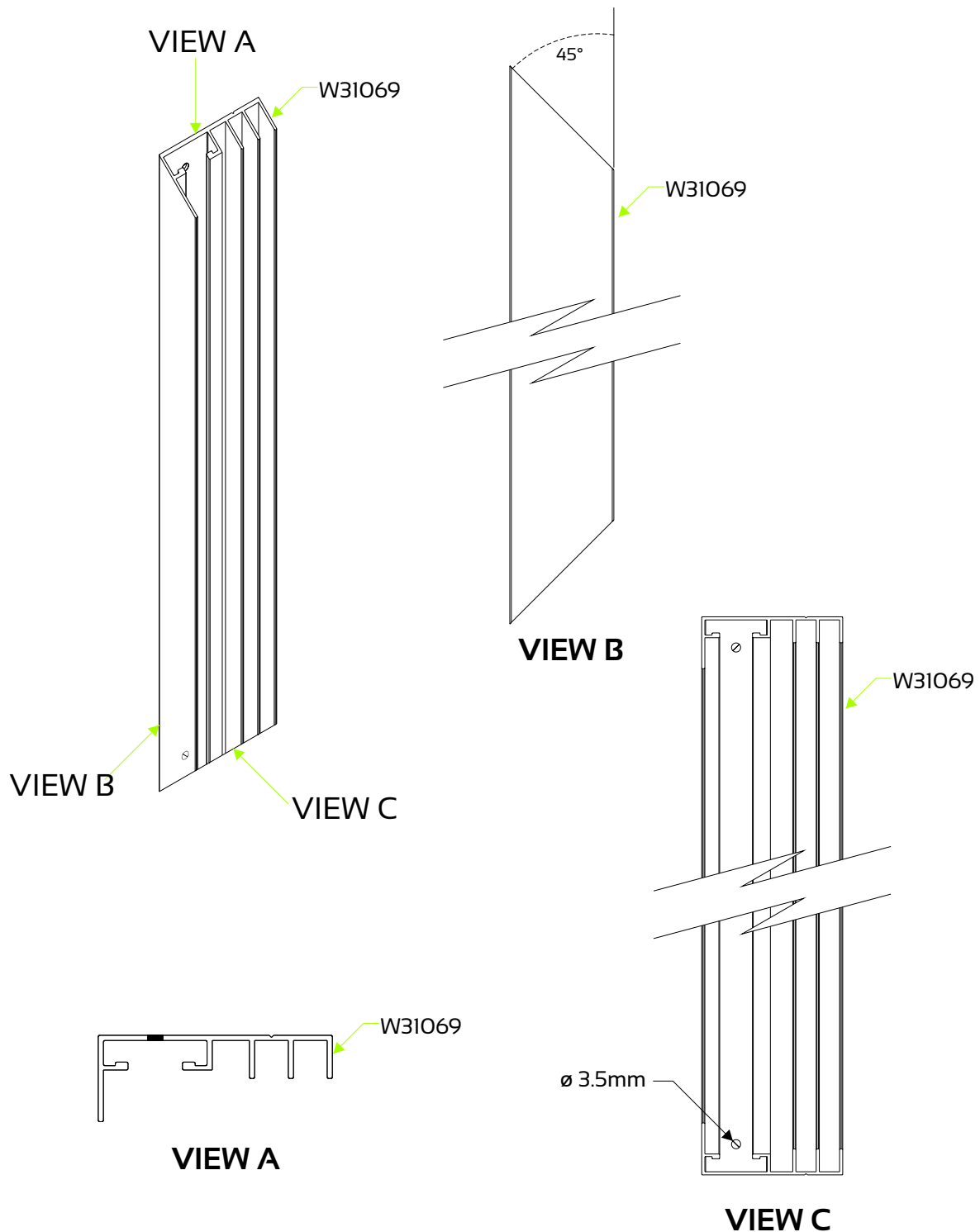

Assembly Detail

Outer Frame Corner Cleat

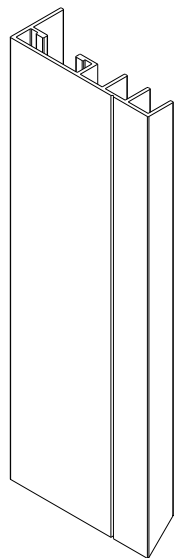

NOTE:
ALL JOINTS MUST BE SEALED WITH
SMALL JOINT SEALANT. FINPILE
MUST BE FITTED TO SASH AND
CORRESPONDING SURFACES OF
FRAME BEFORE CRIMPING (NOT
TO AREAS TO BE GLAZED)
AS IN STEP 1.

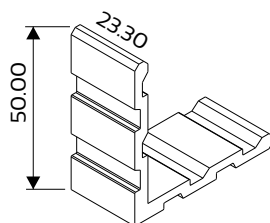
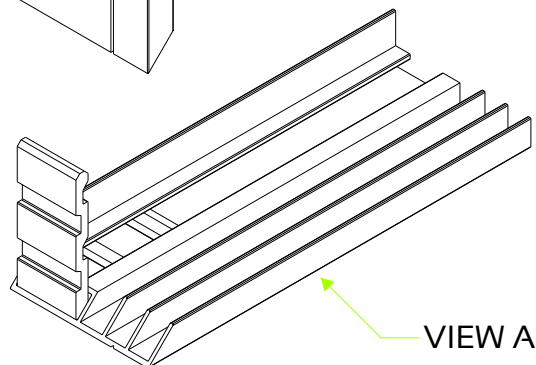
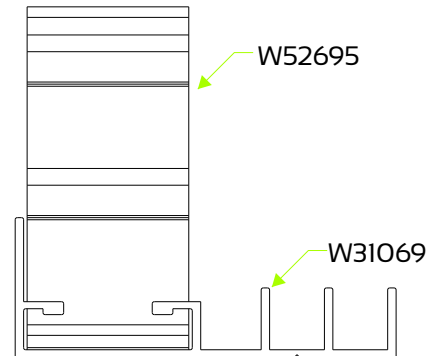

W52695

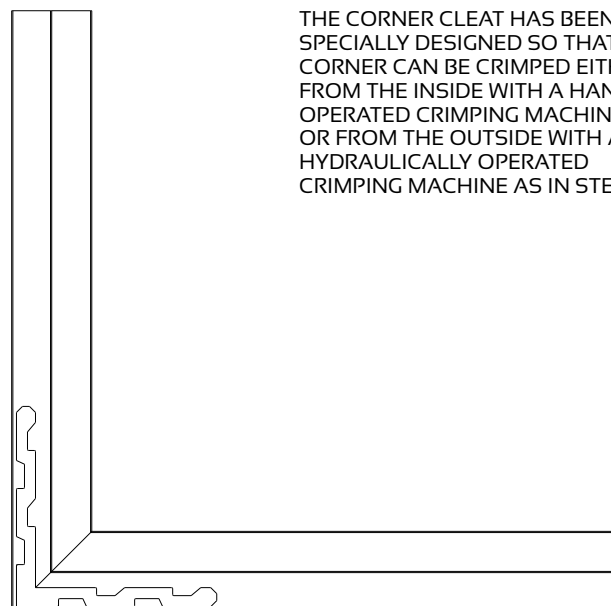

THE CORNER CLEAT HAS BEEN
SPECIALLY DESIGNED SO THAT THE
CORNER CAN BE CRIMPED EITHER
FROM THE INSIDE WITH A HAND
OPERATED CRIMPING MACHINE
OR FROM THE OUTSIDE WITH A
HYDRAULICALLY OPERATED
CRIMPING MACHINE AS IN STEP 1.

VIEW A

Sash Corner Cleat

Outer Frame Corner Cleat

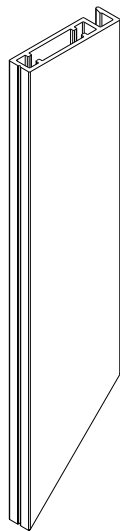

NOTE:
ALL JOINTS MUST BE SEALED WITH
SMALL JOINT SEALANT.

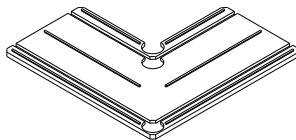
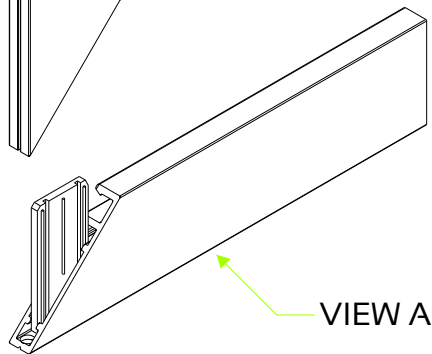
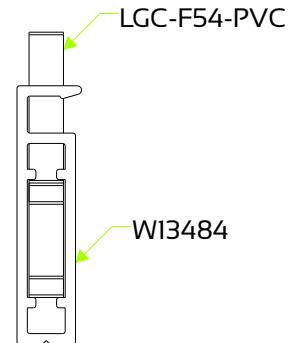

LGC-F54-PVC

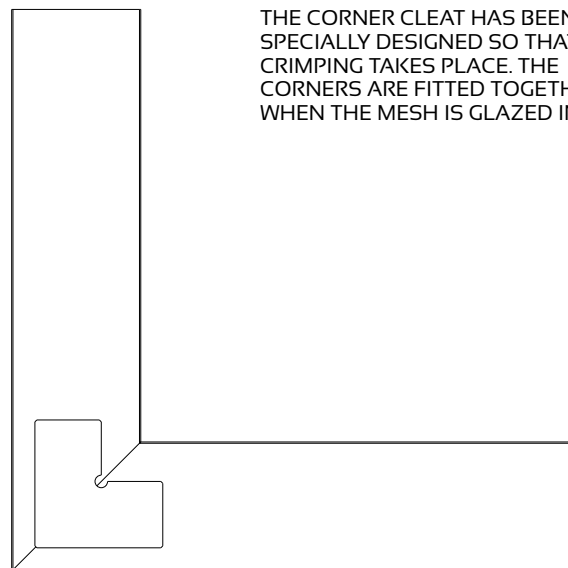

THE CORNER CLEAT HAS BEEN
SPECIALLY DESIGNED SO THAT NO
CRIMPING TAKES PLACE. THE
CORNERS ARE FITTED TOGETHER
WHEN THE MESH IS GLAZED IN

VIEW A

